

TIME FOR INSTALLATION

30 MINS. - 1 HOUR

RCI OFFROAD

EASY



BASIC SKILLS
REQUIRED

03-24 Toyota 4Runner Fj Cruiser Lexus Gx 470 Transfer Case Skid Plate Installation Guide

Contact RCI: SALES@RCIOFFROAD.COM
(970) 797-3089

Part Number	Description	Qty:
SM-00475	03-24 T4R Cross-member	1
SM-00199	03-24 T4R T-Case Skid	1
HK-00006	03-24 Toyota T-Case Skid HW Kit:	1
HW-00025	M8-1.25 x 30mm Hex Flange Bolt	2
HW-00037	5/16 USS Flat Washer Zinc	6
HW-00026	3/8 USS Flat Washer Thru Hard	3
HW-00068	7/16-14 x 1 Carriage Bolt GR-5	3
HW-00045	7/16 Split Lock Washer Zinc	3
HW-00047	7/16-14 FIN Hex Nut GR-5 Zinc	3
HW-00069	M8-1.25 x 50mm Hex Flange Bolt	4

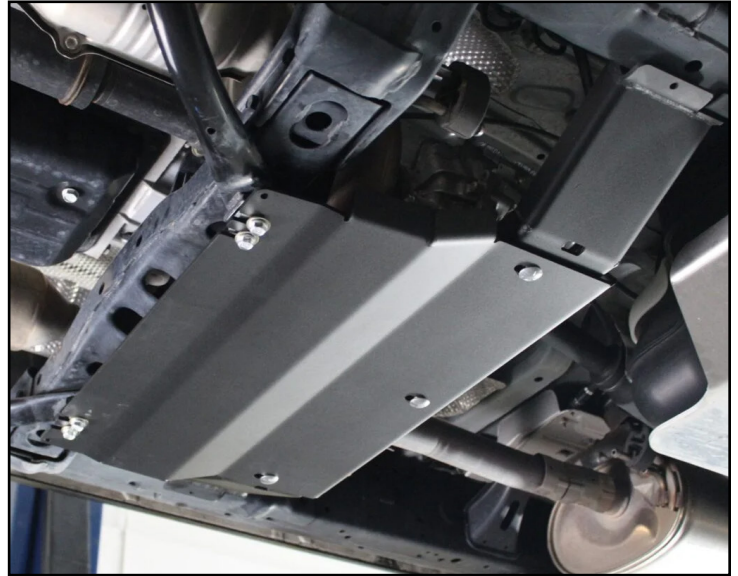
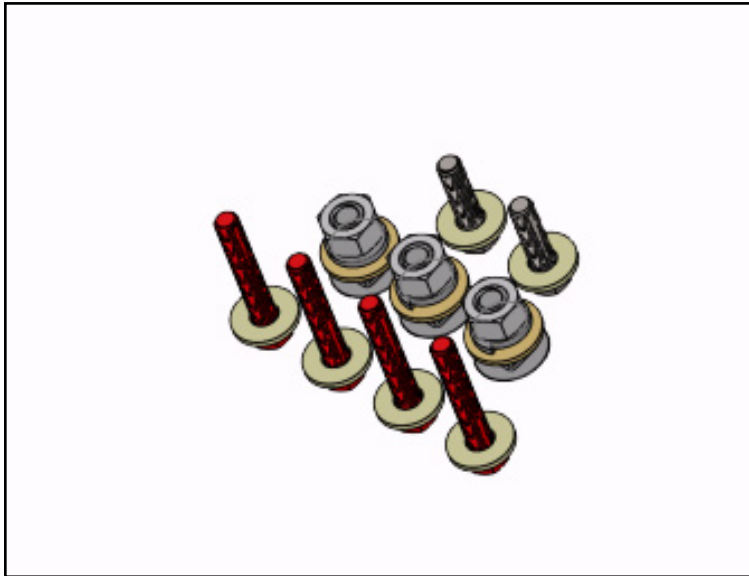

Caution: Use hand tools, impact wrenches may cause damage if over torqued.

Read the entire notes and instructions before installation.

Installation Notes

Installation Notes:

RH refers to the passenger side of the vehicle.

LH refers to the driver side of the vehicle.

Always use the proper torque specifications.

If applicable to this installation, torque specifications will be listed throughout the document.

Please read all of these instructions and familiarize yourself with the complete process **BEFORE** you begin.

General Safety:

Park your car in a safe, well lit, level area.

Shut the engine off and remove the key from the ignition switch.

Make sure any remote start devices are properly disabled.

ALWAYS wear safety glasses.

Make sure the parking brake is applied until the vehicle is safely lifted and supported.

Whether lifting a vehicle using an automotive lift or a hydraulic jack, utilize the factory specified lift points.

Lifting a vehicle in an incorrect location can cause damage to the suspension/running gear.

ALWAYS support the vehicle with properly rated jack stands.

ALWAYS read and follow all safety information and warnings for the equipment you are using.

Required Tools:

1/4", 3/8" & 1/2" Socket Sets & Ratchets

Floor Jack

Jack Stands

Combination Wrench Set

Plier Set

Torque Wrenches

Installation Overview:

Before installation, remove all components and hardware from their packaging and verify that all the components are present.

Section 1: Removing the Stock Components

Step #1 | 12mm Socket & Ratchet

Before installation, remove all components and hardware from their packaging and verify that all the components are present.

Remove the rearmost bolts (arrows) that secure the support tubes to the frame rails.

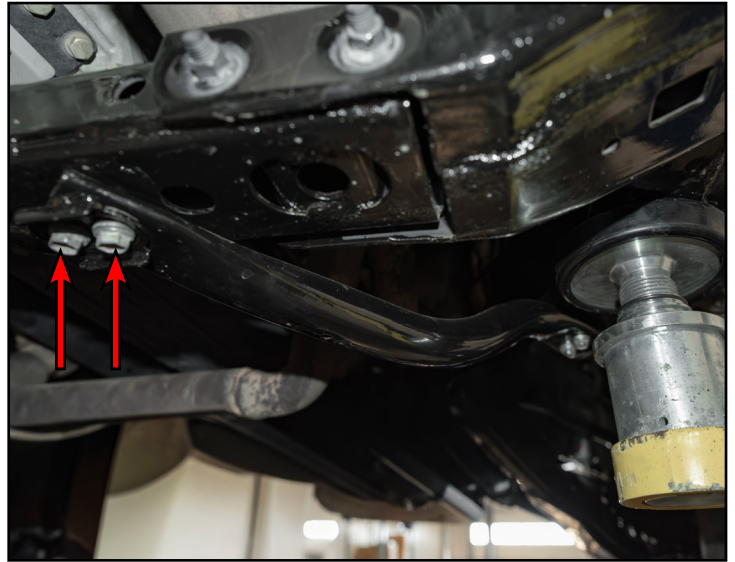

Step #2 | 12mm Socket & Ratchet

Ensure the threaded hole (arrow in **photo #1**) in the LH frame rail is clear of any debris, this will be utilized to secure the provided cross-member to the frame. Repeat for the threaded hole in the LH frame rail (not shown).

For 03-09 4Runners & Fj Cruisers only: remove the bolt (arrow in **photo #2**) that secures the exhaust hanger bracket to the RH frame rail. This mounting location will be utilized to secure the provided cross-member to the frame. Note, the exhaust hanger bracket will be reinstalled on top of the cross-member after it is installed.

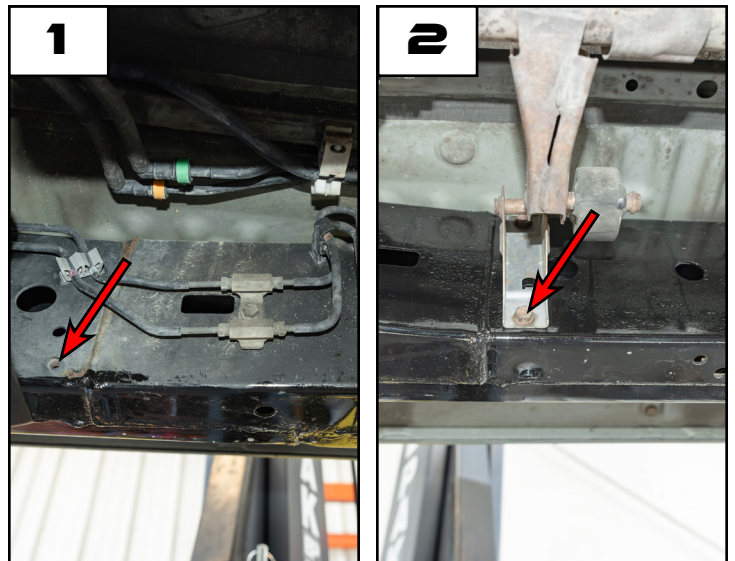

Section 2: Installing the New Skid Plate

Step #1	13mm Socket & Ratchet
----------------	----------------------------------

Lift the provided cross-member into place and secure it to the frame rails on either side of the vehicle with the provided M8-1.25 x 30mm hardware (arrows).

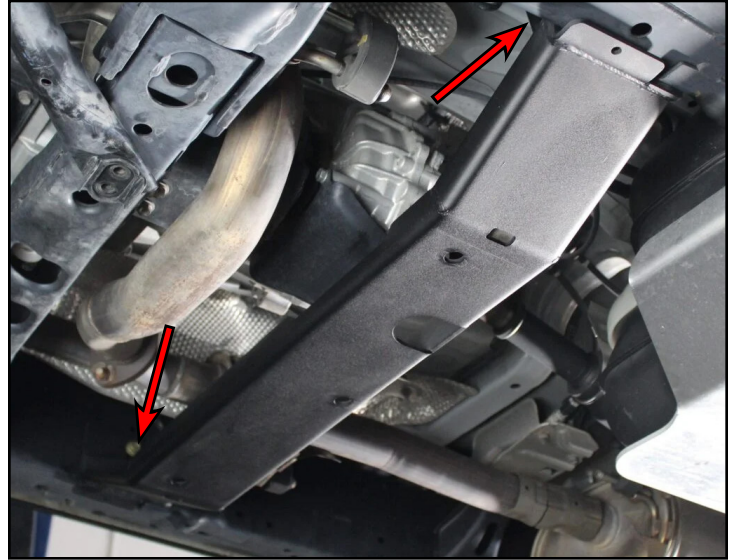

Step #2	13mm Socket & Ratchet
----------------	----------------------------------

Loosely install the provided M8-1.25 x 50mm bolts (arrows), then slide the new transfer case skid plate onto them and support the skid plate from underneath.

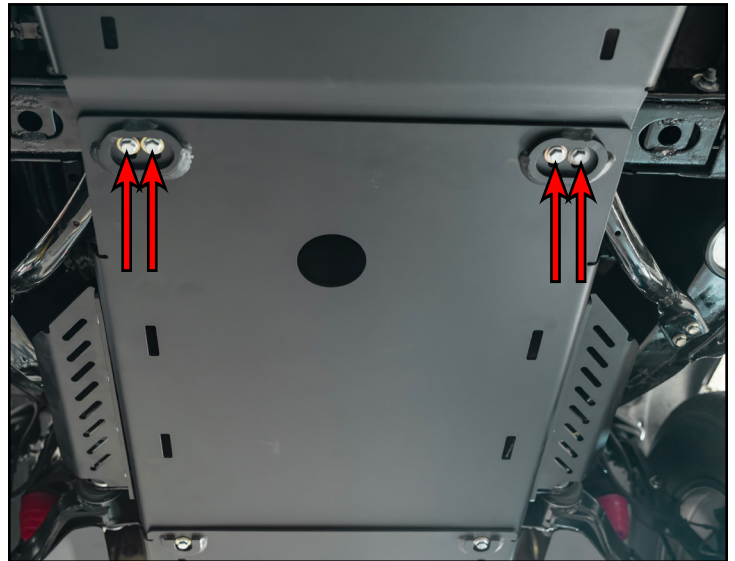

If purchased with a transmission skid plate:

Ensure that the transfer case skid plate sits below the transmission skid plate.

Section 2: Installing the New Skid Plate

Step #3 11/16" Socket & Ratchet

Secure the rearmost mounting locations by installing the provided 7/16" carriage bolts (circled in **YELLOW**) through the skid plate and the previously installed cross-member, then loosely install the flat washers, split-lock washers, and hex nuts onto them.

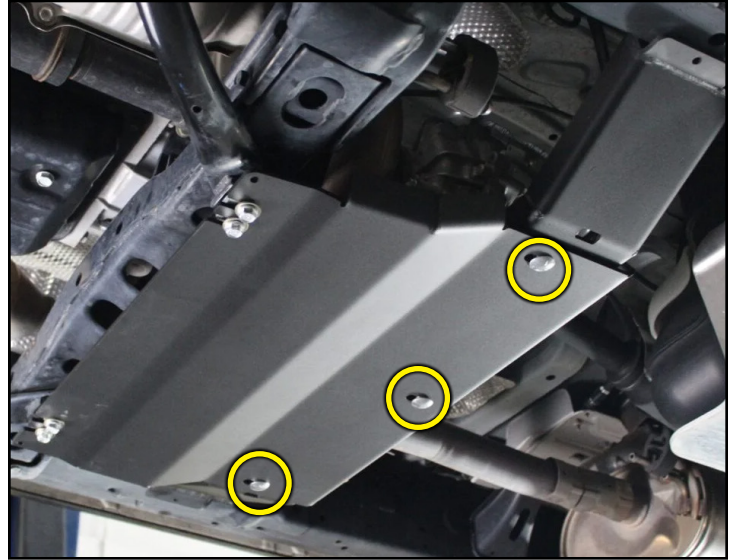

Step #4 11/16", 13mm Sockets & Ratchet

Install the provided spacers (arrow in inset photo) in between the transfer case skid plate and the frame support tube. Adjust the skid plate until desired fitment has been achieved, then fully tighten all of the previously installed hardware.

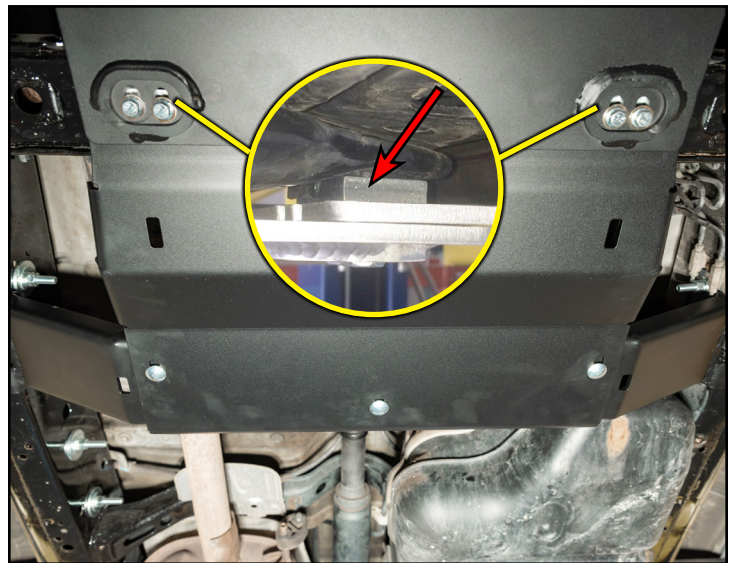

CONGRATULATIONS, YOUR INSTALLATION IS COMPLETE!

ENJOY YOUR NEW RCI PROTECTION!



**Share your new install with us on social media!
We love seeing our products in the wild!**

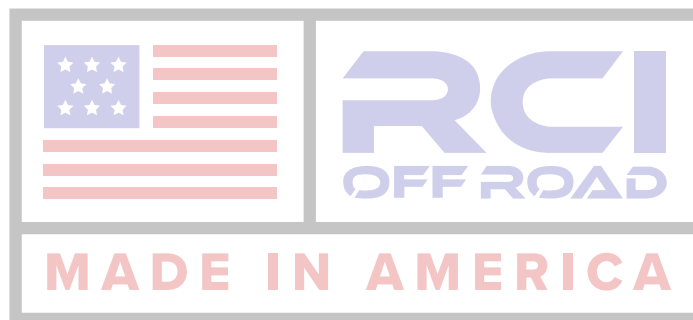

Follow us on social media:
[instagram.com/rcioffroad/#](https://www.instagram.com/rcioffroad/)
[facebook.com/RCIOffroad](https://www.facebook.com/RCIOffroad)
[youtube.com/@RCIOFFROAD](https://www.youtube.com/@RCIOFFROAD)

Contact:
1.970.797.3089
SALES@RCIOFFROAD.COM
6701 N. FRANKLIN AVE. LOVELAND, CO 80538

These instructions are provided as a courtesy by RCI Offroad

Disclaimer: The products sold by RCI Metalworks are intended for off-road use only, should not be modified, and are for use only on the vehicle(s) specifically stated. RCI Metalworks makes no warranties express or implied, including of fitness for a particular purpose or merchantability. RCI Metalworks will not be liable for any damages arising out of the use or misuse of its products. It is the customers' responsibility to ensure the products are safely and properly attached to the vehicle, and all products should be installed by trained professionals. We strive to maintain extremely high-quality standards; however, all RCI Metalworks products are individually handcrafted, may vary slightly, and may contain minor imperfections. Due to the nature of raw aluminum, the material may have minor scratches and other blemishes caused by the manufacturing process, especially on the back side of product. RCI Metalworks is constantly seeking to improve its products and reserves the right to make changes to any product.