

TIME FOR INSTALLATION

1-2 HOURS

RCI OFFROAD

MODERATE



SOME EXPERIENCE
RECOMMENDED

15-22 Chevrolet Colorado Slider Installation Guide

Contact RCI: SALES@RCIOFFROAD.COM
(970) 797-3089

Item No.	Part number	Description	Qty.
1		15-22 Colorado Slider LH (Driver)	1
2		15-22 Colorado Slider RH (Passenger)	1
19	SM-00980	Slider Tread Plate RH (Passenger)	1
20	SM-00979	Slider Tread Plate LH (Driver)	1
21	SM-01006	Mounting Plate #4.135MS	7
22	HW-00002	Mounting Plate #1.135MS	2
23	HW-00004	3/8 Carriage Bolt Plate	4
24	HK-00068	15-22 Colorado Slider Hardware Kit	1
24.1	HW-00017	1/4-20 x 7/8 Button SOC Cap Black	20
24.2	HW-00031	1/4-20 Keps Nut 18-8 S.S. Black Oxide	20
24.3	HW-00019	1/4 USS Flat Washer Black Zinc	40
24.4	HW-00023	Speed Clip 5558B1M: M10-1.5 U-Nut .90mm	8
24.5	HW-00030	3/8-16 FIN Hex Nut GR-5 Zinc	4
24.6	HW-00029	3/8 Split Lock Washer Zinc	4
24.7	HW-00026	3/8 USS Flat Washer Thru Hard	12
24.8	HW-00170	3/8-16 x 5-1/2" Carriage Bolt	4
24.9	HW-00028	Full Moon Spacer	4
24.10	HW-00021	M10-1.5 x 35mm Hex Flange Bolt	8
24.11	HW-00051	40" Length Wire	1

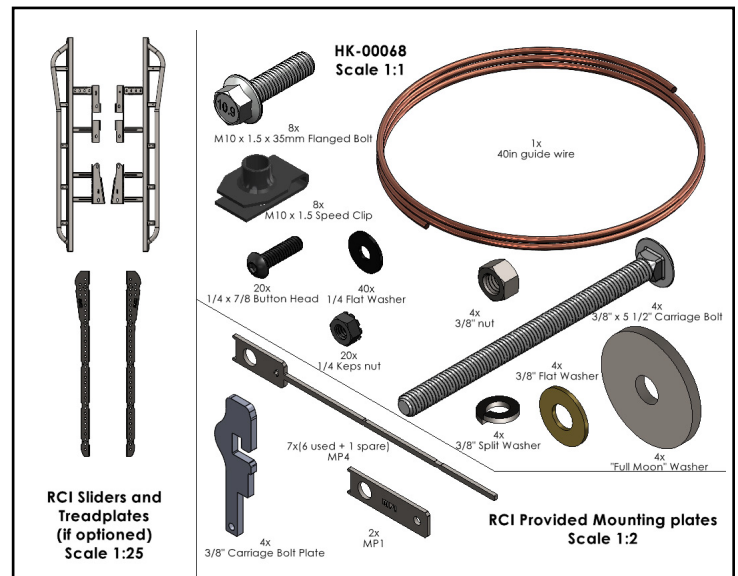
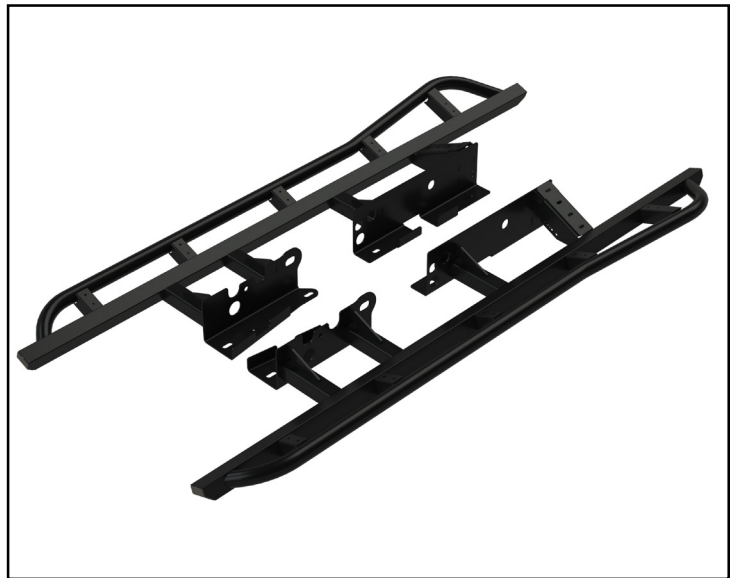

Caution: Use hand tools, impact wrenches may cause damage if over torqued.

Read the entire notes and instructions before installation.

Installation Notes

Installation Notes:

RH refers to the passenger side of the vehicle.

LH refers to the driver side of the vehicle.

Always use the proper torque specifications.

If applicable to this installation, torque specifications will be listed throughout the document.

Please read all of these instructions and familiarize yourself with the complete process **BEFORE** you begin.

General Safety:

Park your car in a safe, well lit, level area.

Shut the engine off and remove the key from the ignition switch.

Make sure any remote start devices are properly disabled.

ALWAYS wear safety glasses.

Make sure the parking brake is applied until the vehicle is safely lifted and supported.

Whether lifting a vehicle using an automotive lift or a hydraulic jack, utilize the factory specified lift points.

Lifting a vehicle in an incorrect location can cause damage to the suspension/running gear.

ALWAYS support the vehicle with properly rated jack stands.

ALWAYS read and follow all safety information and warnings for the equipment you are using.

Required Tools:

1/4", 3/8" & 1/2" Socket Sets & Ratchets

Floor Jack

Jack Stands

Combination Wrench Set

Plier Set

Torque Wrenches

Section 1: Installing the New Rock Sliders

Step #1 10mm Socket & Ratchet

Remove the nut (**arrow** in **Fig: 1.1**) that secures the front and rear parking brake cables, then disconnect the parking brake cables.

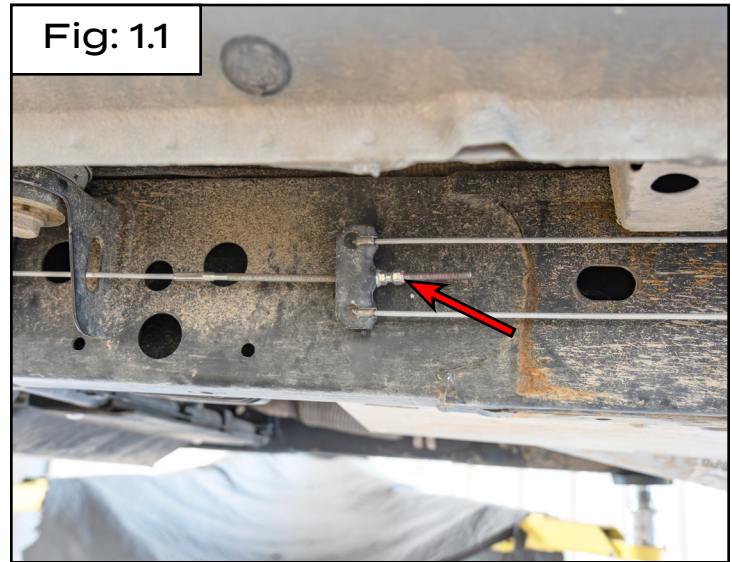

Step #2

Unpack and remove all of the components and hardware from its packaging, then verify all the components are present. **Fig: 1.2.**

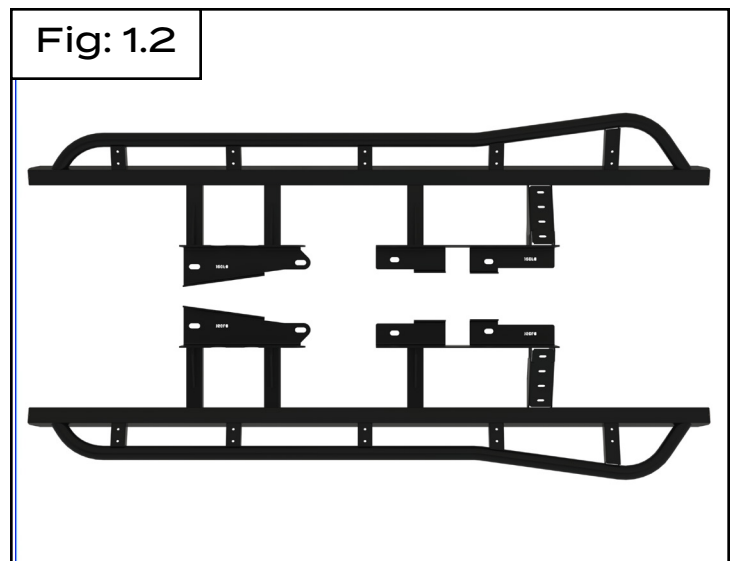

Section 1: Installing the New Rock Sliders

Step #3 Floor Jack & Jack Stands

Lift the **RH** slider from underneath up to the frame-rail on the **RH** side of the vehicle. **Fig: 1.3.**

Tech tip: Having a friend to assist, along with using a floor jack and jack stands will make this installation easier.

CAUTION: Be careful when installing the slider not to pinch or damage any frame mounted wiring, lines or hoses.



Step #4

Prepare the MP4 mounting brackets by install ing the provided M10 speed clips onto the MP4 mounting plates as shown in **Fig: 1.4.**

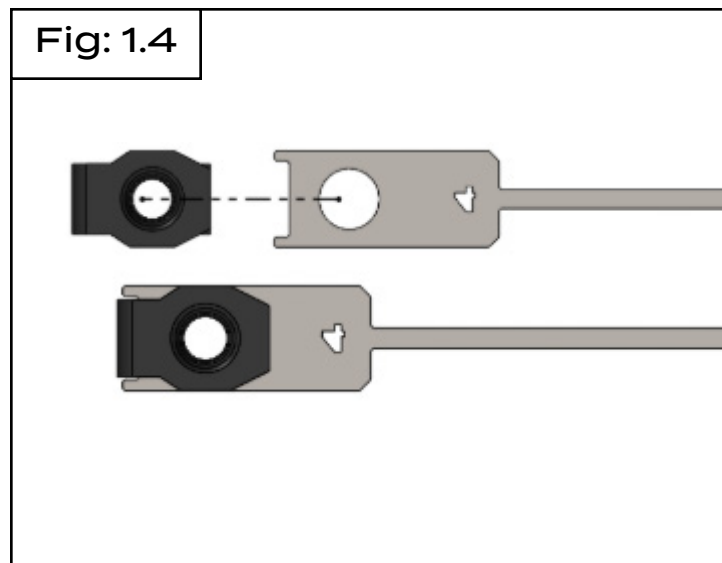

Section 1: Installing the New Rock Sliders

Step #5a Tape Measure & Marker

Prepare the **RH** rearmost MP4 bracket by measuring 6" from from the back edge of the mounting plate, then make a mark on the bracket (as shown in **Fig: 1.5**).

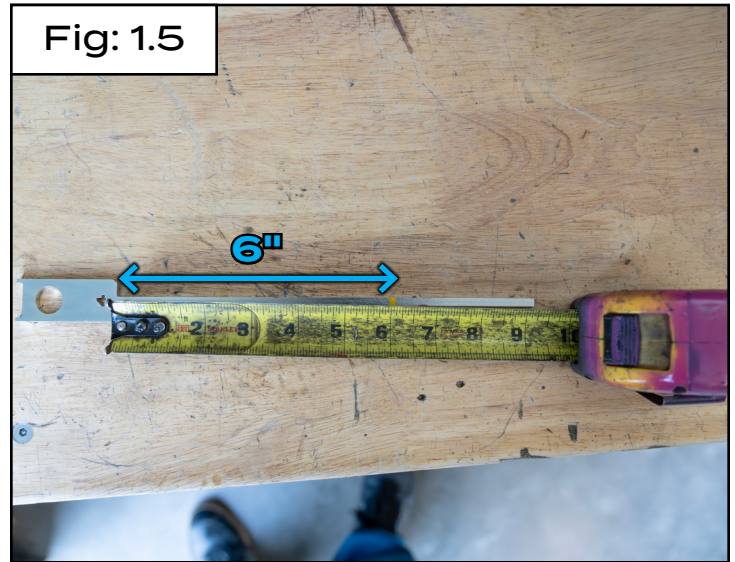

Step #5b Pliers -OR- Bench Mounted Vice

Bend the **RH** rearmost MP4 bracket 90° as close to the edge of the mounting plate as shown in **Fig: 1.6**.

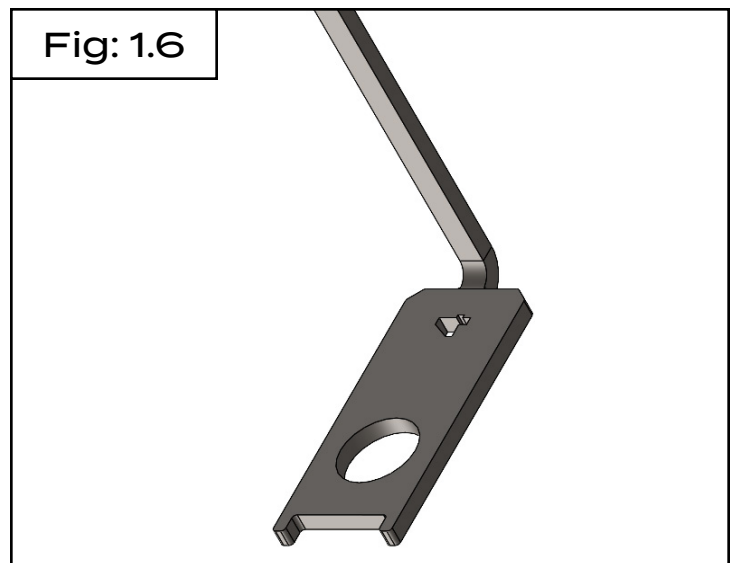

Section 1: Installing the New Rock Sliders

Step #5c Pliers –OR– Bench Mounted Vice

Bend the **RH** rearmost MP4 bracket at the first notch (**arrow** in **Fig: 1.7**) over the MP4 mounting plate as shown.

Fig: 1.7

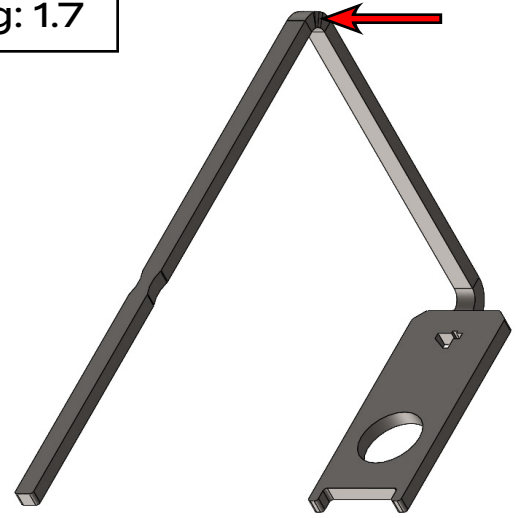

Step #5d Pliers –OR– Bench Mounted Vice

Bend the **RH** rearmost MP4 bracket at the mark (**arrow** in **Fig: 1.8**) to the side of the MP4 mounting plate as shown.

Fig: 1.8

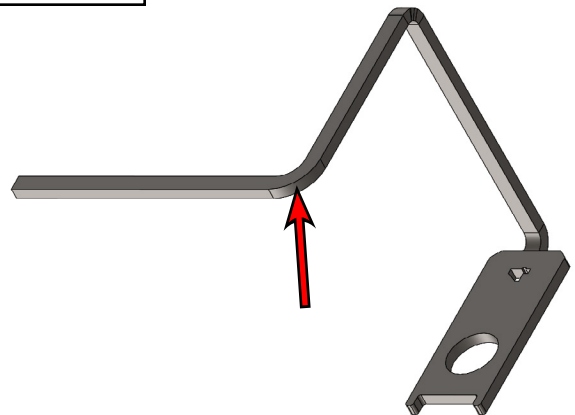

Section 1: Installing the New Rock Sliders

Step #6 15mm Socket & Ratchet

Install the **RH** rearmost MP4 bracket into the frame location (**arrow** in **Fig: 1.9**) and loosely install the provided M10 – 1.5 x 35mm bolt and 3/8" washer (circled in **YELLOW** in **Fig: 1.9**).

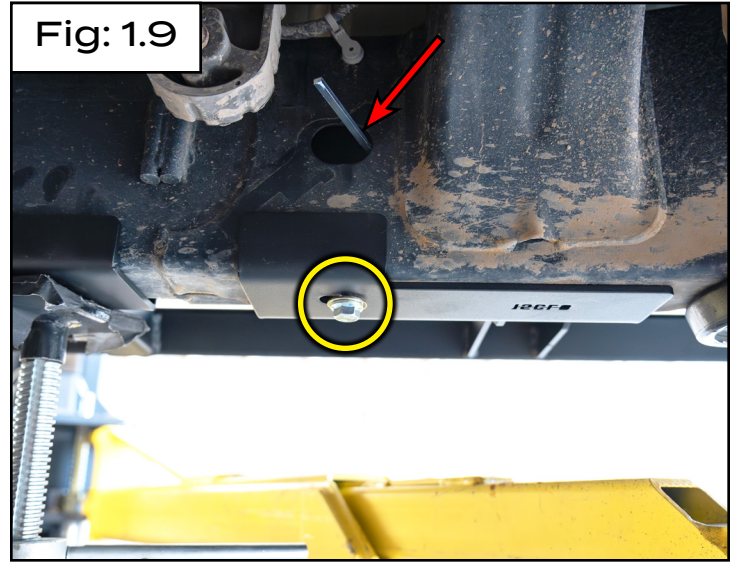

Step #7 Pliers –OR– Bench Mounted Vise

Prepare the **RH** front frame plate rear position MP4 bracket by bending the bracket at the notch (**arrow** in **Fig: 1.10**).

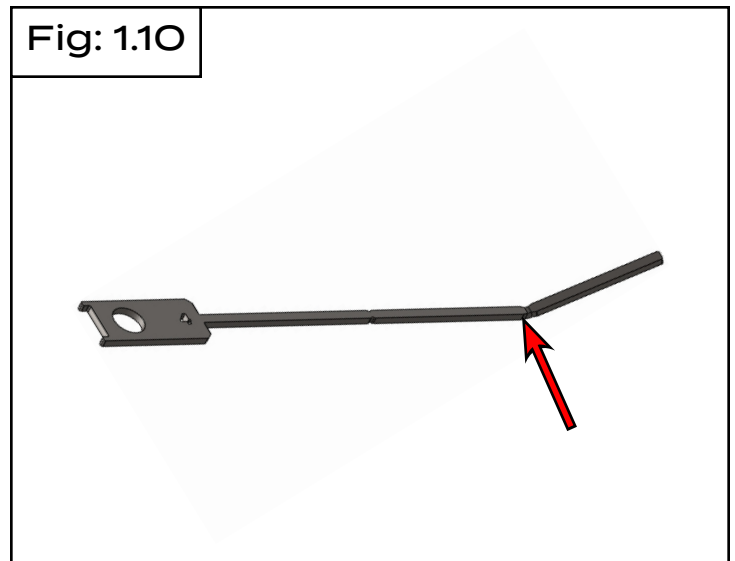

Section 1: Installing the New Rock Sliders

Step #8 15mm Socket & Ratchet

Install the **RH** front frame plate rear position MP4 bracket through the frame location (**arrow** in **Fig: 1.11**) and loosely install the provided M10 – 1.5 x 35mm bolt and 3/8" washer (circled in **YELLOW** in **Fig: 1.11**).

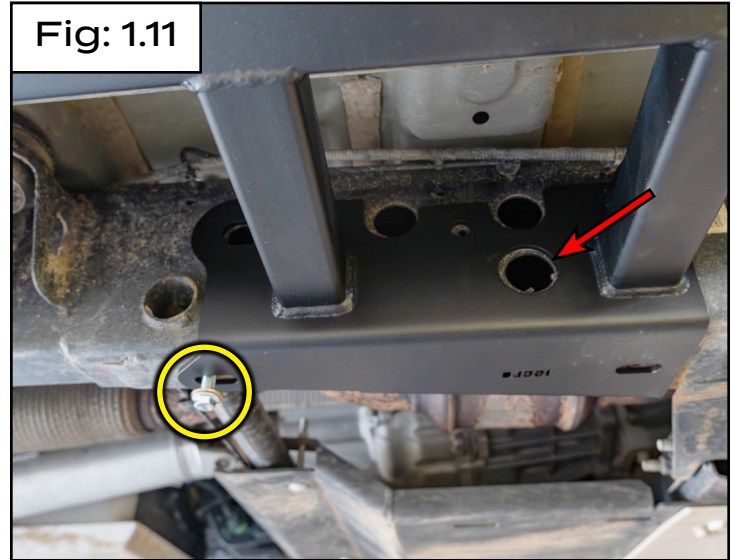

Step #9a Tape measure & Marker

Prepare the **RH** frontmost MP4 bracket by measuring 2.25" and 5.75" from the mounting plate and making marks at those locations (**arrows** in **Fig: 1.12**).

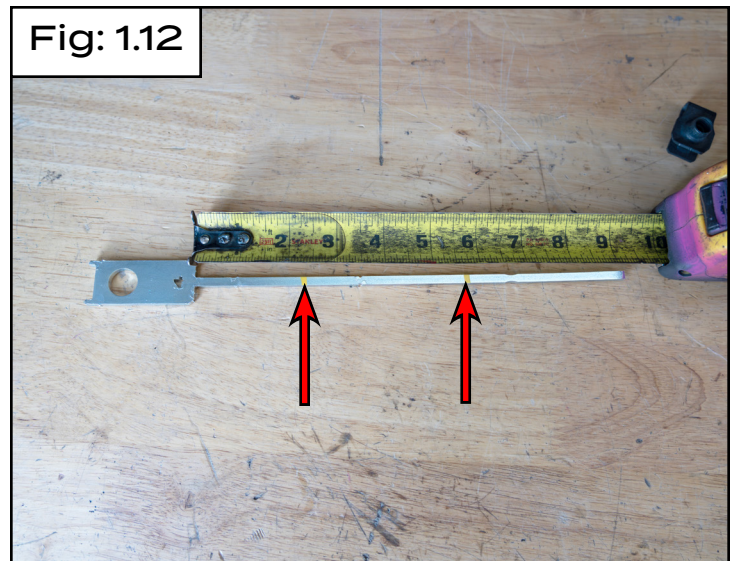

Section 1: Installing the New Rock Sliders

Step #9b Required tools

Bend the **RH** frontmost MP4 bracket 90° upward at the mark location 2.25" from the mounting plate (**arrow** in **Fig: 1.13**).

Fig: 1.13

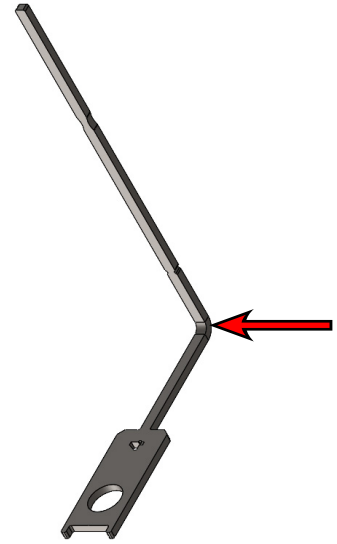

Step #9c Required tools

Make the second bend for the **RH** frontmost MP4 bracket at the 5.75" mark (**arrow** in **Fig: 1.14**).

Fig: 1.14

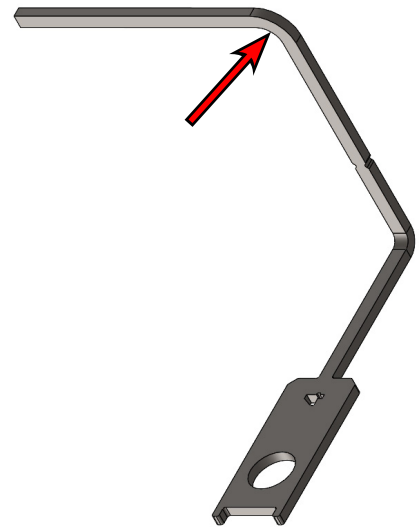

Section 1: Installing the New Rock Sliders

Step #10 15mm Socket & Ratchet

Install the prepared MP4 bracket through the frame (**arrow in Fig: 1.15**) and loosely install the provided M10 – 1.5 x 35mm bolt and 3/8" washer (circled in **YELLOW** in **Fig: 1.15**).

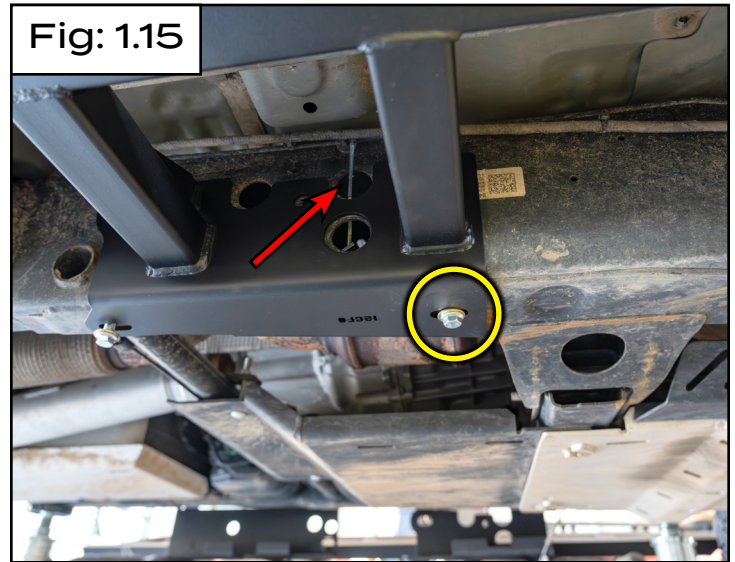

Step #11a Tape Measure & Marker

Prepare the **RH** center section MP4 bracket by measuring 4" from the mounting plate edge and marking a line on the bracket as shown in **Fig: 1.16**.

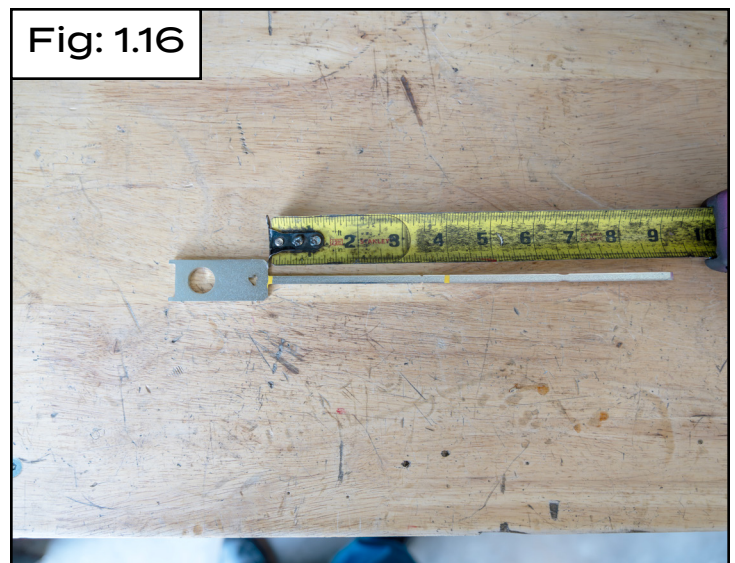

Section 1: Installing the New Rock Sliders

Step #11b Pliers –OR– Bench Mounted Vise

Bend the **RH** center section MP4 bracket 90° upward as close to the edge of the mounting plate as shown in **Fig: 1.17**.

Fig: 1.17

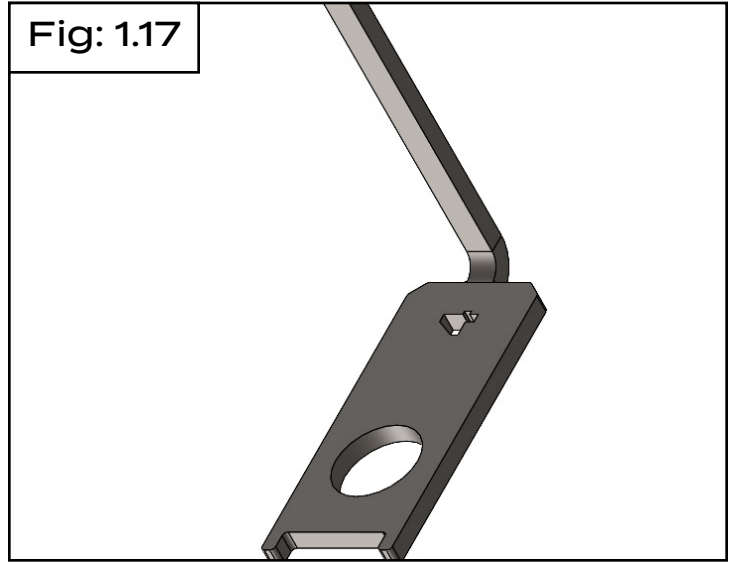

Step #11c Pliers –OR– Bench Mounted Vise

Bend the **RH** center MP4 bracket 90° at the 4" mark (arrow in **Fig: 1.18**) to the side of the MP4 mounting plate as shown in **Fig: 1.18**.

Fig: 1.18

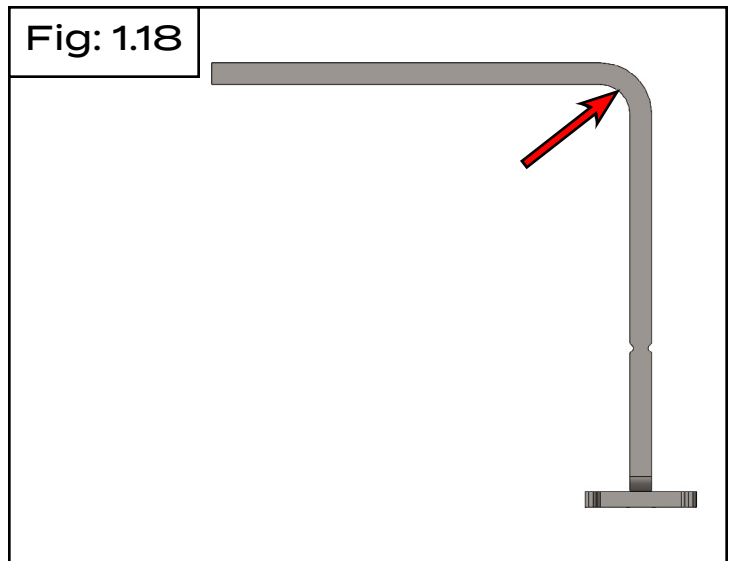

Section 1: Installing the New Rock Sliders

Step #12 Required tools

Install the prepared MP4 bracket through the frame (**arrow** in **Fig: 1.19**) and loosely install the provided M10 – 1.5 x 35mm bolt and 3/8" washer (circled in **YELLOW** in **Fig: 1.19**).

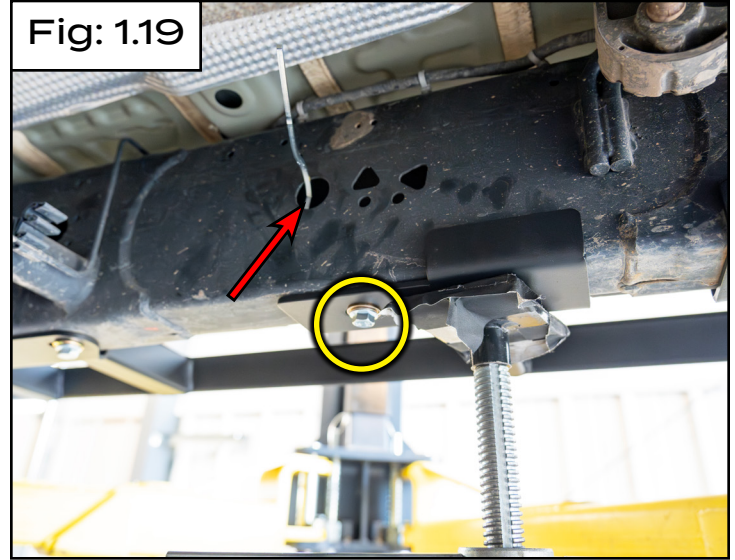

Step #13 9/16 Sockets & Ratchet

Install the provided 3/8" carriage bolt (highlighted **GREEN** in **Fig: 1.20**) through the **RH** frame-rail and through the rear frame plate, then loosely secure the carriage bolts with the supplied 3/8" carriage bolt plate (**arrow** in **Fig: 1.20**), washers, lock washers, and nuts.

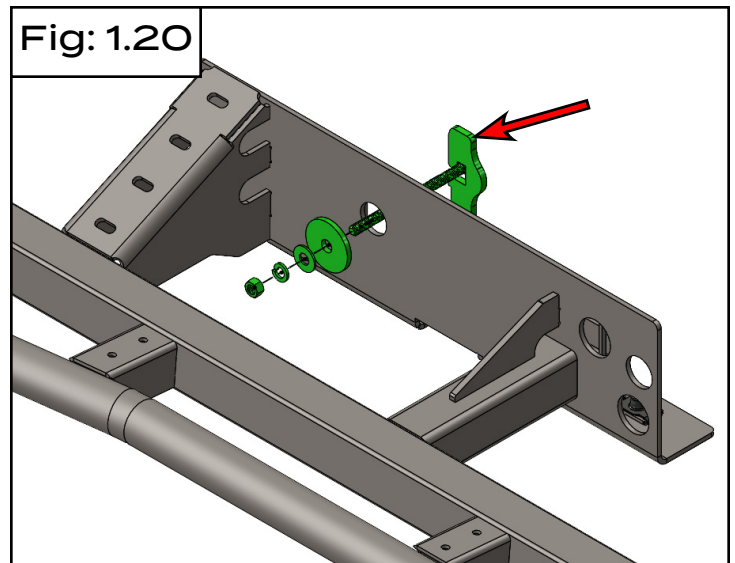

Section 1: Installing the New Rock Sliders

Step #14 9/16 Socket & Ratchet

Install the provided 3/8" carriage bolt (highlighted **GREEN** in **Fig: 1.20**) through the **RH** frame-rail and through the front frame plate, then loosely secure the carriage bolts with the supplied 3/8" carriage bolt plate (**arrow** in **Fig: 1.20**), washers, lock washers, and nuts.

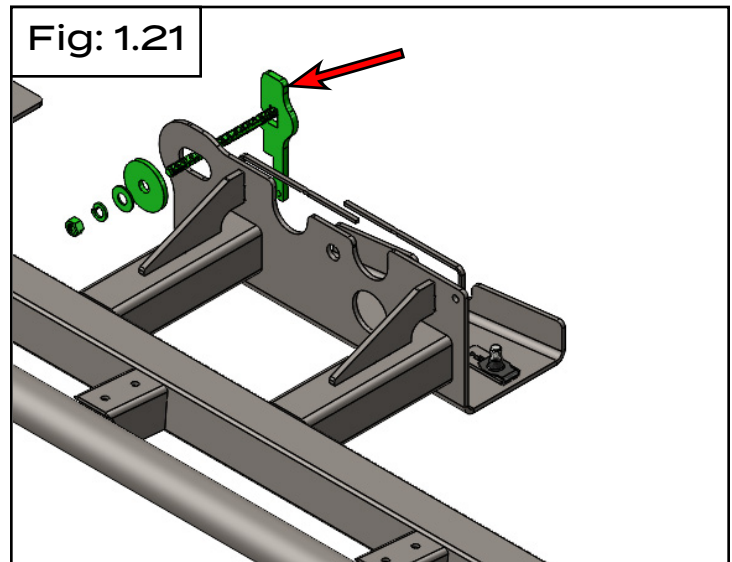

Step #15 9/16, 15mm Sockets & Torque Wrench

Inspect all hardware and ensure they are tightened to the following torque specs:

- Torque the 3/8 carriage bolts (highlighted **GREEN** in **Fig: 1.22**) to 15 lb-ft.
- Torque the M10 hardware (**arrows** in **Fig: 1.22**) to 60 lb-ft.

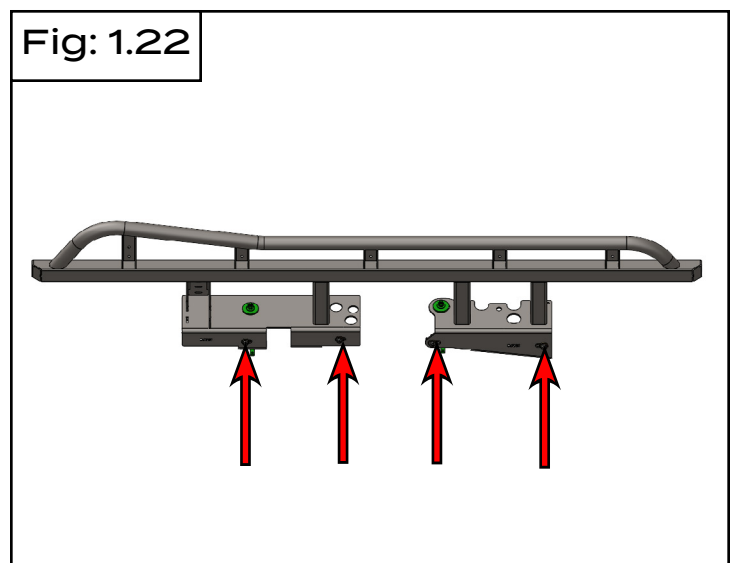

Section 1: Installing the New Rock Sliders

Step #16 Floor Jack & Jack Stands

Lift the **RH** slider from underneath up to the frame-rail on the **RH** side of the vehicle. **Fig: 1.21.**

Tech tip: Having a friend to assist, along with using a floor jack and jack stands will make this installation easier.

CAUTION: Be careful when installing the slider not to pinch or damage any frame mounted wiring, lines or hoses.



Step #17

Route the front section of the OEM parking brake cable through the **LH** slider and stock locations as shown in **Fig: 1.22.**



Section 1: Installing the New Rock Sliders

Step #18

Route the rear sections of the OEM parking brake cables through the **LH** slider as shown in **Fig: 1.23**.

Fig: 1.23

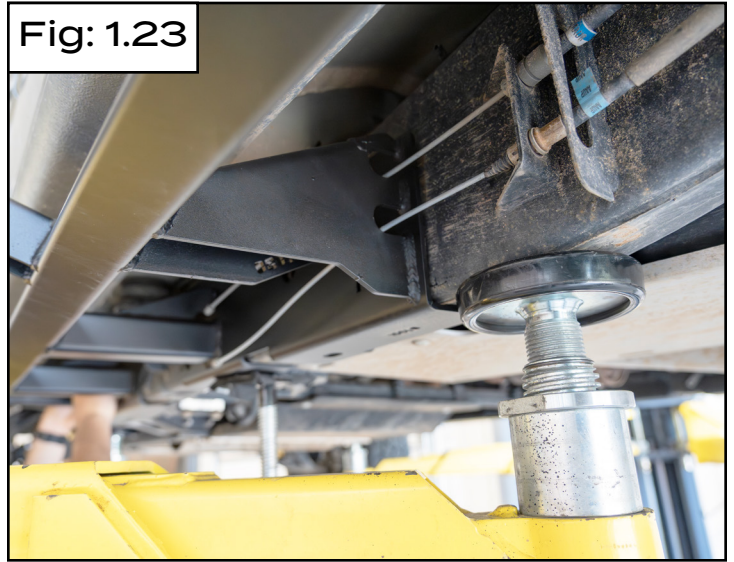

Step #19 10mm Socket & Ratchet

Reinstall the nut (arrow in **Fig: 1.24**) to secure the front & rear parking brake sections and tighten it until the cables are snug.

Fig: 1.24



Section 1: Installing the New Rock Sliders

Step #20

Prepare the MP1 brackets by installing the provided M10 speed clips onto them as shown in **Fig: 1.25**.

Fig: 1.25



Step #21

Prepare the **LH** front frame plate rear position MP1 bracket by routing the provided wire through the hole on one of the provided MP1 brackets, then twist the wire to secure it to the bracket as shown in **Fig: 1.26**.

Fig: 1.26



Section 1: Installing the New Rock Sliders

Step #22 15mm Socket & Ratchet

Slide the prepared LH front frame plate, rear position MP1 bracket through the frame (**arrow** in **Fig: 1.27**) and align the speed clip on the MP1 bracket with the mounting location (circled in **YELLOW** in **Fig: 1.27**).

Fig: 1.27

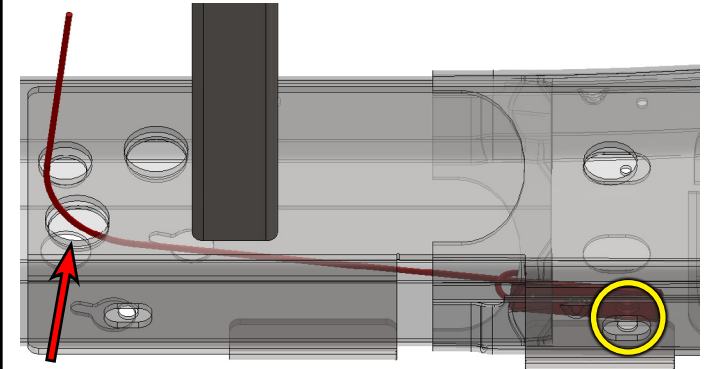

Step #23 15mm Socket & Ratchet

Slide the prepared LH front frame plate rear position MP1 bracket through the frame (**arrow** in **Fig: 1.28**) and align the speed clip on the MP1 bracket with the mounting location (circled in **YELLOW** in **Fig: 1.28**).

Fig: 1.28

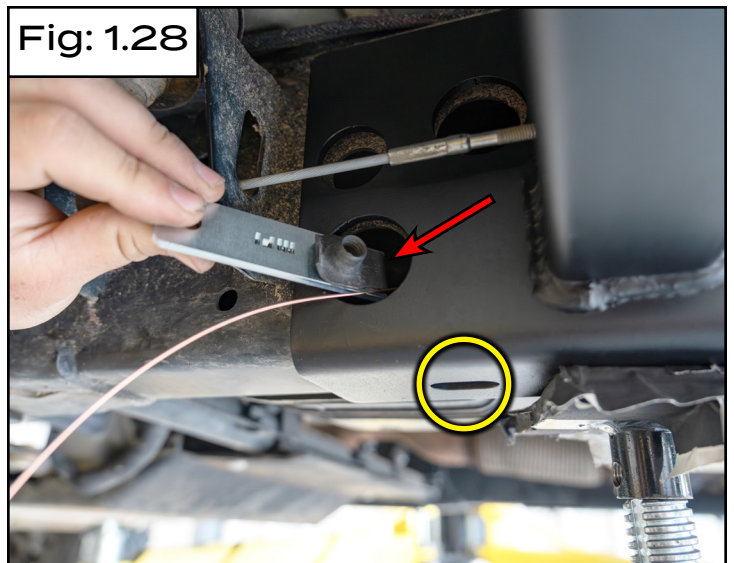

Section 1: Installing the New Rock Sliders

Step #24 15mm Socket & Ratchet

Loosely install the provided M10 – 1.5 x 35mm bolts and 3/8" washers (circled in **YELLOW** in **Fig: 1.29**) into the locations where the assembled MP1 brackets were placed.

Fig: 1.29



Step #25 Pliers –OR– Bench Mounted Vise

Bend the **LH** rearmost MP4 bracket at the first notch on the bracket (**arrow** in **Fig: 1.30**).

Fig: 1.30

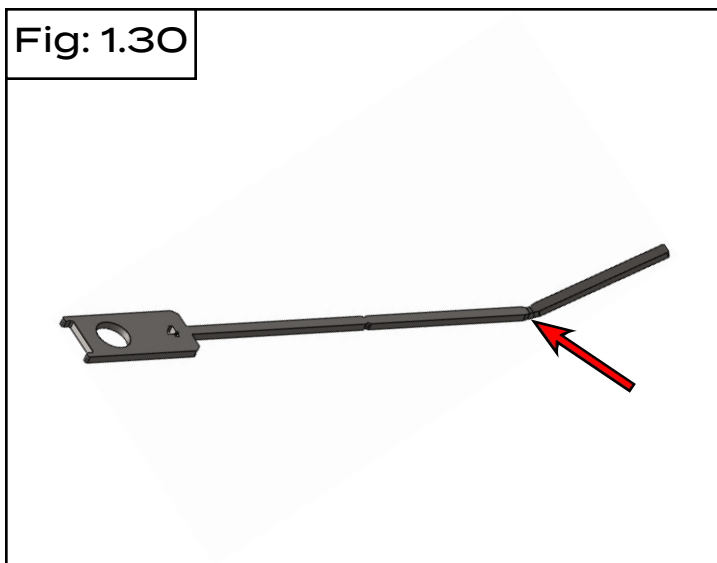

Section 1: Installing the New Rock Sliders

Step #26 Required tools

Install the prepared LH rearmost MP4 bracket into the frame (**arrow** in **Fig: 1.31**) and loosely install the provided M10 – 1.5 x 35mm bolt and 3/8" washer (circled in **YELLOW** in **Fig: 1.31**).

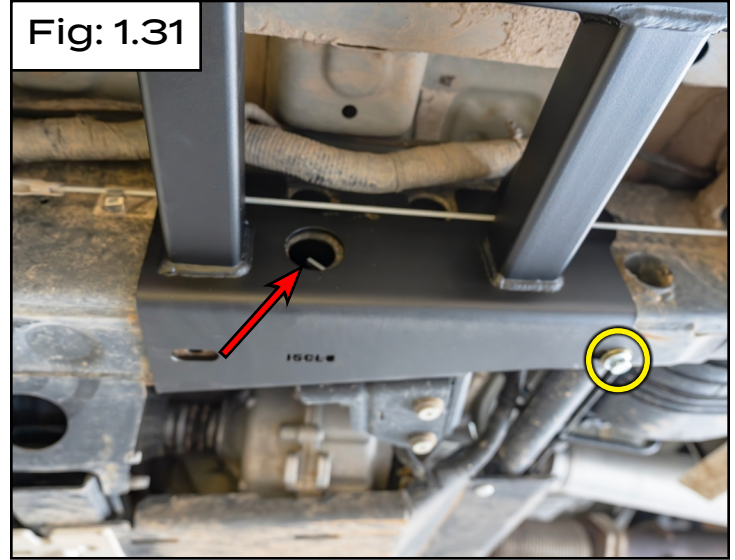

Step #27 Required tools

Prepare the **LH** rear frame plate front position MP4 bracket by measuring 2.25" and 5.75" from the mounting plate and making marks at those locations (**arrows** in **Fig: 1.32**).

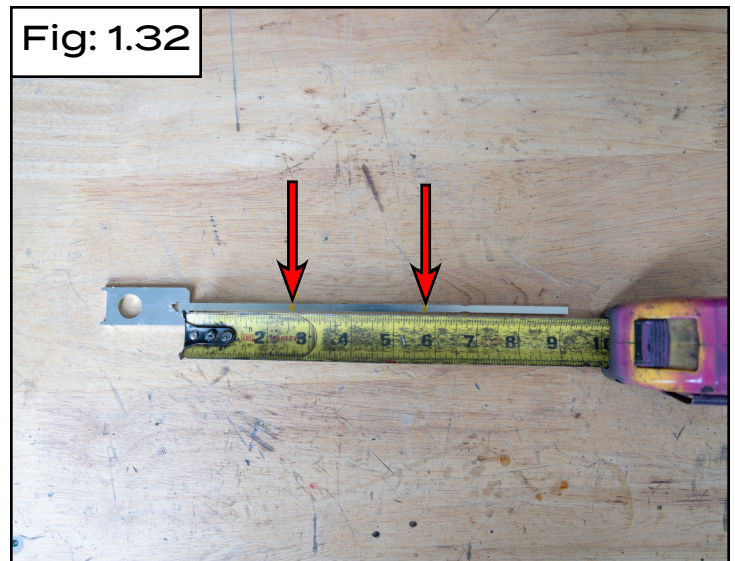

Section 1: Installing the New Rock Sliders

Step #28 Pliers -OR- Bench Mounted Vise

Bend the **LH** front-most MP4 bracket 90° upward at the mark location 2.25" from the mounting plate (**arrow** in **Fig: 1.33**).

Fig: 1.33

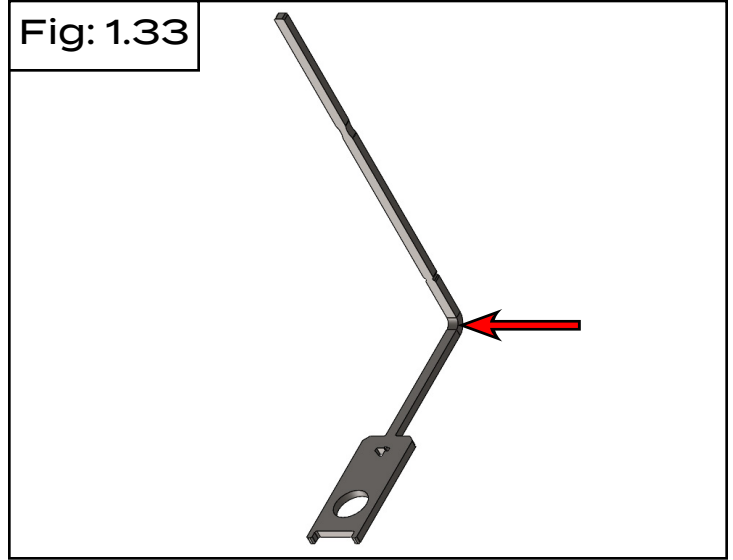

Step #29 Pliers -OR- Bench Mounted Vise

Make the second bend for the **LH** front-most MP4 bracket at the 5.75" mark (**arrow** in **Fig: 1.34**).

Fig: 1.34

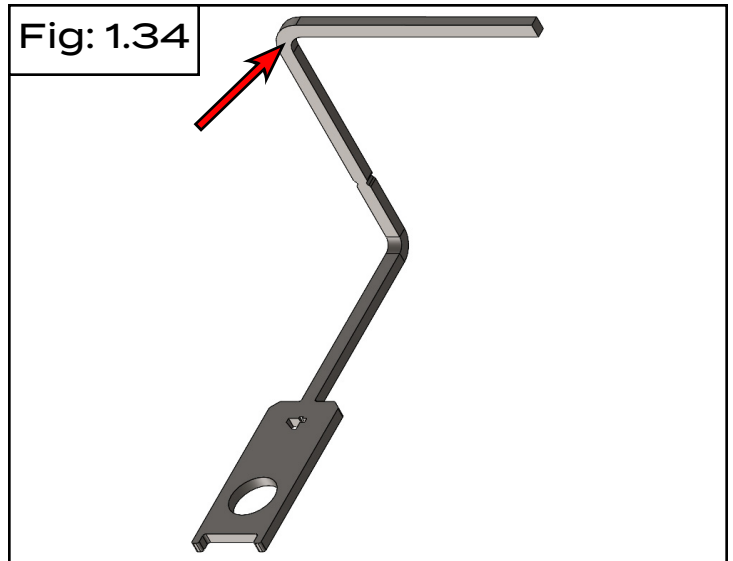

Section 1: Installing the New Rock Sliders

Step #30 15mm Socket & Ratchet

Install the prepared MP4 bracket through the frame (**arrow in Fig: 1.35**) and loosely install the provided M10 – 1.5 x 35mm bolt and 3/8" washer (circled in **YELLOW** in **Fig: 1.35**).

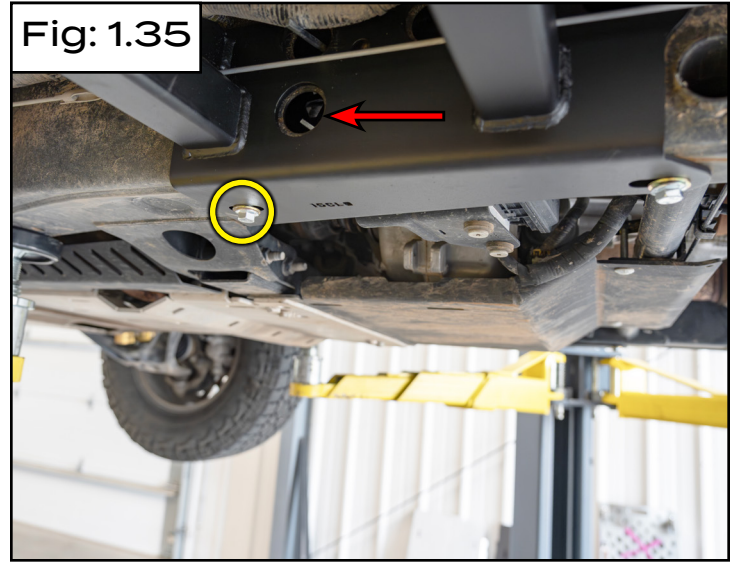

Step #31 9/16 Socket & Ratchet

Install the provided 3/8" carriage bolt (highlighted **GREEN** in **Fig: 1.36**) through the **LH** frame-rail and through the front frame plate, then loosely secure the carriage bolts with the supplied 3/8" carriage bolt plate (**arrow in Fig: 1.36**), washers, lock washers, and nuts.

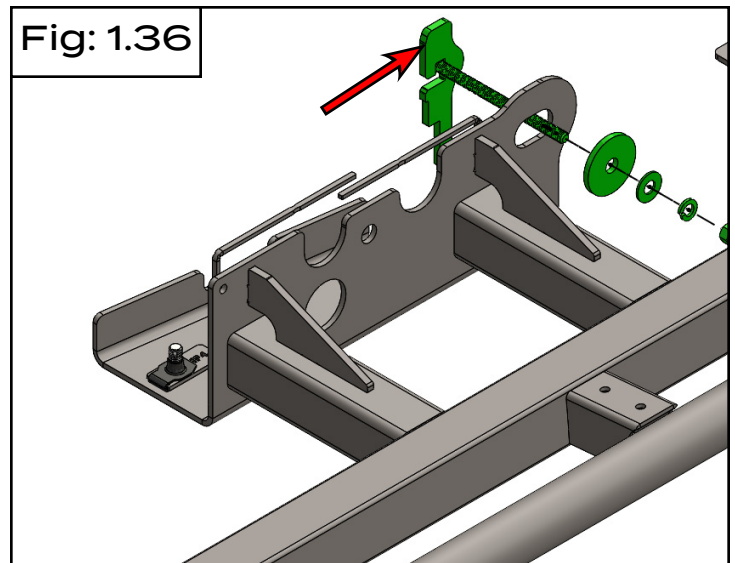

Section 3: Reinstall the

Step #32 9/16 Socket & Ratchet

Install the provided 3/8" carriage bolt (highlighted **GREEN** in **Fig: 1.37**) through the **LH** frame-rail and through the rear frame plate, then loosely secure the carriage bolts with the supplied 3/8" carriage bolt plate (arrow in **Fig: 1.37**), washers, lock washers, and nuts.

Fig: 1.37

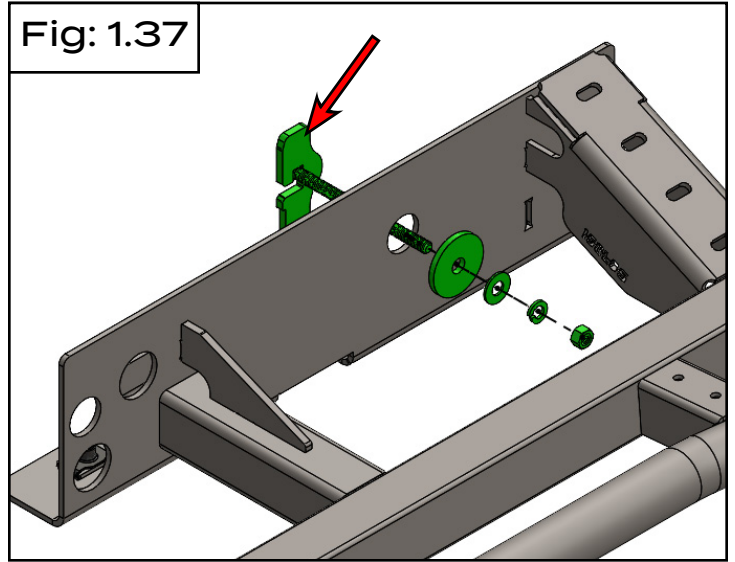

Step #33 9/16, 15mm Sockets & Torque Wrench

Inspect all hardware and ensure they are tightened to the following torque specs:

- Torque the 3/8 carriage bolts (highlighted **GREEN** in **Fig: 1.38**) to 15 lb-ft.
- Torque the M10 hardware (arrows in **Fig: 1.38**) to 60 lb-ft.

If you purchased tread plates: secure the tread plates to the sliders using the provided 1/4 hardware.

Fig: 1.38

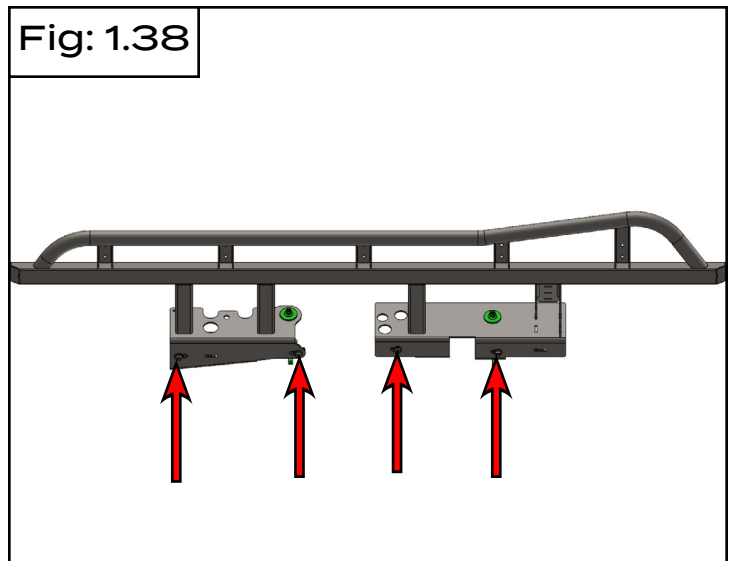

CONGRATULATIONS, YOUR INSTALLATION IS COMPLETE!

ENJOY YOUR NEW RCI PROTECTION!



**Share your new install with us on social media!
We love seeing our products in the wild!**

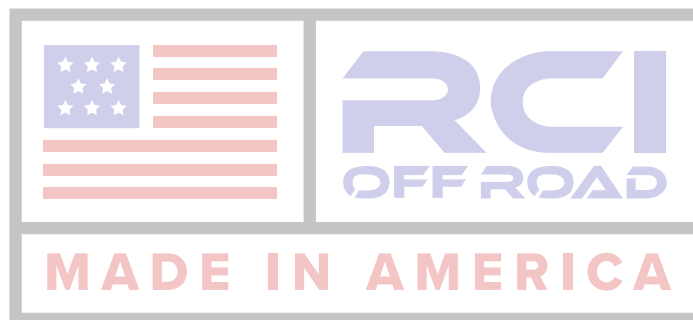

Follow us on social media:
[Instagram.com/rcioffroad](https://www.instagram.com/rcioffroad)
[Facebook.com/RCIOffroad](https://www.facebook.com/RCIOffroad)
[Youtube/@RCIOFFROAD](https://www.youtube.com/@RCIOFFROAD)

Contact:
1.970.797.3089
SALES@RCIOFFROAD.COM
6701 N. FRANKLIN AVE. LOVELAND, CO 80538

These instructions are provided as a courtesy by RCI Offroad

Disclaimer: The products sold by RCI Metalworks are intended for off-road use only, should not be modified, and are for use only on the vehicle(s) specifically stated. RCI Metalworks makes no warranties express or implied, including of fitness for a particular purpose or merchantability. RCI Metalworks will not be liable for any damages arising out of the use or misuse of its products. It is the customers' responsibility to ensure the products are safely and properly attached to the vehicle, and all products should be installed by trained professionals. We strive to maintain extremely high-quality standards; however, all RCI Metalworks products are individually handcrafted, may vary slightly, and may contain minor imperfections. Due to the nature of raw aluminum, the material may have minor scratches and other blemishes caused by the manufacturing process, especially on the back side of product. RCI Metalworks is constantly seeking to improve its products and reserves the right to make changes to any product.