

TIME FOR INSTALLATION
1 Hour



EASY

BASIC SKILLS
REQUIRED

24+ Ford Ranger A-Arm Skid Plate Installation Guide

Contact RCI: SALES@RCIOFFROAD.COM
(970) 797-3089

Item No.	Part number	Description	Qty:
1	SM-01057	Ranger A-arm Mounting Plate	2
3	SM-01055	'24 Ranger A-arm – Passenger – RH	1
4	SM-01054	'24 Ranger A-arm – Driver – LH	1
5	HK-00079	A-Arm Hardware Kit	1
5.1	HW-00035	3/8" –16 x 1-1/2" Carriage Bolt	4
5.2	HW-00026	3/8" USS Flat Washer	4
5.3	HW-00029	3/8" Split Lock Washer	4
5.4	HW-00030	3/8" –16 FIN Hex Nut	4
5.5	HW-00044	7/16 USS Flat Washer Zinc	4
5.6	HW-00084	M12-1.75 Hex Nylon Insert	4

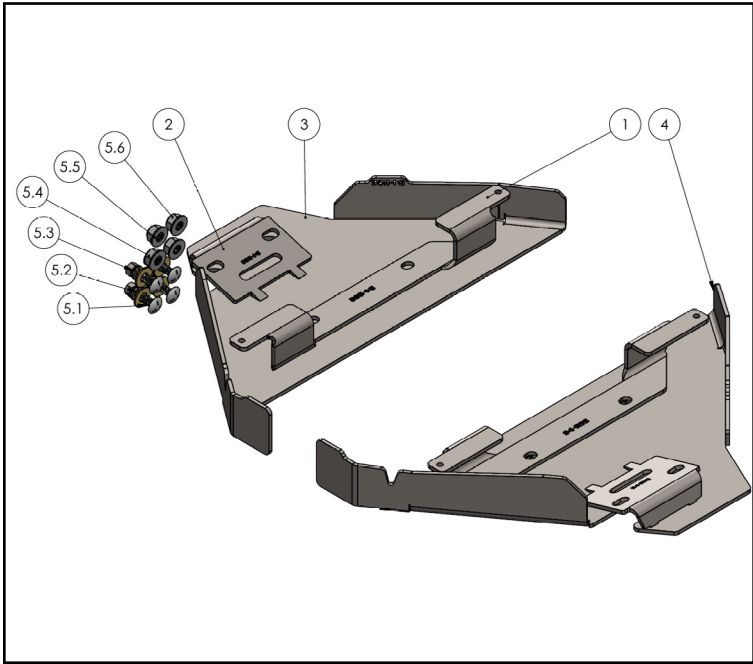
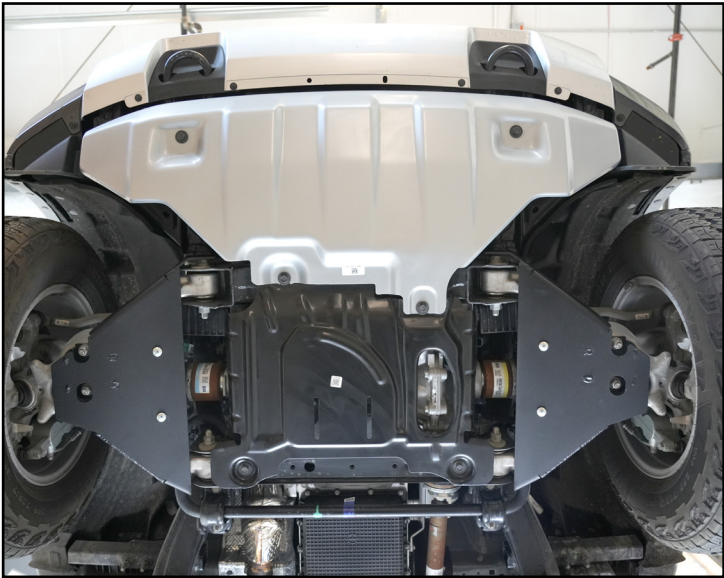

Caution: Use hand tools, impact wrenches may cause damage if over torqued.

Read the entire notes and instructions before installation.

Installation Notes

Installation Notes:

RH refers to the passenger side of the vehicle.

LH refers to the driver side of the vehicle.

Always use the proper torque specifications.

If applicable to this installation, torque specifications will be listed throughout the document.

Please read all of these instructions and familiarize yourself with the complete process **BEFORE** you begin.

General Safety:

Park your car in a safe, well lit, level area.

Shut the engine off and remove the key from the ignition switch.

Make sure any remote start devices are properly disabled.

ALWAYS wear safety glasses.

Make sure the parking brake is applied until the vehicle is safely lifted and supported.

Whether lifting a vehicle using an automotive lift or a hydraulic jack, utilize the factory specified lift points.

Lifting a vehicle in an incorrect location can cause damage to the suspension/running gear.

ALWAYS support the vehicle with properly rated jack stands.

ALWAYS read and follow all safety information and warnings for the equipment you are using.

Required Tools:

1/4", 3/8" & 1/2" Socket Sets & Ratchets

Floor Jack

Jack Stands

Combination Wrench Set

Plier Set

Torque Wrenches

Section 1: Installing the New A-Arm Skid Plates

Step #1

Unpack and remove all of the components and hardware from its packaging, then verify all the components are present.

Fig: 1.1

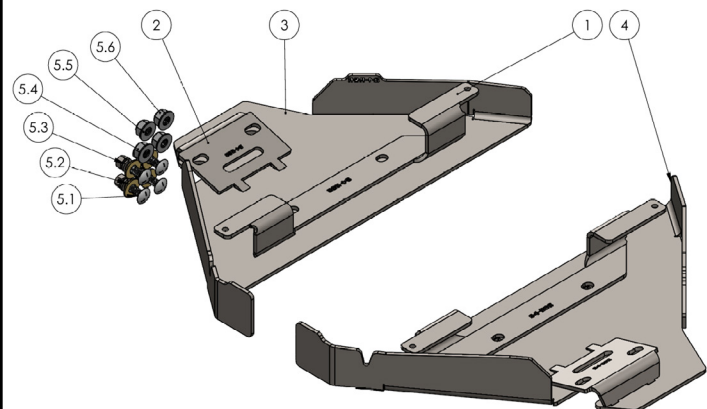

Step #2 Floor Jack & Jack Stands

If you are lifting the vehicle off of the ground, safely lift and properly support the vehicle, then support the front wheel from underneath as shown in **Fig: 1.2**.

Fig: 1.2



Section 1: Installing the New A-Arm Skid Plates

Step #3 18mm Socket & Ratchet

Remove the nuts (arrows in **Fig: 1.3**) for the lower shock mount.

Fig: 1.3



Step #4 18mm Socket & Ratchet

Align the holes on the new A-Arm skid plate with the lower strut bolts, then secure it in place with the provided hardware (arrows in **Fig: 1.4**).

Fig: 1.4

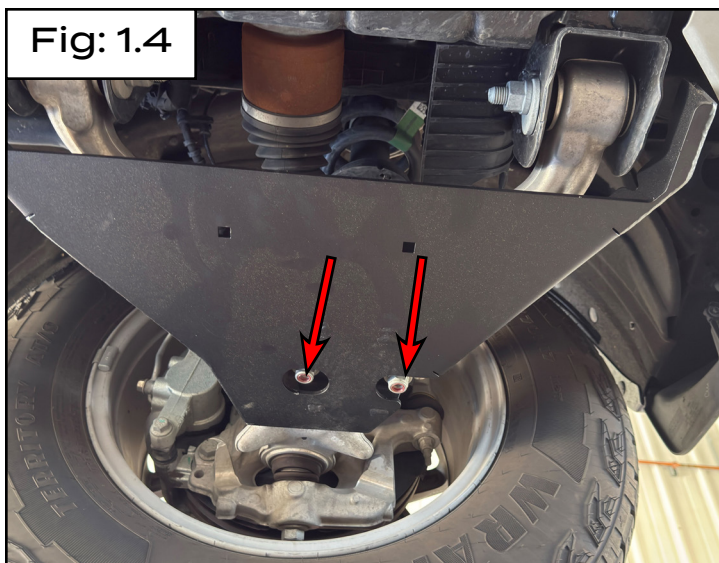

Section 1: Installing the New A-Arm Skid Plates

Step #5 | 9/16 Socket & Ratchet

Slide the A-arm skid plate over the top of the A-arm and secure it to the A-arm skid plate with the provided 3/8" hardware (**arrows** in **Fig: 1.5**) and tighten them until snug.

Fig: 1.5

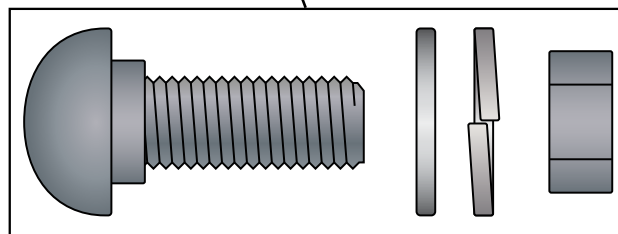
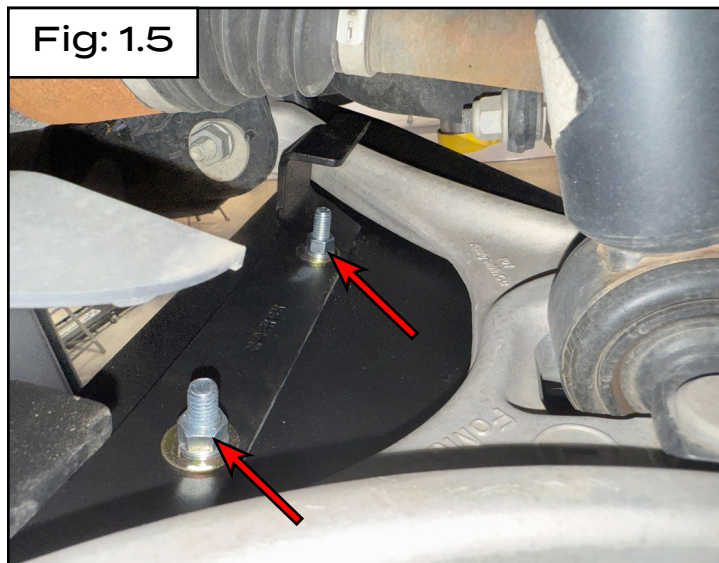

Step #6 | 18mm Socket & Torque Wrench

Torque the M12 nuts (**arrows** in **Fig: 1.6**) to **67 Ft-lb (90 Nm)**. Repeat *steps 1-6* for the opposite side A-arm skid plate installation.

Fig: 1.6

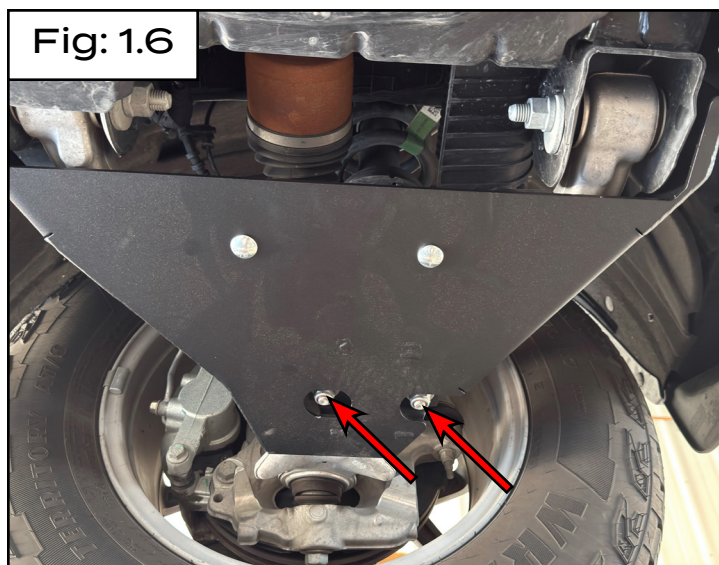

CONGRATULATIONS, YOUR INSTALLATION IS COMPLETE!

ENJOY YOUR NEW RCI PROTECTION!

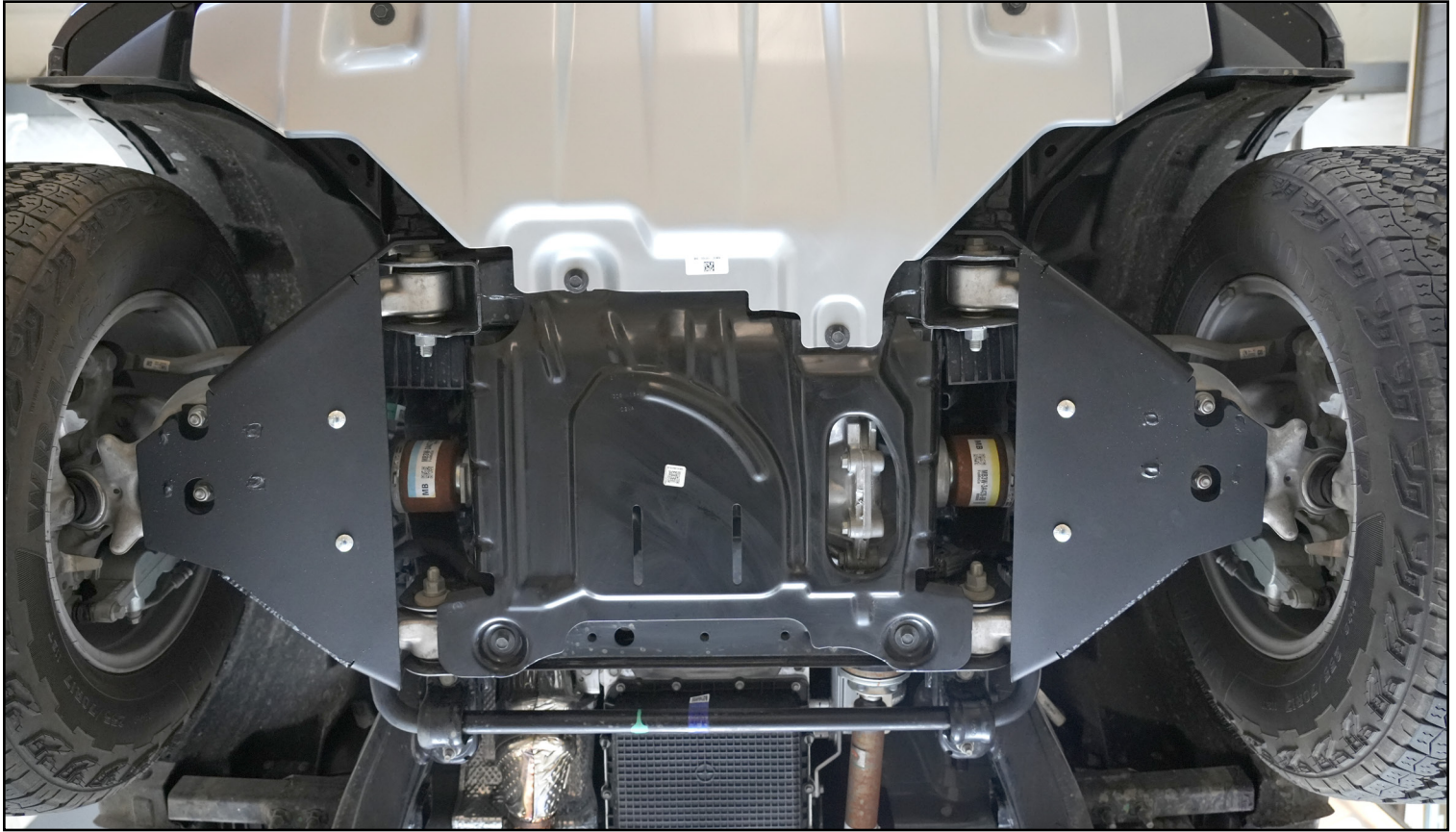

**Share your new install with us on social media!
We love seeing our products in the wild!**

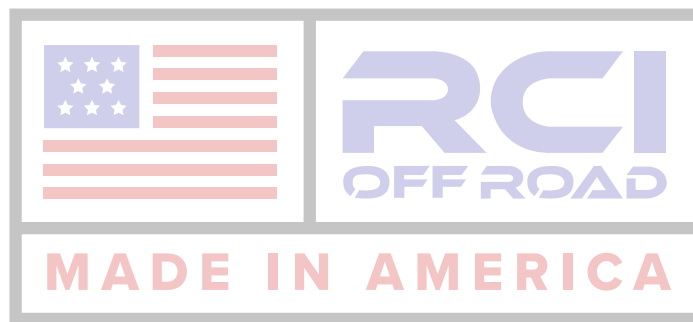

Follow us on social media:
[instagram.com/rcioffroad/](https://www.instagram.com/rcioffroad/)
[facebook.com/RCIOffroad](https://www.facebook.com/RCIOffroad)
[youtube.com/@RCIOFFROAD](https://www.youtube.com/@RCIOFFROAD)

Contact:
1.970.797.3089
SALES@RCIOFFROAD.COM
6701 N. FRANKLIN AVE. LOVELAND, CO 80538

These instructions are provided as a courtesy by RCI Offroad

Disclaimer: The products sold by RCI Metalworks are intended for off-road use only, should not be modified, and are for use only on the vehicle(s) specifically stated. RCI Metalworks makes no warranties express or implied, including of fitness for a particular purpose or merchantability. RCI Metalworks will not be liable for any damages arising out of the use or misuse of its products. It is the customers' responsibility to ensure the products are safely and properly attached to the vehicle, and all products should be installed by trained professionals. We strive to maintain extremely high-quality standards; however, all RCI Metalworks products are individually handcrafted, may vary slightly, and may contain minor imperfections. Due to the nature of raw aluminum, the material may have minor scratches and other blemishes caused by the manufacturing process, especially on the back side of product. RCI Metalworks is constantly seeking to improve its products and reserves the right to make changes to any product.