

RCI 25+ T4R Slider Installation Guide

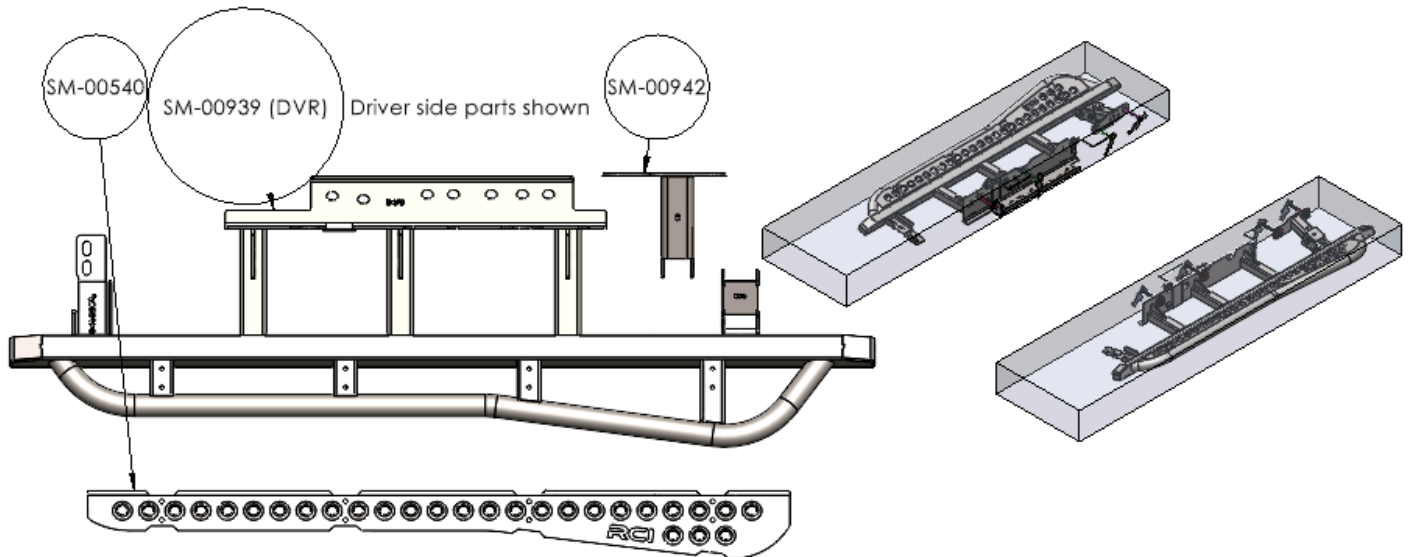

ITEM NO.	PART NUMBER	DESCRIPTION	QTY.
1	SM-00939 (PASS)	.188MS 24 Landcruiser Frame Plate	1
2	SM-00939 (DVR)	.188MS 24 Landcruiser Frame Plate	1
3	SM-00942	24 Landcruiser Rear Bolt On Leg Frame Plate	2
4	SM-00539	.075 MS FJ Tread Plate R2 Passenger	1
5	SM-00540	.075 MS FJ Tread Plate R2 Driver	1
6	HW-00004	3/8 Carriage Bolt Plate	2
7	SM-01004	5/16 Carriage Bolt Plate	1
8	SM-01003	7/16 Carriage Bolt Plate	5
9	SM-01006	Mounting Plate #4 .135MS	6
10	BX-00068	83.5x21.5x7 (24 Tacoma DCSB Slider Box)	2
11	HK-00164	24+ LC250 Slider Hardware Kit	1
28	HW-00023	5558B1M: M10-1.5 U-NUT .90MM-	4
29	HW-00021	M10-1.5 X 35MM HEX FLANGE BOLT	4
30	HW-00026	3/8 USS FLAT WASHER THRU HARD	4
31	HW-00042	Half Moon Spacer	2

UNLESS OTHERWISE SPECIFIED:		PROPRIETARY AND CONFIDENTIAL	NAME	DATE
DIMENSIONS ARE IN INCHES TOLERANCES: FRACTIONAL: ±0.010 ANGULAR: BEND ±0.5 TWO PLACE DECIMAL ± 0.015 THREE PLACE DECIMAL ± 0.010		THE INFORMATION CONTAINED IN THIS DRAWING IS THE SOLE PROPERTY OF RCI Offroad. ANY REPRODUCTION IN PART OR AS A WHOLE WITHOUT THE WRITTEN PERMISSION OF RCI Offroad IS PROHIBITED.	DRAWN	KL
			01/30/2025	
			Export Date	
			5/12/2025	
RCI OFFROAD				
TITLE: 24+ LC250 Slider SHIP Print BOM				
Item Number				REV
FG-00563				1
DO NOT SCALE DRAWING		SCALE: 1:24 WEIGHT:		SHEET 1 OF 32

This installation can be physically demanding and time intensive. It is highly recommended to recruit a friend or family member to assist in this installation and plan to spend 2-4 hours installing the sliders.

Hardware Order

****Before beginning installation, please take note of hardware order for each side of the slider. The slider hardware is not the same between the two sides and some of the frame plate mounting holes will not be utilized for this install.****

TWO THREAD PITCHES OF M10 HARDWARE ARE REQUIRED FOR THIS INSTALLATION. PLEASE TAKE A MOMENT TO SEPARATE OUT THE M10-1.5 X 35MM BOLTS. THESE CAN BE DISTINGUISHED BASED ON THEIR SLIGHTLY LONGER LENGTHS, AND CAN BE THREADED INTO THE INCLUDED M10-1.5 SPEEDCLIPS TO VERIFY.

HARDWARE LOCATIONS(SLIDERS SHOWN WITHOUT OUTER RAILS FOR VISIBILITY)	
CALLOUT	HARDWARE SIZE
1	5/16
2	3/8
3	7/16
4	M10-1.5 X 35MM
5	M10-1.25 X 30MM
6	M8 - 1.25 X 30MM

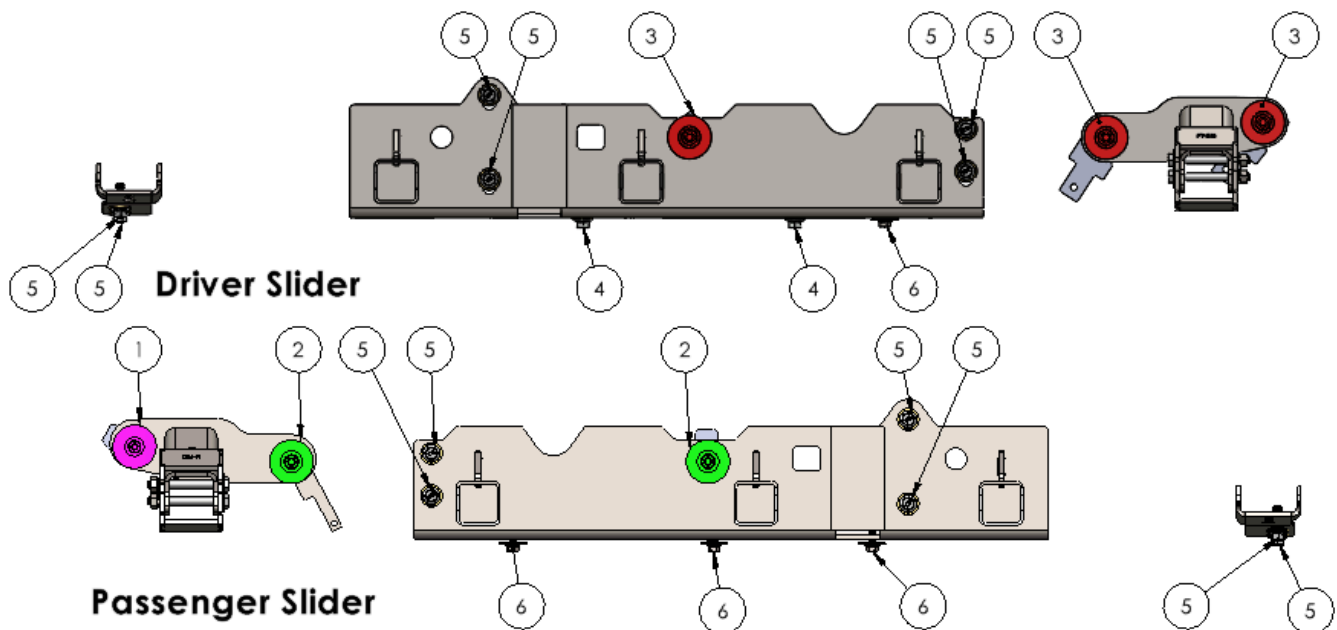

RCI OFFROAD

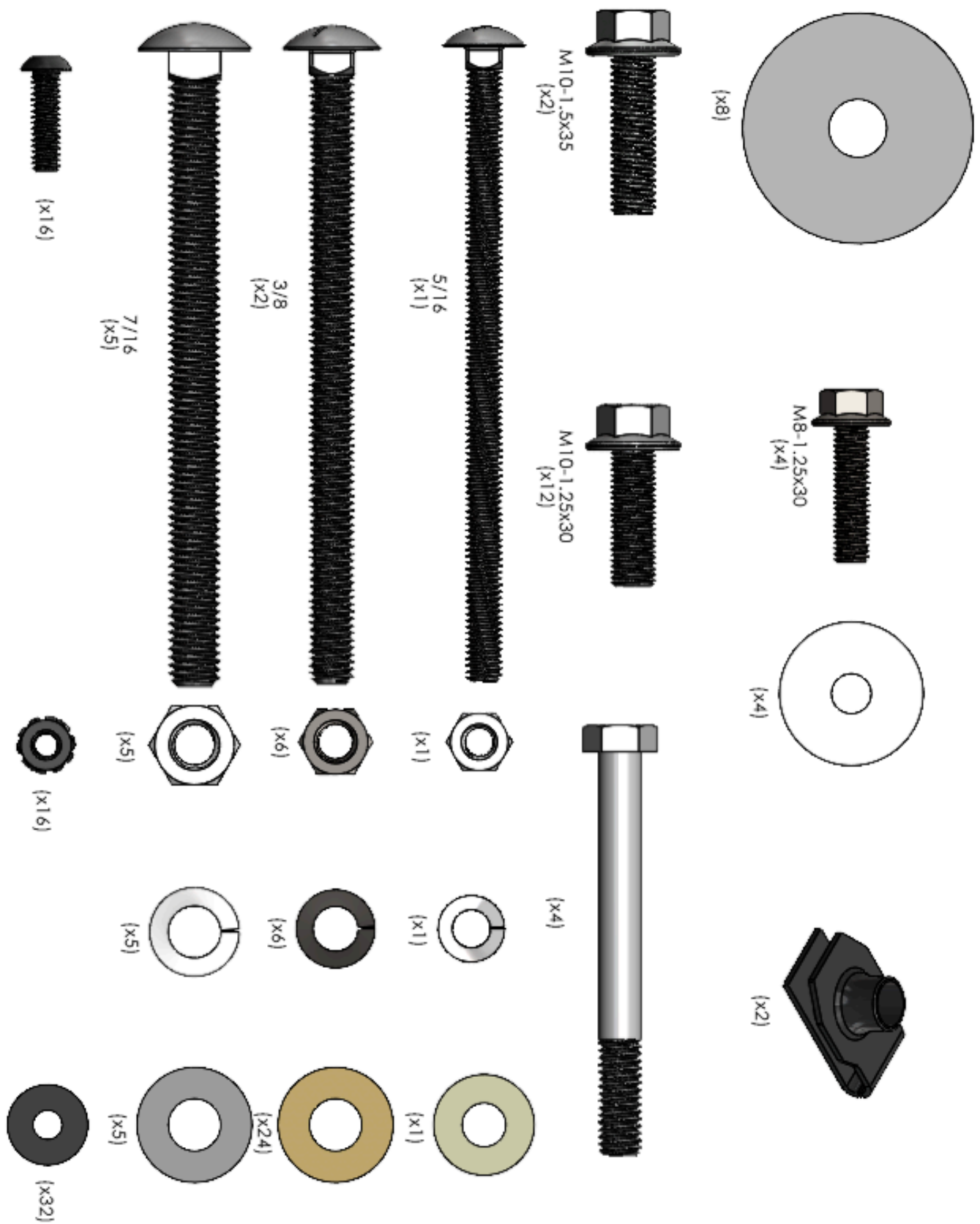

RCI OFFROAD

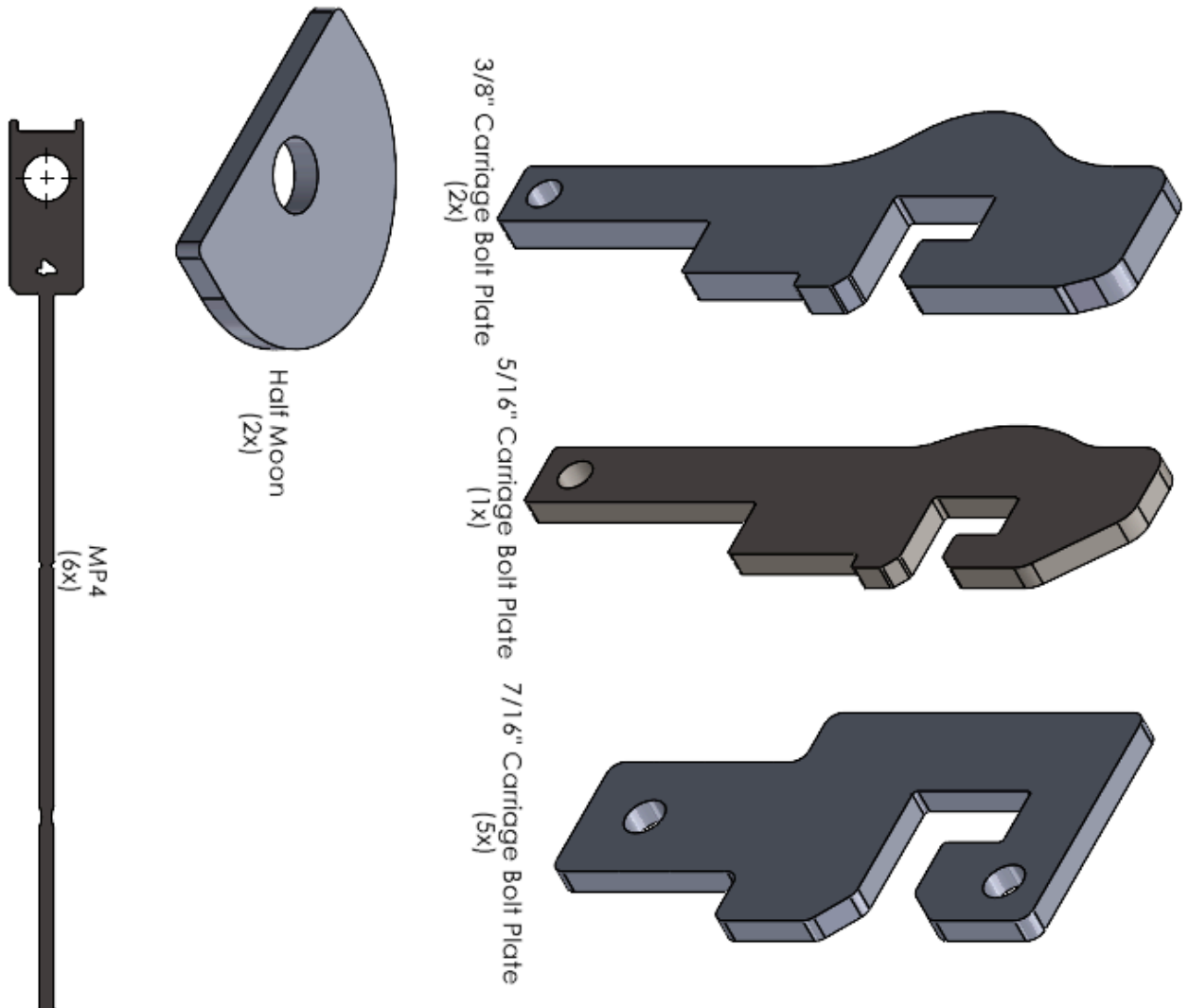
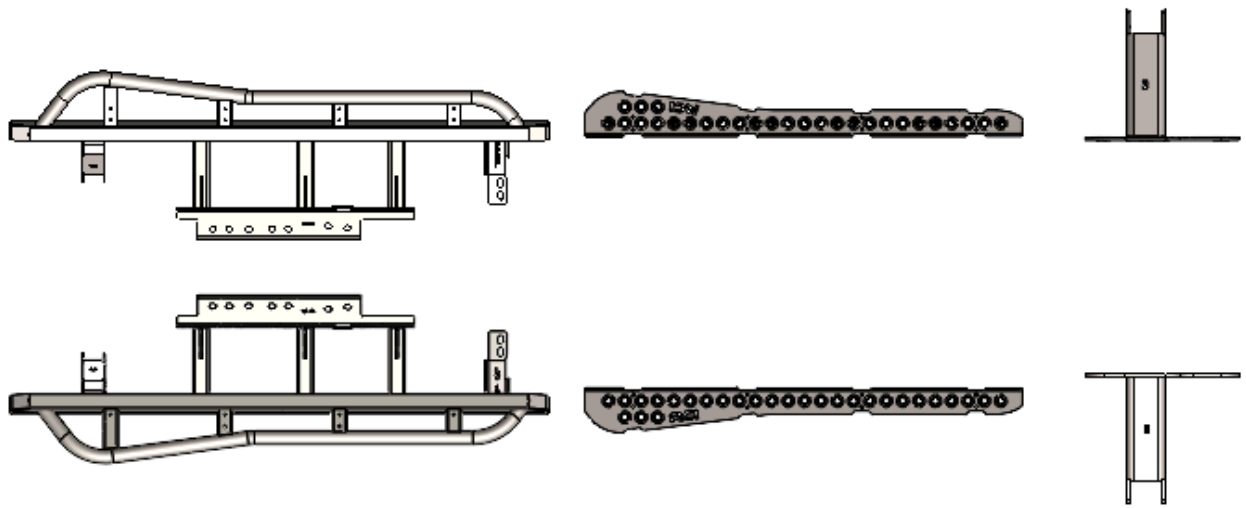



INSTALLATION STEPS:

****Use hand tools, impact wrenches may cause damage if over torqued.**

1. Begin by unpacking and removing all components and hardware. Please verify that all hardware, components, and mounting components are present. Please reference your original order invoice and verify all items are accounted for.
2. On the passenger side, remove all the frame-mounted accessories/hardware that may interfere with the installation of the RCI LC250 Sliders
 - a. Remove all plastic caps from the inside and outside of the vehicle frame
 - b. Remove the factory or RCI fuel skid. Other aftermarket fuel skids will likely also require removal.
3. Identify the passenger side slider and lift it up to the frame on the passenger side of the vehicle.
 - a. Use of a floor jack or similar equipment will make this process significantly easier.
 - b. Take special care to avoid pinching the grounding wire, its mounting clip, the plastic wire harness mount, and/or any other frame-mounted wires and lines.
4. Loosely thread the included M8 bolt and fender washer through the bottom of the frame plate and into the tapped mounting locations of the frame

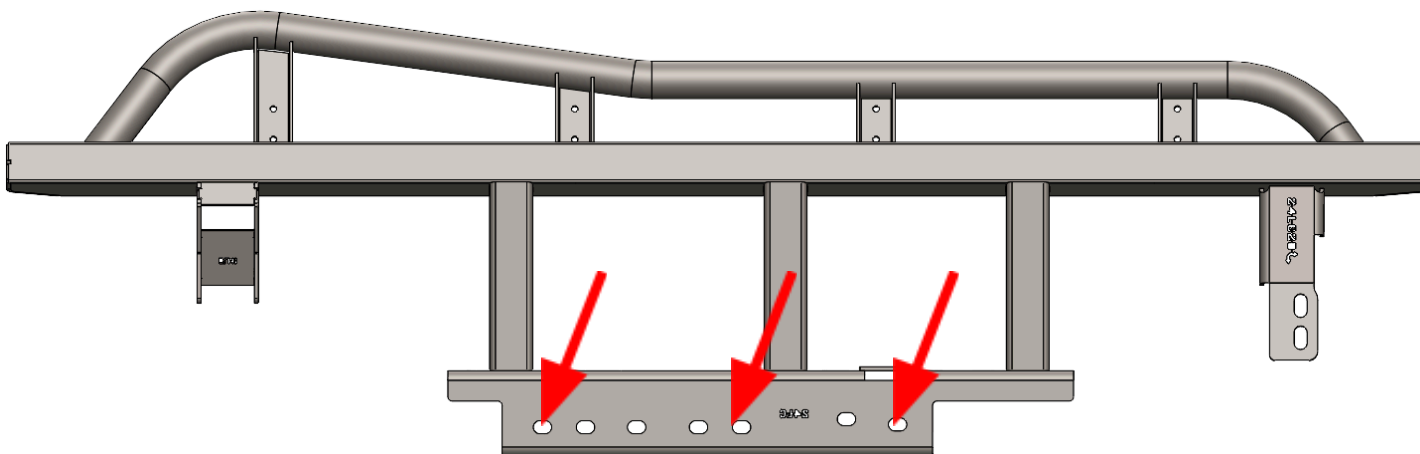

RCI OFFROAD

5. Loosely thread the included M10-1.25x30mm bolts and 3/8" washers into the remaining locations along the frame
 - a. Align the mounting locations on the front leg of the RCI 24+ Landcruiser with the tapped holes on the front body mount of the vehicle and loosely thread in two sets of M10 hardware

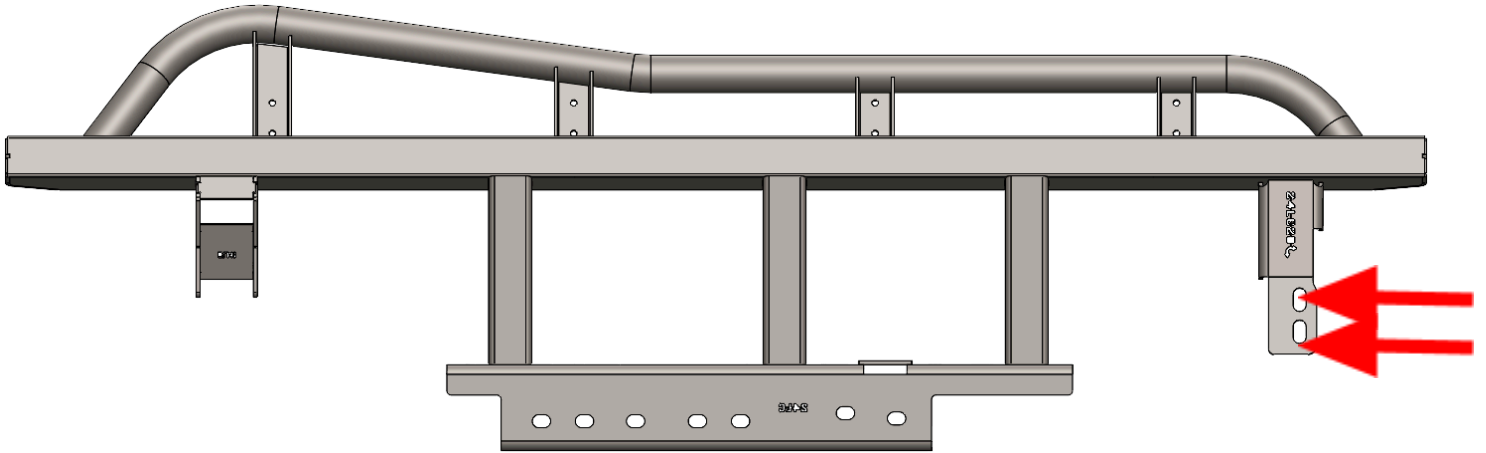

RCI OFFROAD

- b. Align the slots in the vertical face of the frame plate with the tapped holes on the frame and loosely thread in four sets of M10 hardware.
 - i. **On 2025 TRD Offroad trim vehicles, these holes may not be tapped and threaded. If your vehicle does not have threaded holes here, please refer to the next step.**

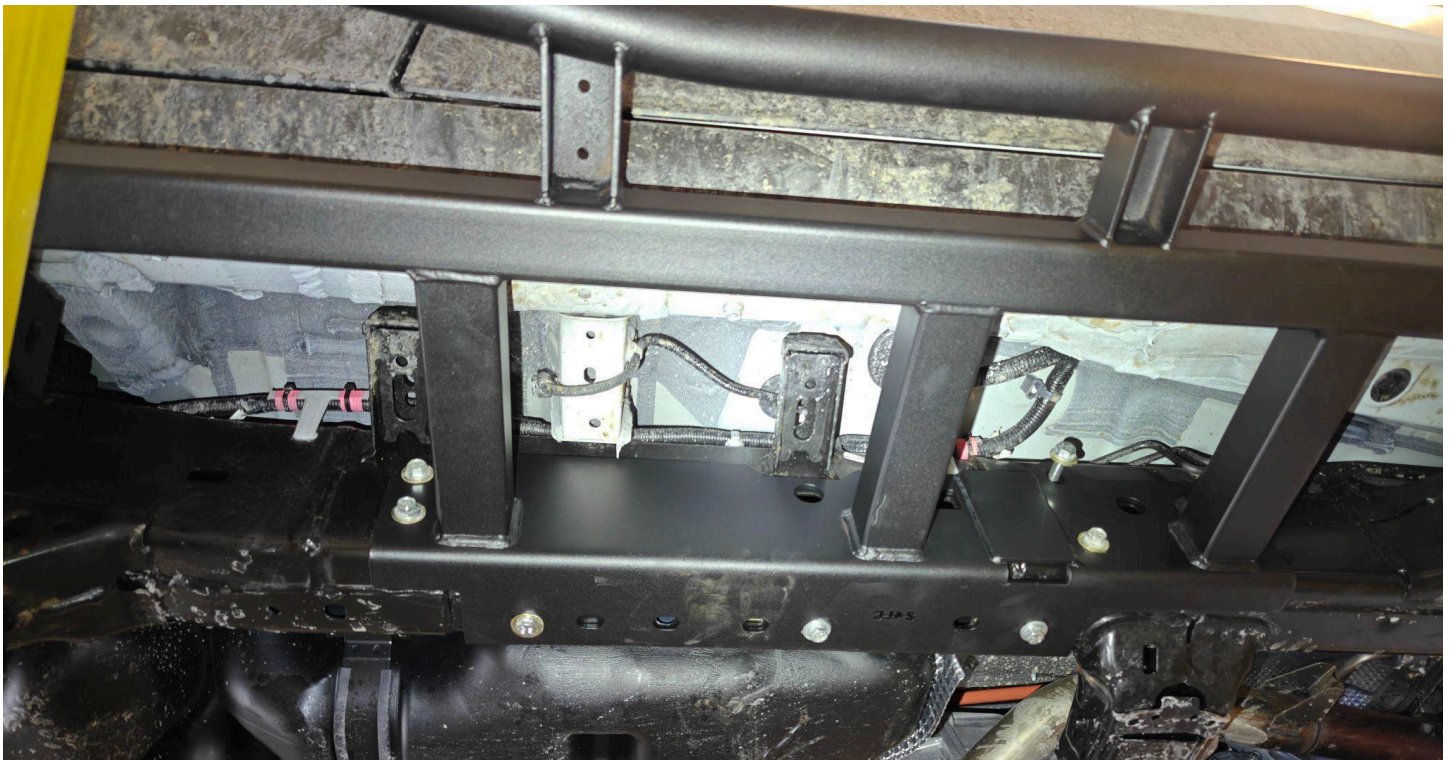
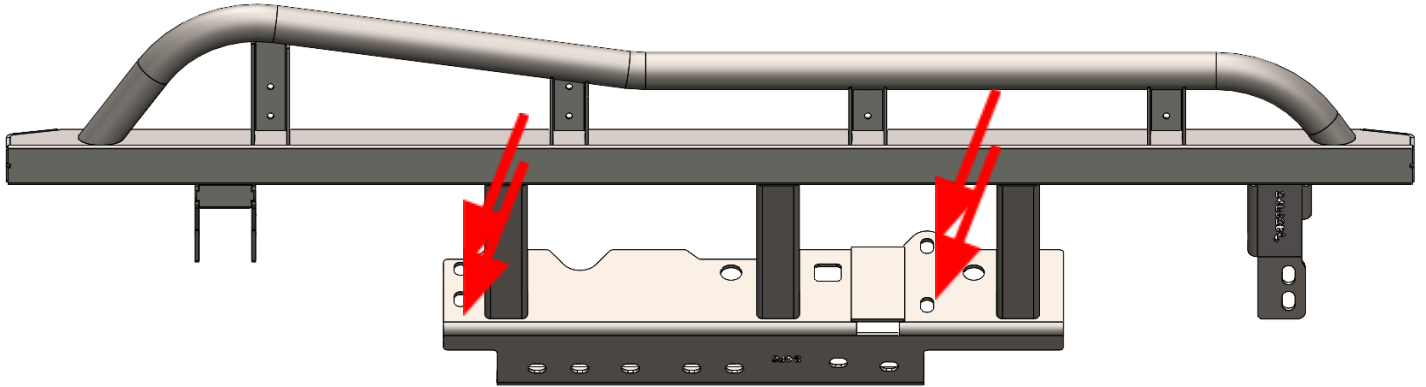

6. On 2025 TRD OFFROAD vehicles, the tapped holes from the previous step may not be threaded. If your vehicle has threaded holes and you were able to complete the previous step successfully, please skip this step and continue to the next step.
- a. You may optionally choose to trim the remaining “tail” of each MP4 or bend them out of the way after this step. However, this is not a necessary step and the remaining “tail” will not interfere with anything moving forward.
 - b. Bend an MP4 at the first set of notches from the larger end of the plate and install an M10 speed clip with the flat face on the same side of the MP4 as the bend.

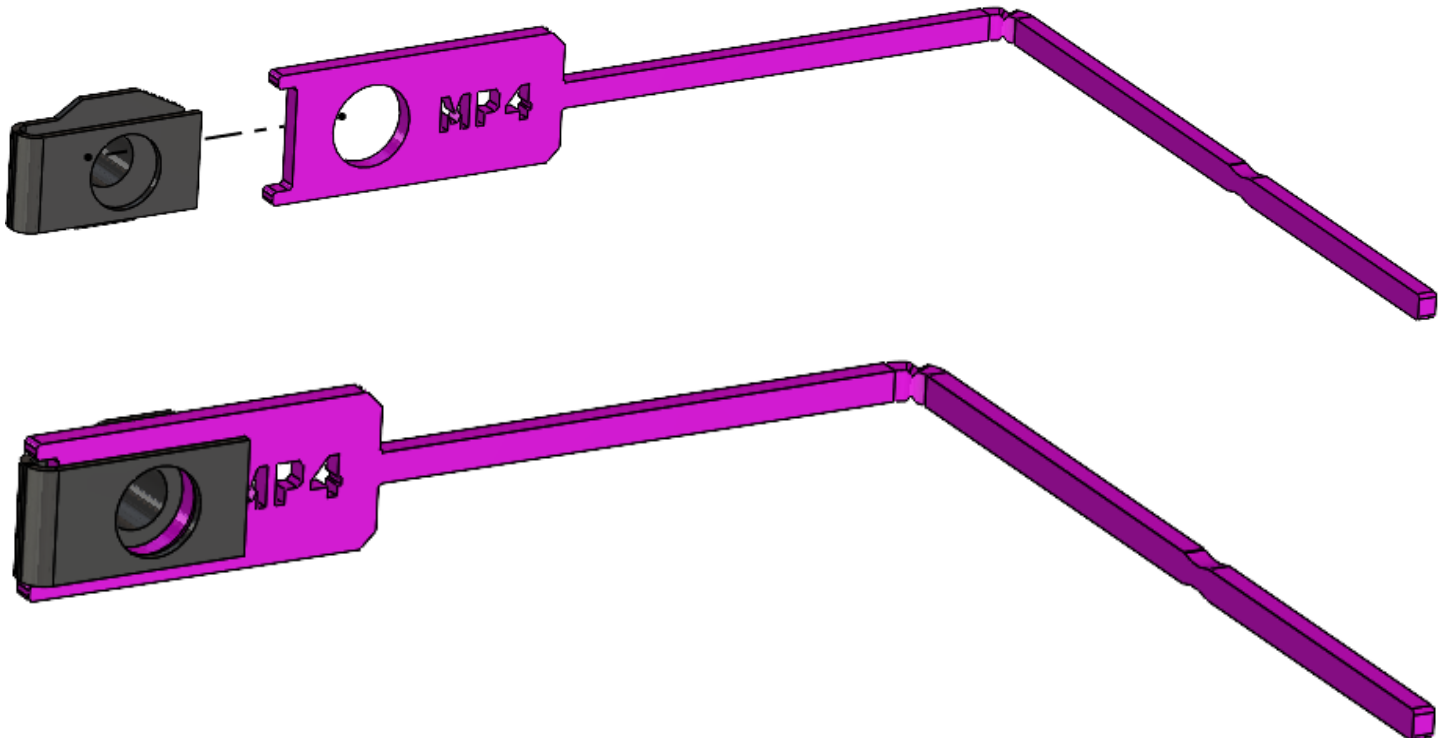

- c. Insert the MP4 assembly through the rectangular hole in the slider frame plate. Align the speed clip with the upper hole at the front of the slider frame plate and loosely thread an M10-1.5 X 35MM into the threaded speed clip.

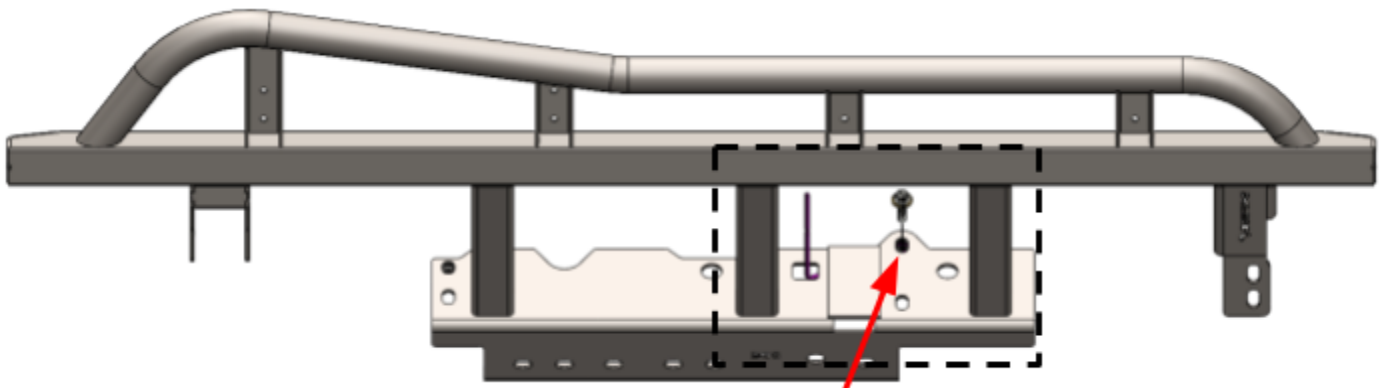

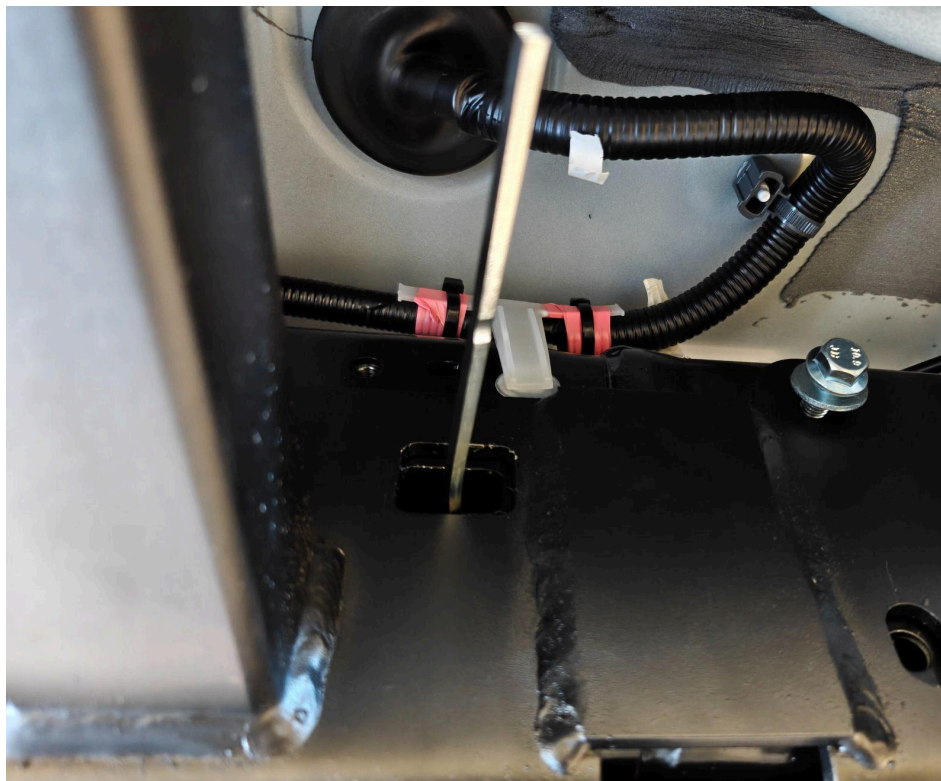
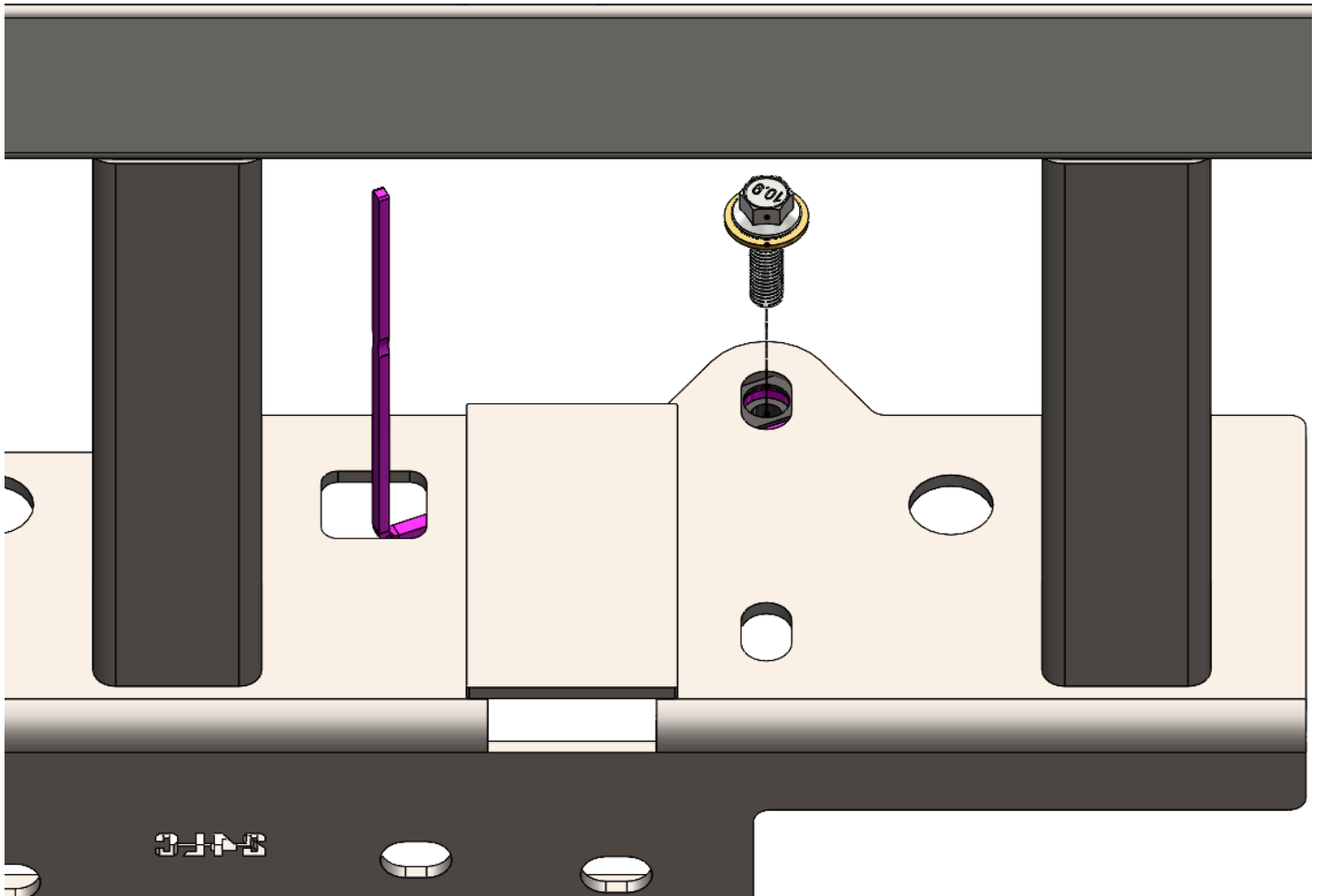

- d. Bend an MP4 past the first set of notches from the larger end of the plate and install an M10 speed clip with the flat face on the same side of the MP4 as the bend.
 - i. Make the bend 4.5" from the end of the "body" of the MP4.

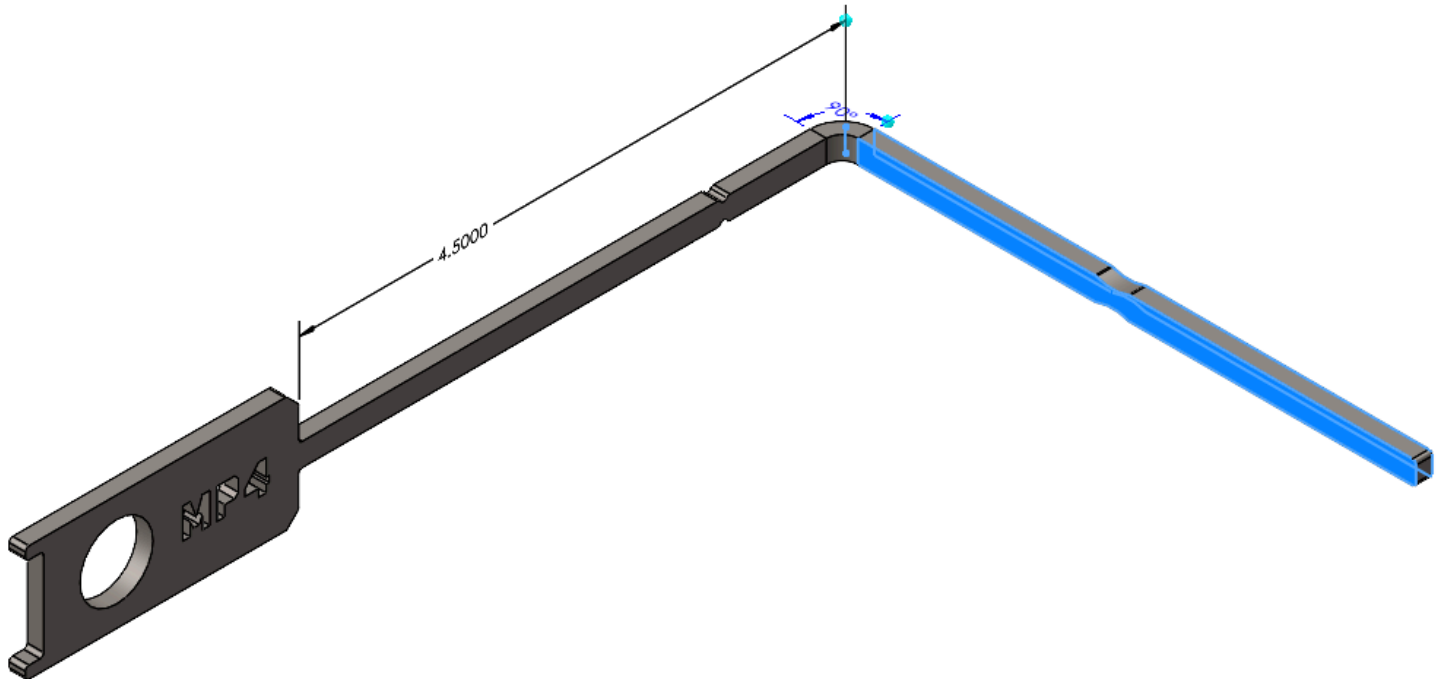

- e. Insert the MP4 assembly through the rectangular hole behind the slider frame plate. Align the speed clip with the upper hole at the rear end of the slider frame plate and loosely thread an M10-1.5 X 35MM into the threaded speed clip.

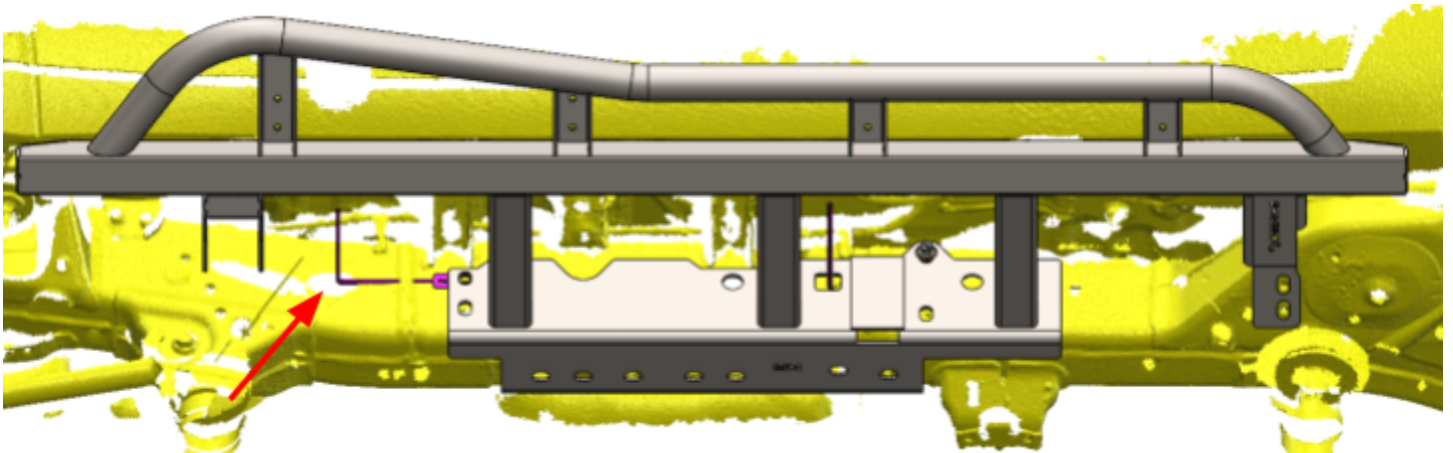



RCI OFFROAD

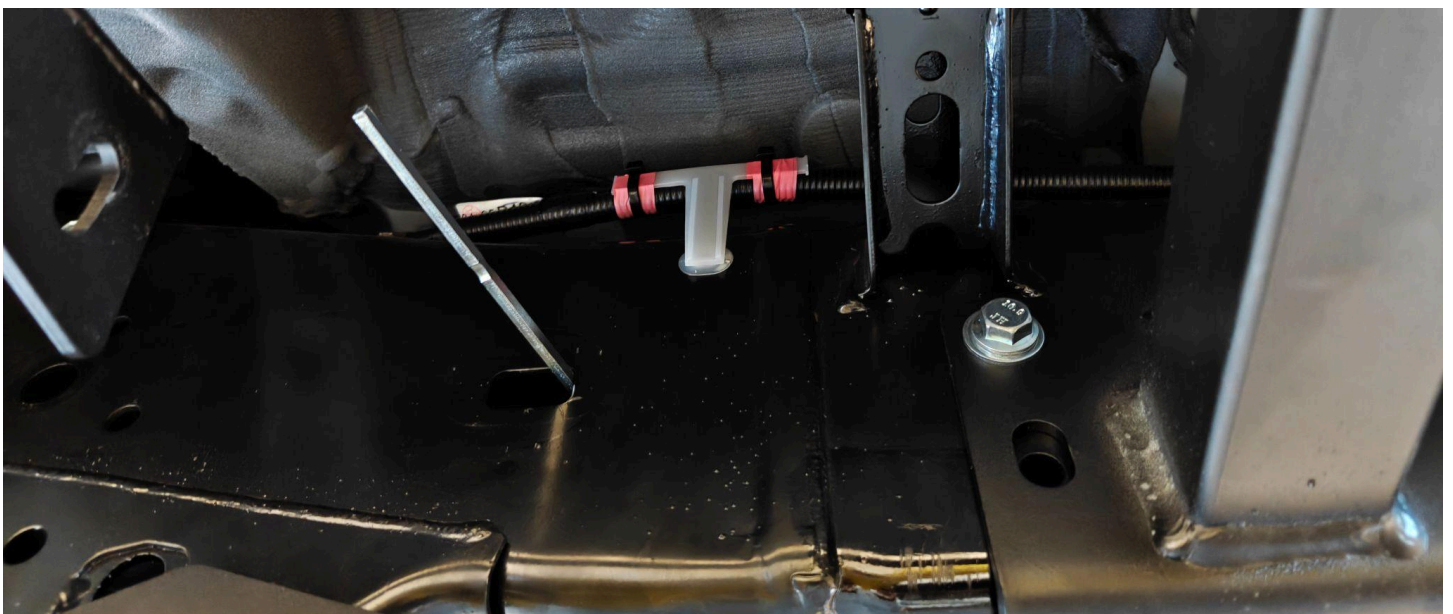
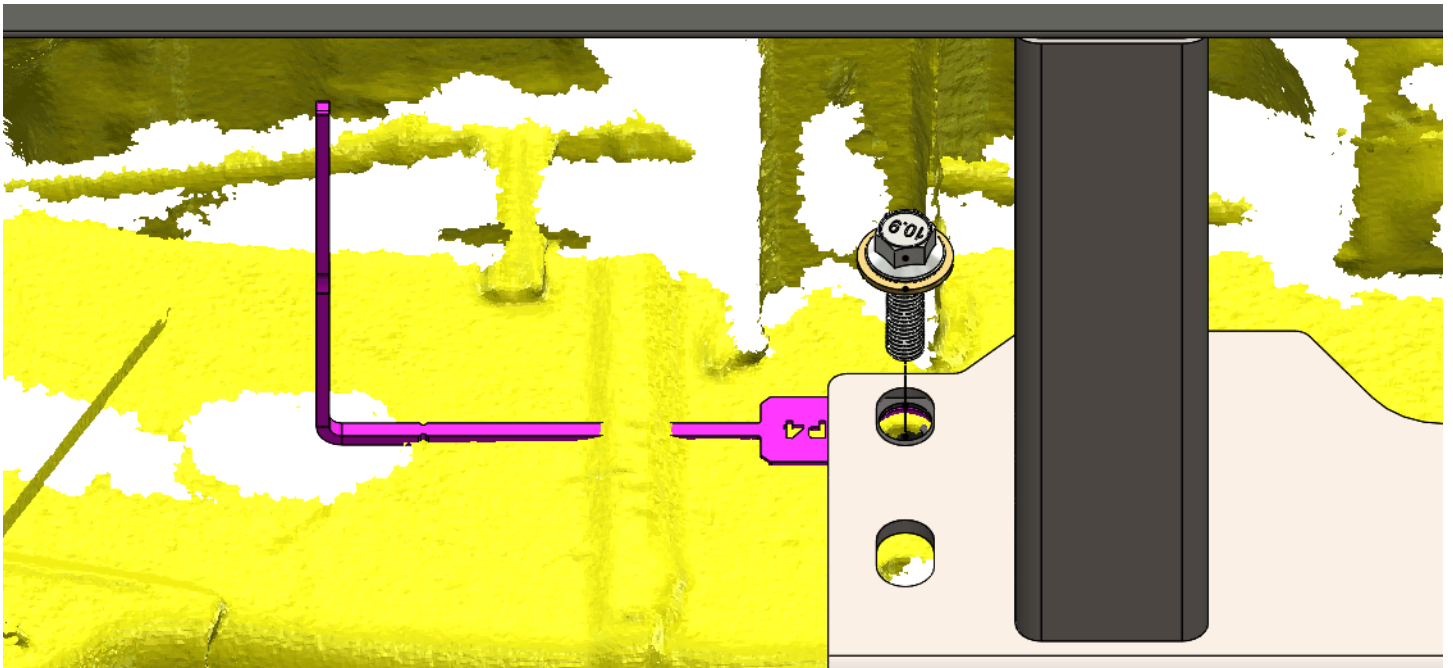
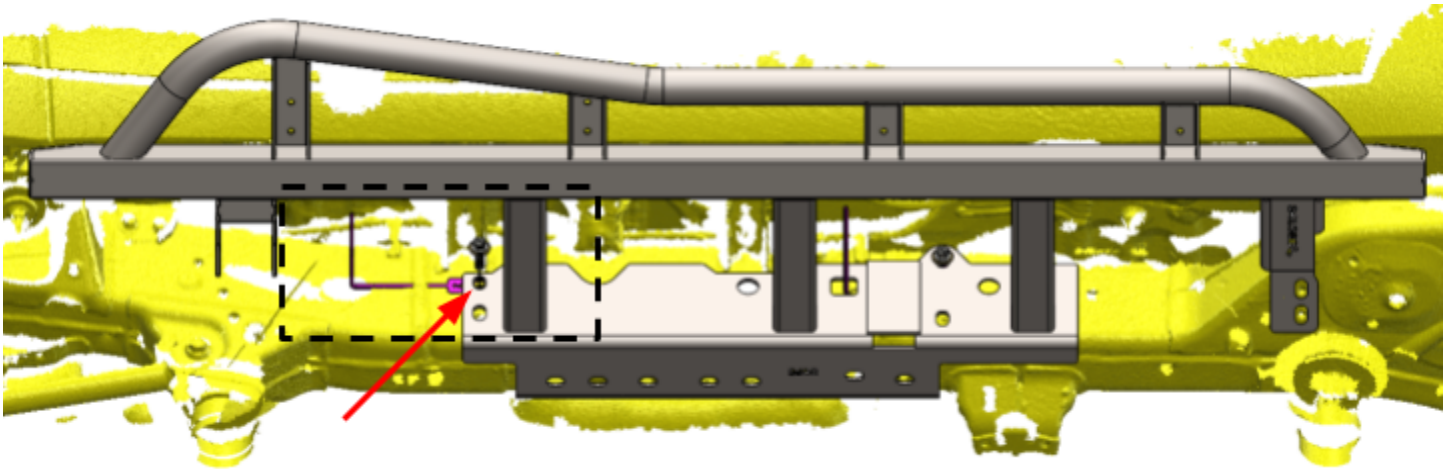

7. Align the rear bolt on-leg with the bolt-on leg mount welded to the main rail of the slider. Loosely install the pair of included 3/8" x 3.5" hex bolts, washers, split washers, and nuts.

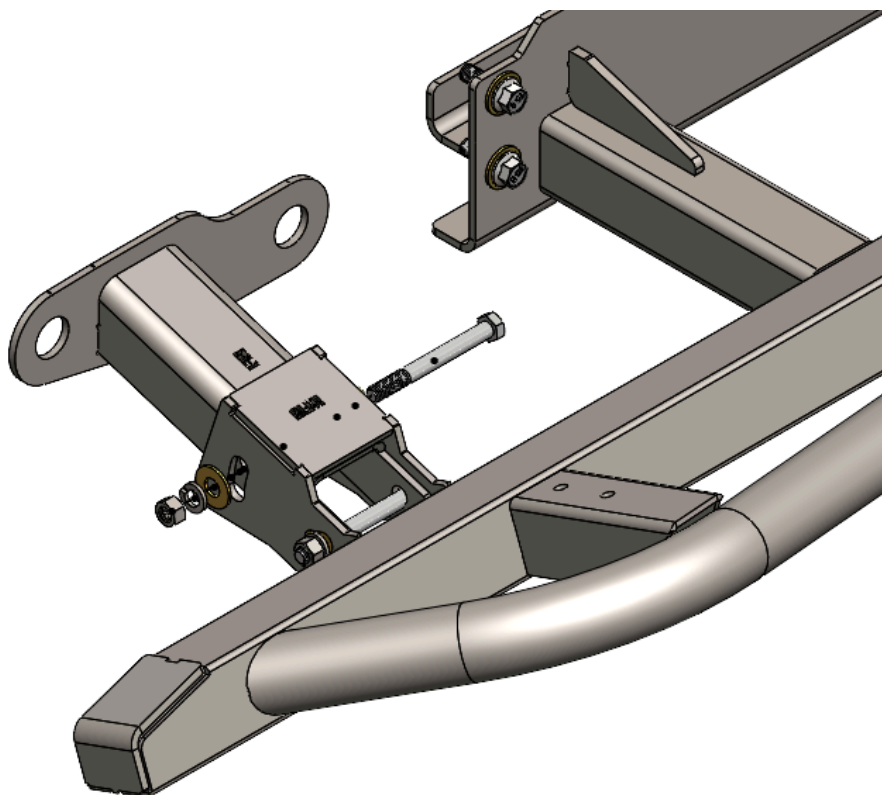
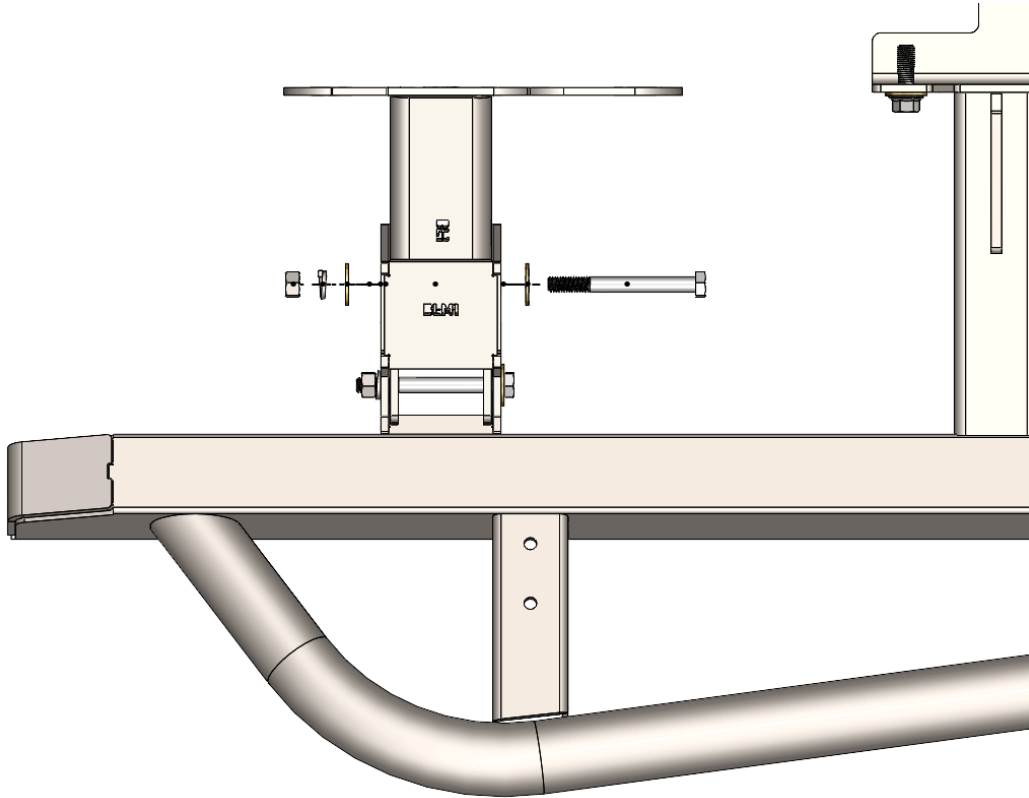

- a. On 2025 TRD Offroad trim vehicles using MP4s carefully feed the “tail” of the MP4 through the front hole of the rear leg frame plate.

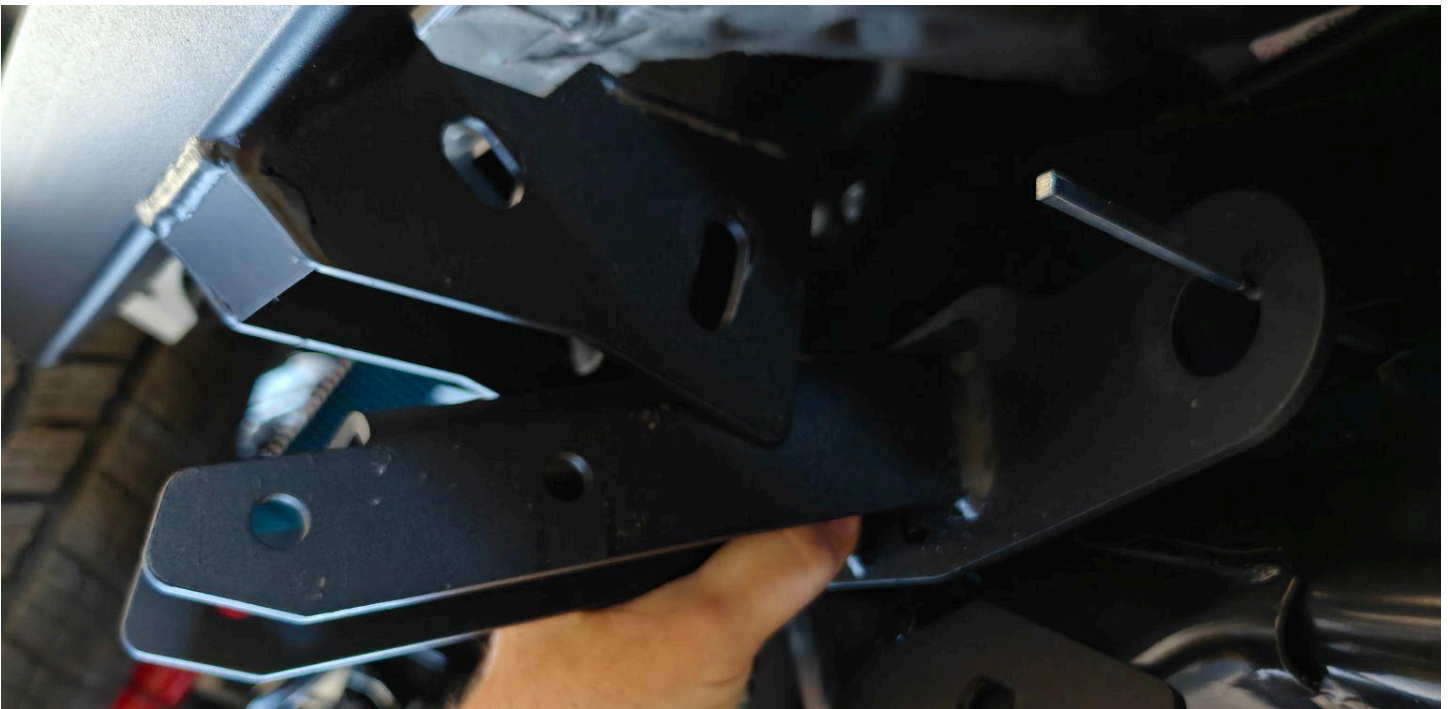

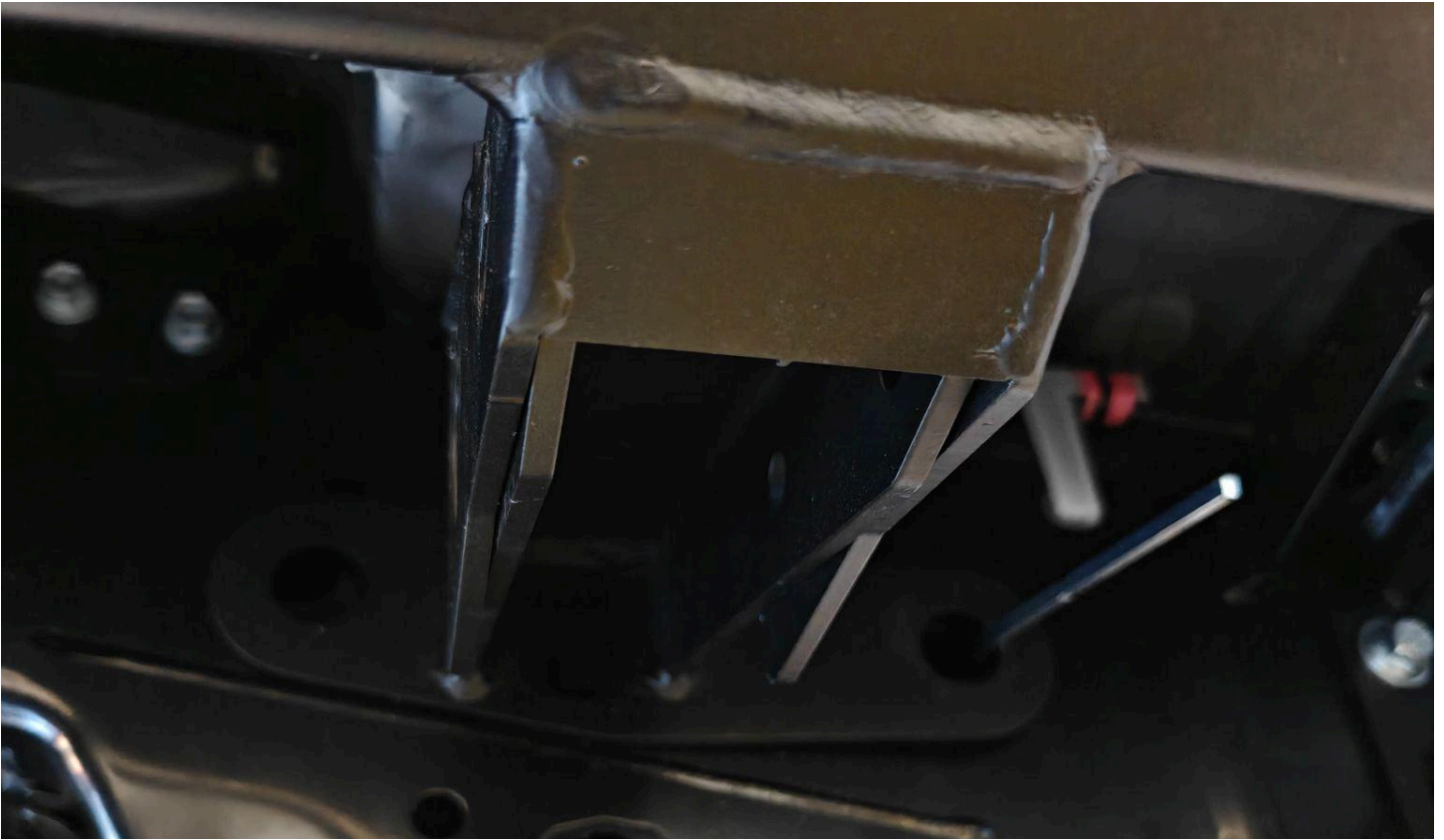

8. With the frame plate of the slider aligned with the frame of the vehicle, pass a 5/16" carriage bolt assembly head-first through the hole in the rear of the frame plate and through the frame.



9. Repeat the process with a 3/8" carriage bolt assembly through the hole in the front of the frame plate.

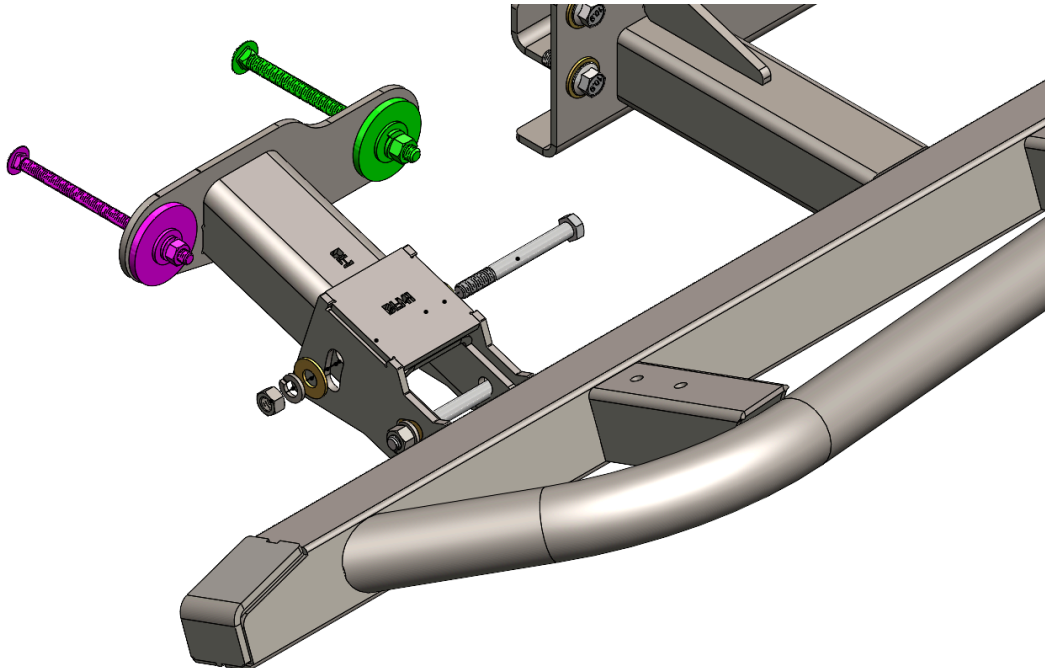

- a. On 2025 TRD Offroad trim vehicles using MP4s, substitute the included “half moon” washer on the 3/8" carriage bolt assembly.

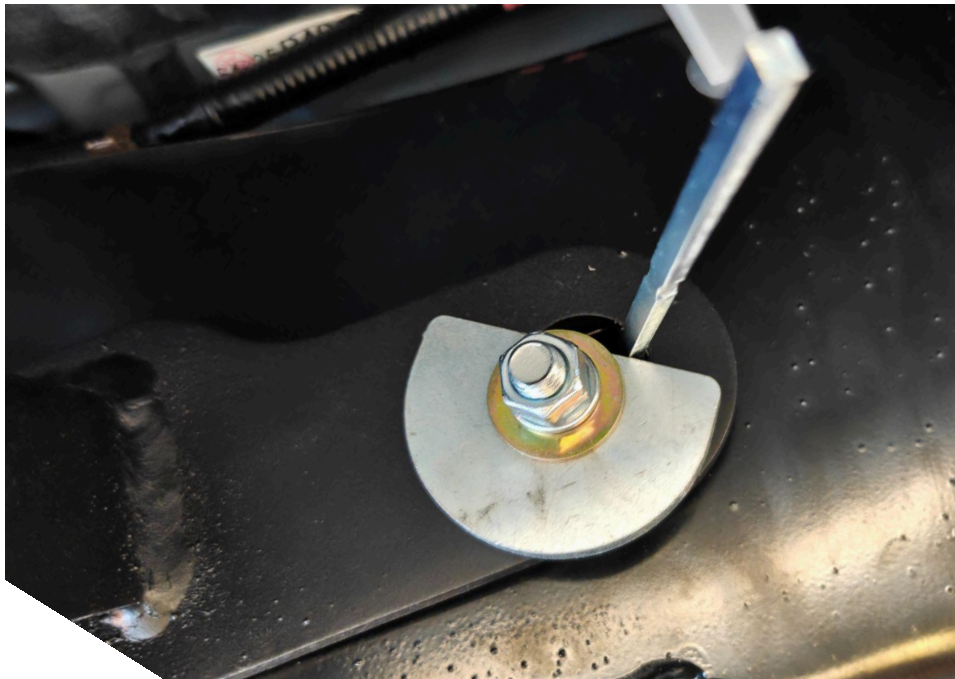
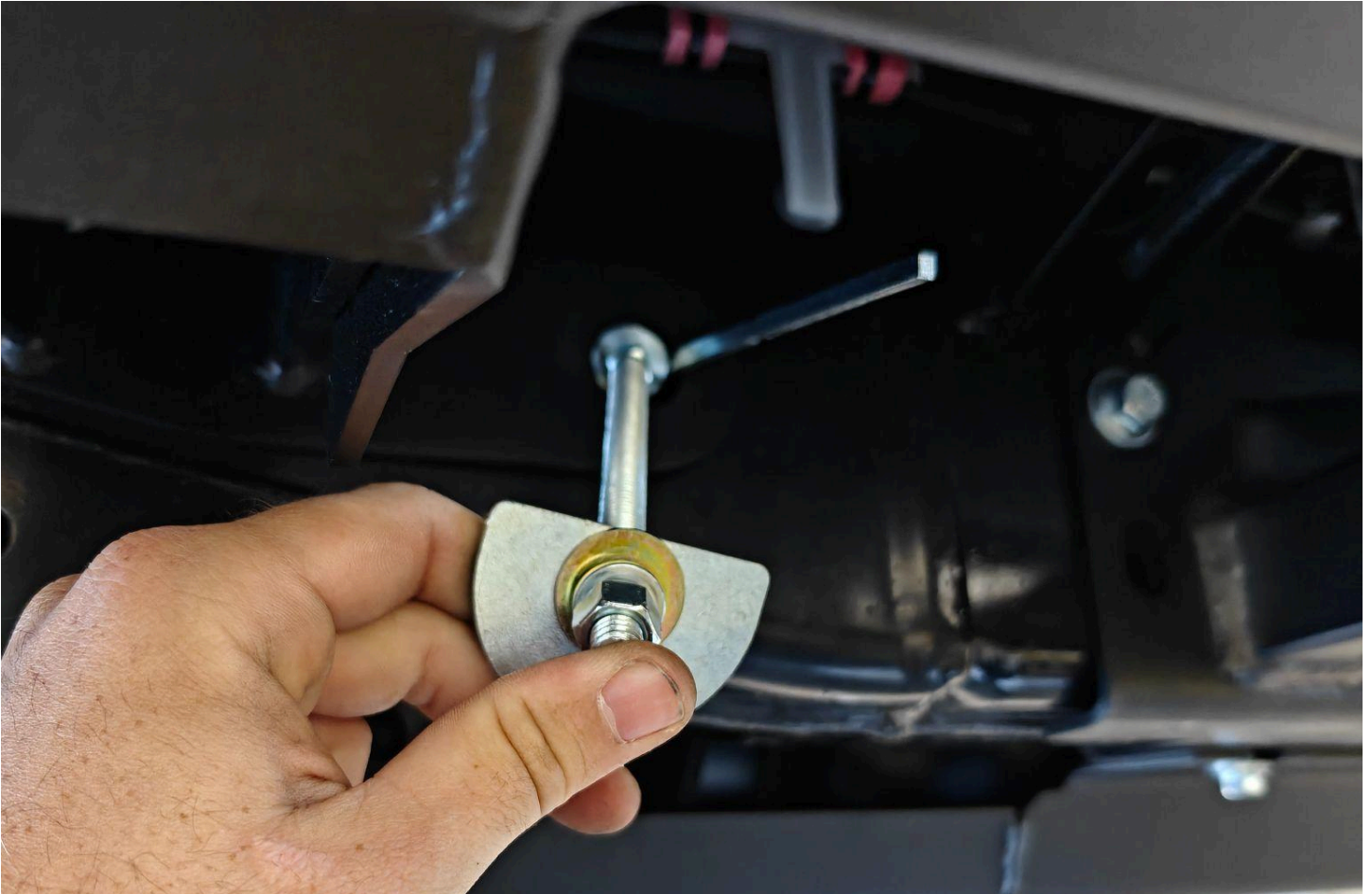

10. Reach between the fuel tank and frame of the vehicle to hook carriage bolt plates on each of the carriage bolt heads.
- The front carriage bolt will receive a 3/8" carriage bolt plate and the rear carriage bolt will receive a 5/16" carriage bolt plate. The 5/16" carriage bolt plate is the smaller of the two.

5/16 CARRIAGE BOLT PLATE



3/8 CARRIAGE BOLT PLATE

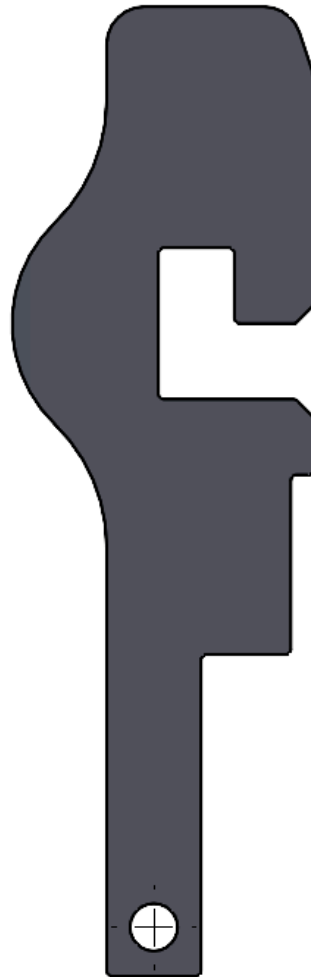

RCI OFFROAD 

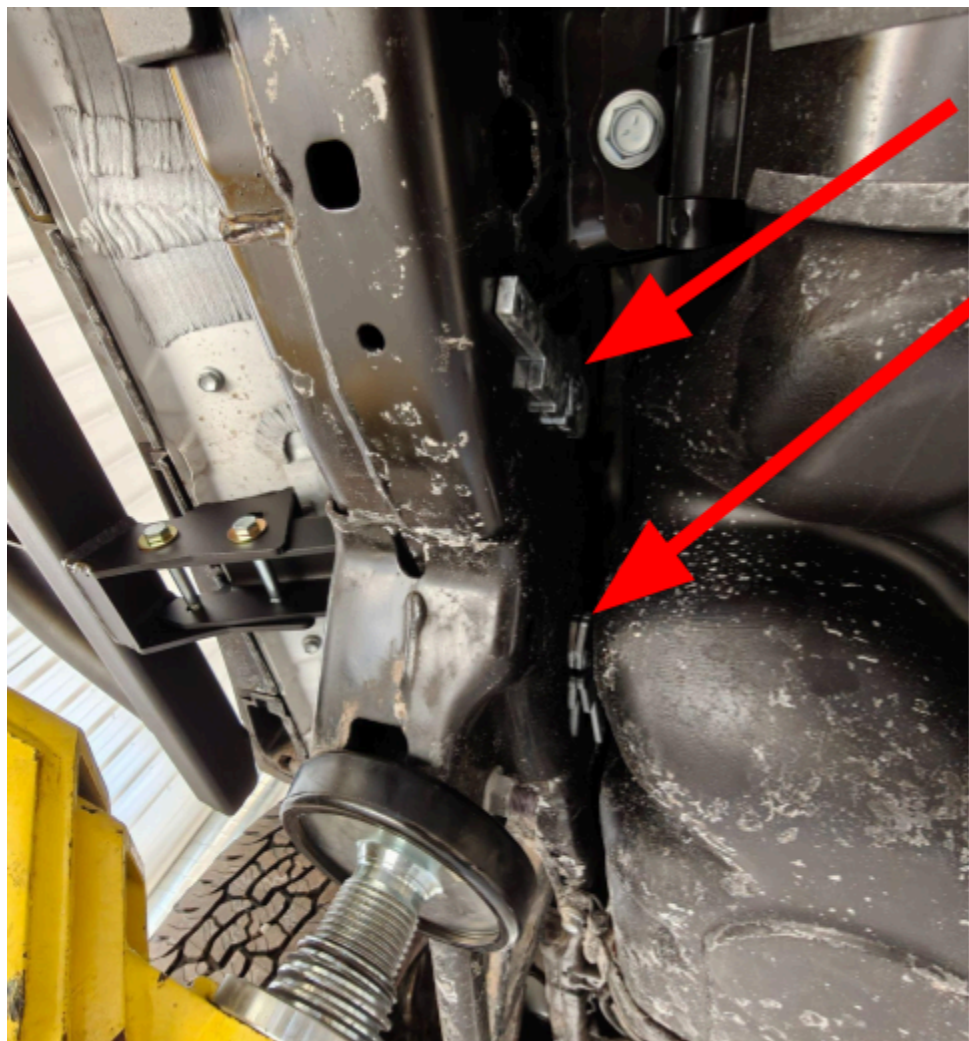
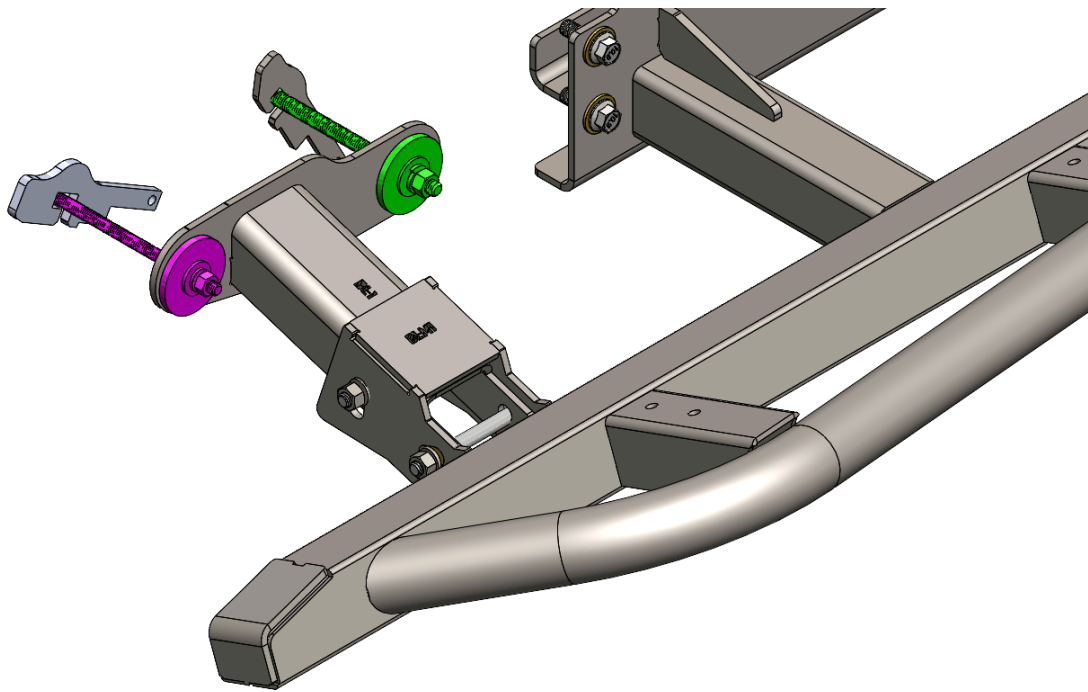

11. With the rear leg frame plate aligned with the frame of the vehicle, tighten the carriage bolts to secure the rear leg.
 - a. Torque the 3/8" carriage bolts to 20 lb-ft.
 - b. Torque the 5/16" carriage bolts to 12 lb-ft.
12. Tighten all of the lower hardware from the front leg and the main frame plate.
 - a. Torque the M10 hardware to 60 lb-ft.
 - b. Torque the M8 hardware to 30 lb-ft.
13. Finally, tighten the remaining M10 hardware to 60 lb-ft.
14. Insert another 3/8" carriage bolt assembly through the circular hole at the center of the slider frame plate. Like the others, this carriage bolt will be fed head-first through the slider frame plate and through the frame

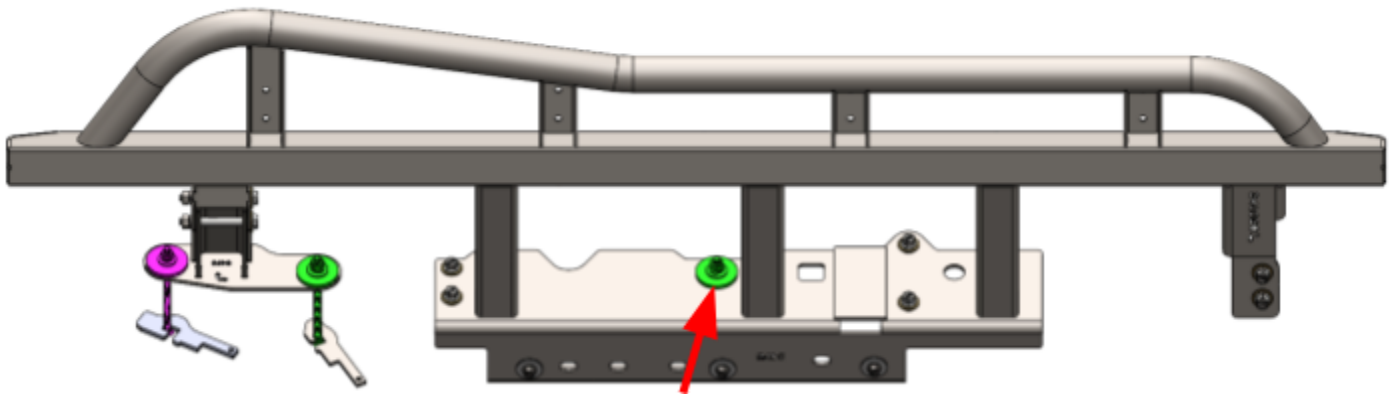

15. Once again, reach between the vehicle frame and the fuel tank to hook a carriage bolt plate on the exposed head of the 3/8" carriage bolt from the previous step.

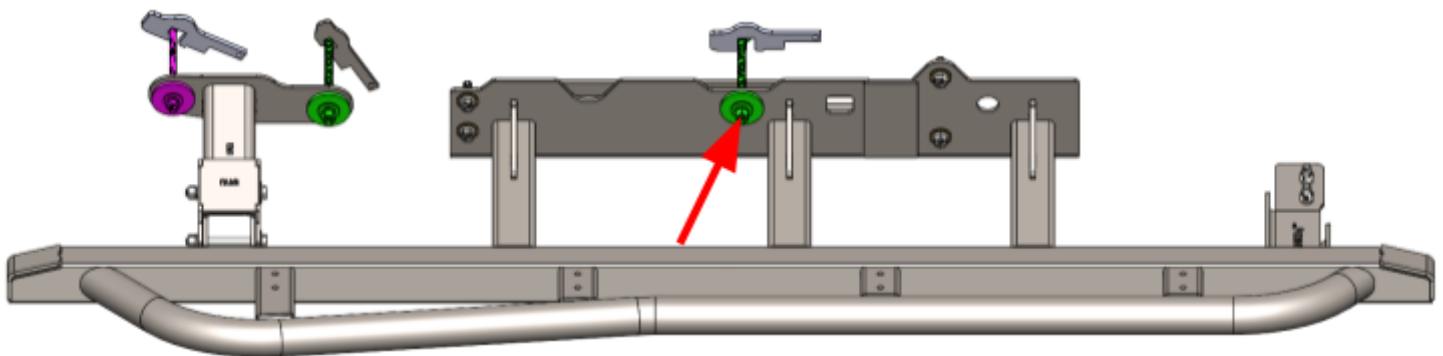



16. From the inside of the vehicle frame, insert a 7/16" carriage bolt through the frame and front of the frame plate. Once through, loosely secure the carriage bolts with the supplied 7/16" carriage bolt plates, washers, lock washers, and nuts.

- a. **Hybrid owners, skip this step. The rear crossmember blocks access to this location.**

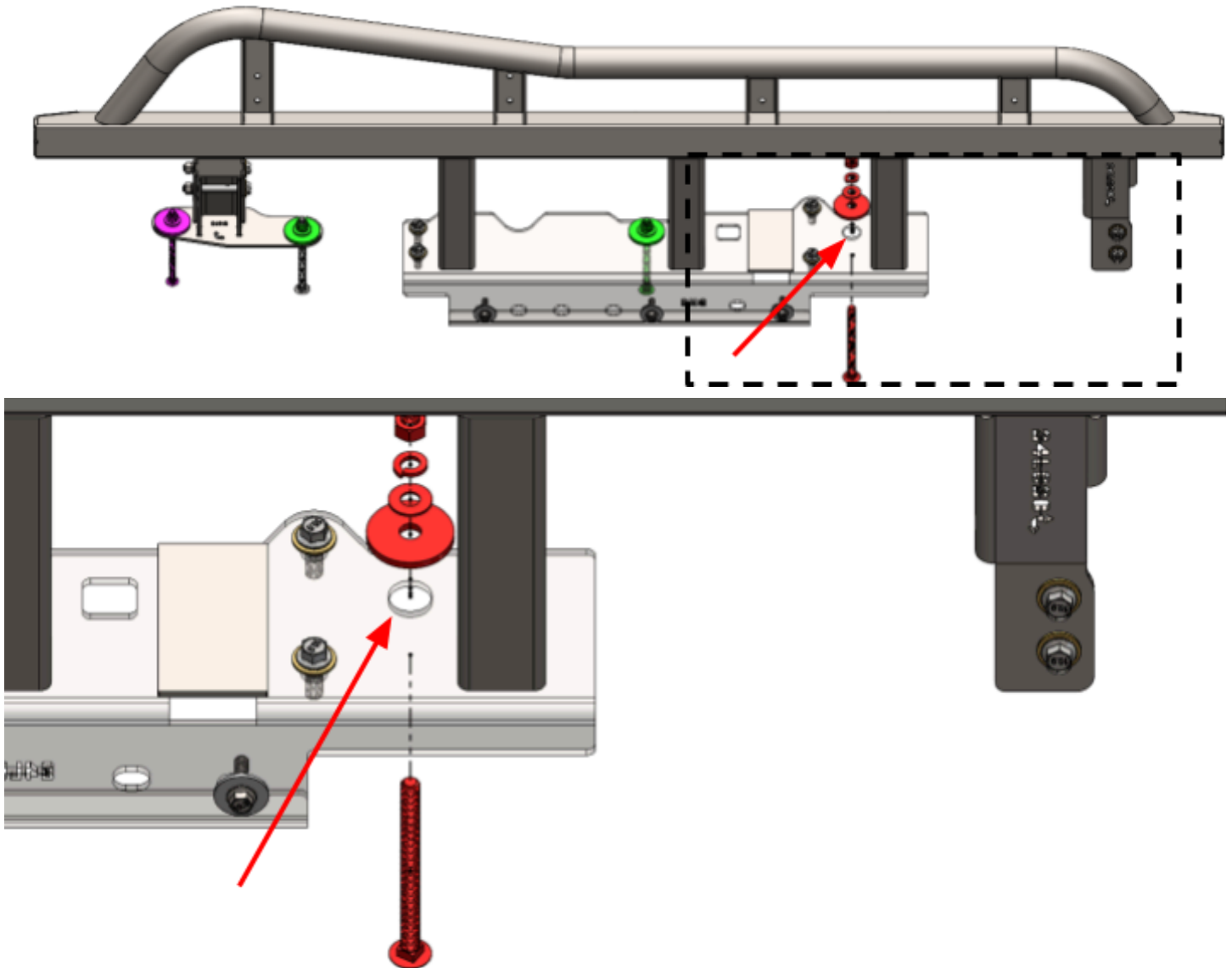

17. Inspect all hardware and ensure they are tightened to the following torque specs:

- a. Torque the 7/16" carriage bolts to 20 lb-ft.
- b. Torque the 3/8" carriage bolts to 20 lb-ft.
- c. Torque the 5/16" carriage bolts to 12 lb-ft.
- d. Torque the M10 hardware to 60 lb-ft.
- e. Torque the M8 hardware to 30 lb-ft.

18. As applicable, reinstall any fuel skids or other accessories removed at the beginning of this process.

19. On the driver side, remove all the frame-mounted accessories/hardware that may interfere with the installation of the RCI LC250 Sliders

- a. Remove all plastic caps from the inside and outside of the vehicle frame
- b. Remove the factory or RCI T-case skid plate. Other aftermarket skids will likely also require removal.

20. Assemble the MP4 mounting plates by installing an included M10 speedclip.

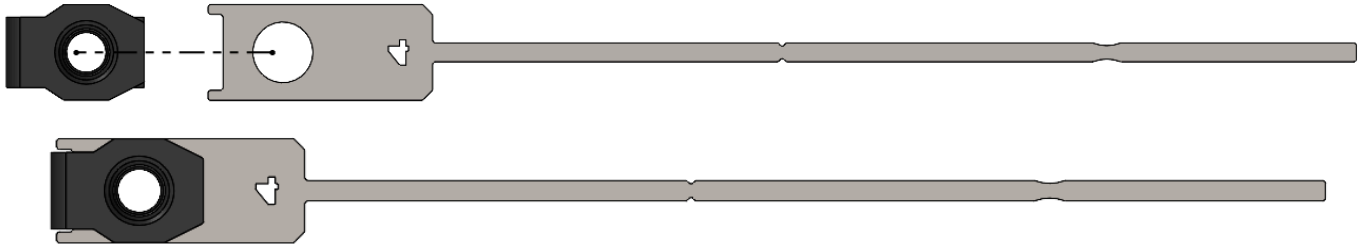

21. Bend the REAR MP4 as depicted below.

- a. Find the dimple nearest to the mounting hole and use a pair of pliers to bend it up at a 90° angle.

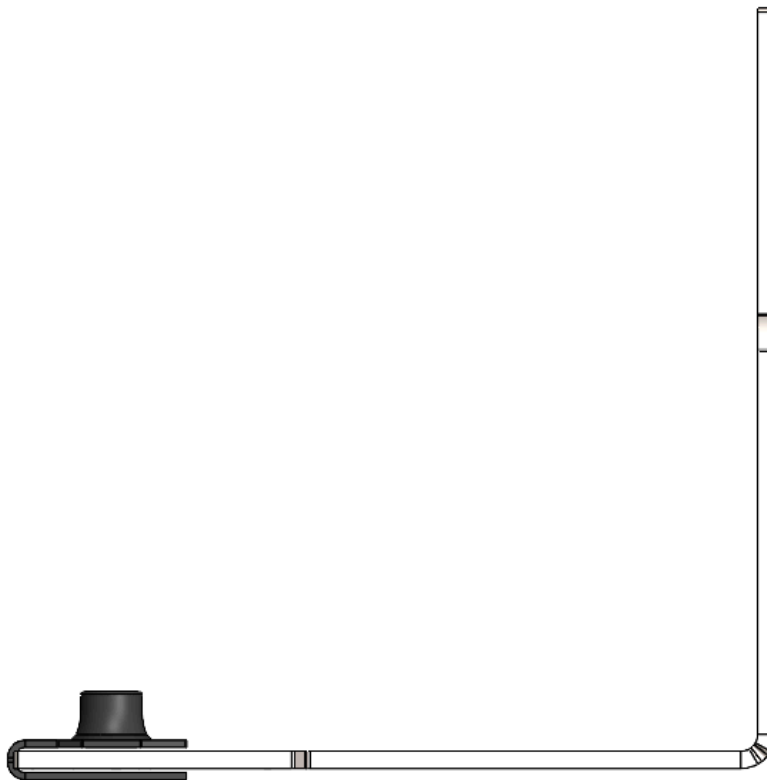

RCI OFFROAD 



- b. At the second dimple in the mounting plate, bend it at a 90° angle to the left of the mounting hole as depicted below.



RCI OFFROAD 



22. Bend the FRONT MP4 as depicted below.

a. Measure and mark a line 4.25" from the back edge as shown:

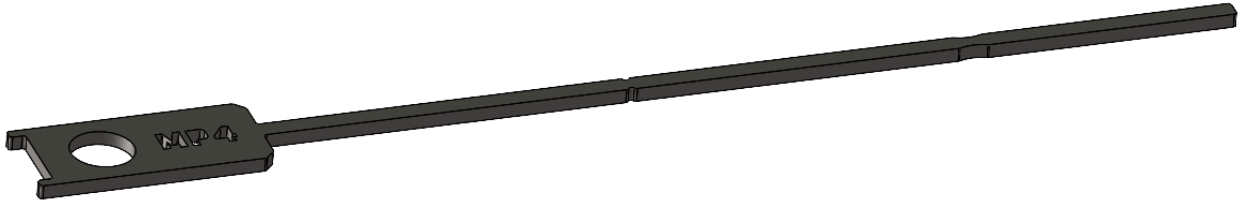

b. Bend the "tail" of the MP4 up as close to the edge of the "body" of the MP4



- c. At the first dimple, bend the tail up and over the body of the MP4

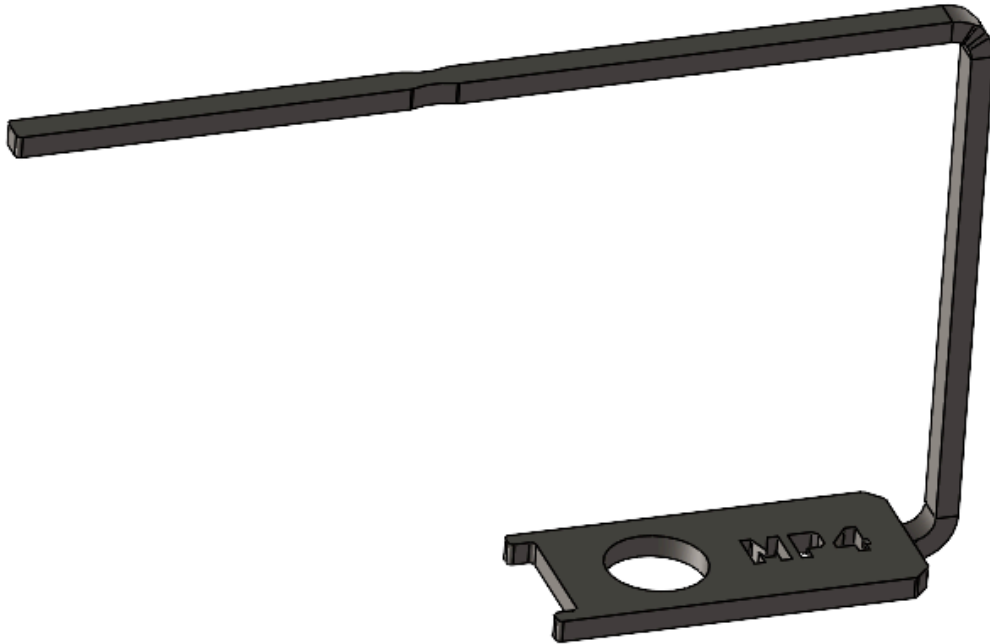

- d. At the line marked earlier, bend the tail out to the left of the MP4





23. Identify the driver side slider and lift it up to the frame on the driver side of the vehicle.
- Use of a floor jack or similar equipment will make this process significantly easier.
 - Take special care to avoid pinching the grounding wire, its mounting clip, the plastic wire harness mount, and/or any other frame-mounted wires and lines.
24. Loosely install the included M10 - 1.25 x 30mm and 3/8" washers in the following locations.
- On 2025 TRD Offroad trim vehicles, these holes may not be tapped and threaded. If your vehicle does not have threaded holes here, please refer to the next step.**

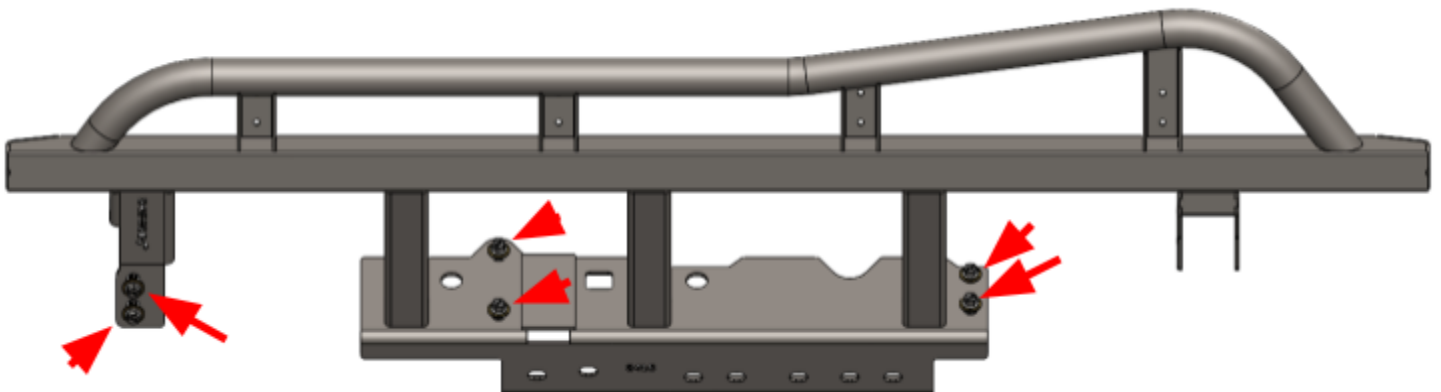

25. On 2025 TRD OFFROAD vehicles, the tapped holes from the previous step may not be threaded. If your vehicle has threaded holes and you were able to complete the previous step successfully, please skip this step and continue to the next step.

- a. Bend an MP4 at the first set of notches from the larger end of the plate and install an M10 speed clip with the flat face on the same side of the MP4 as the bend.

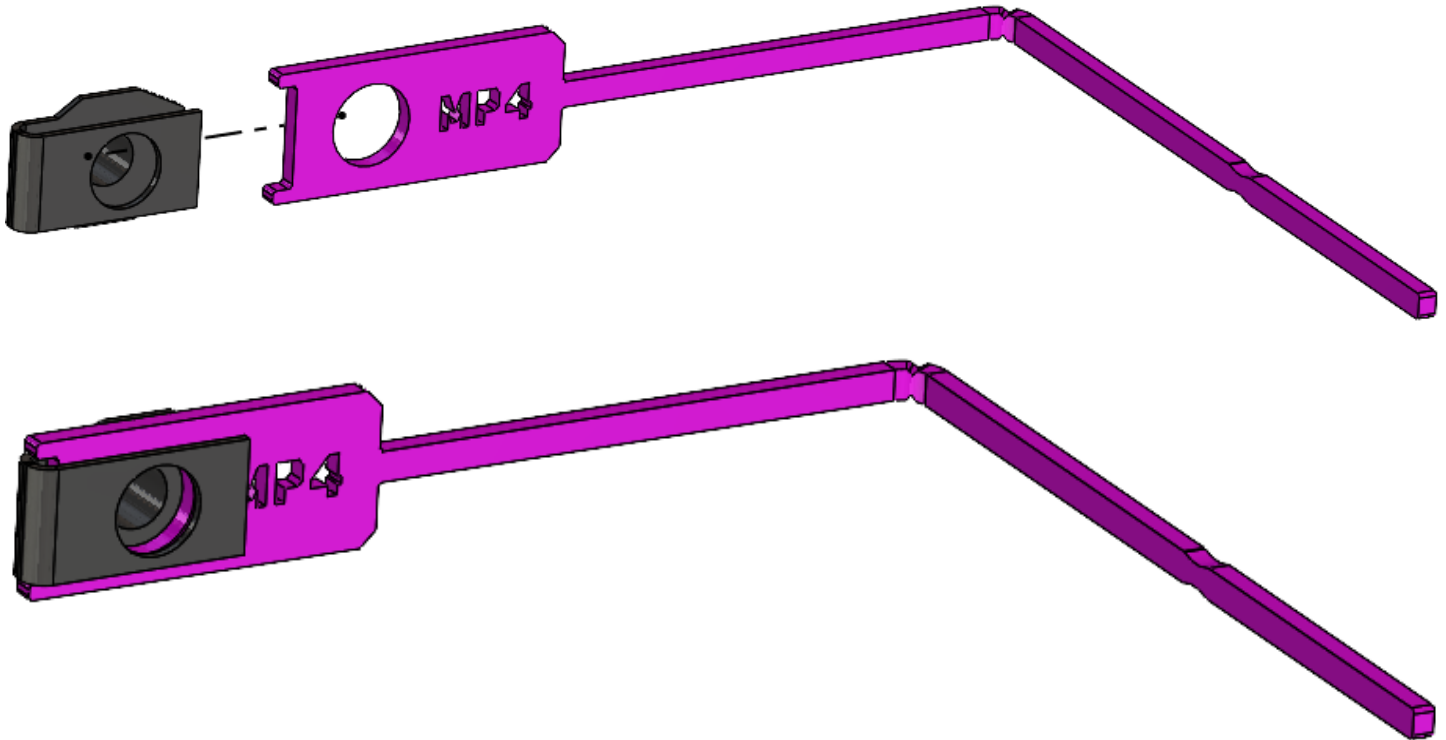

- b. Insert the MP4 assembly through the rectangular hole in the slider frame plate. Align the speed clip with the upper hole at the front of the slider frame plate and loosely thread an M10-1.5 X 35MM into the threaded speed clip.

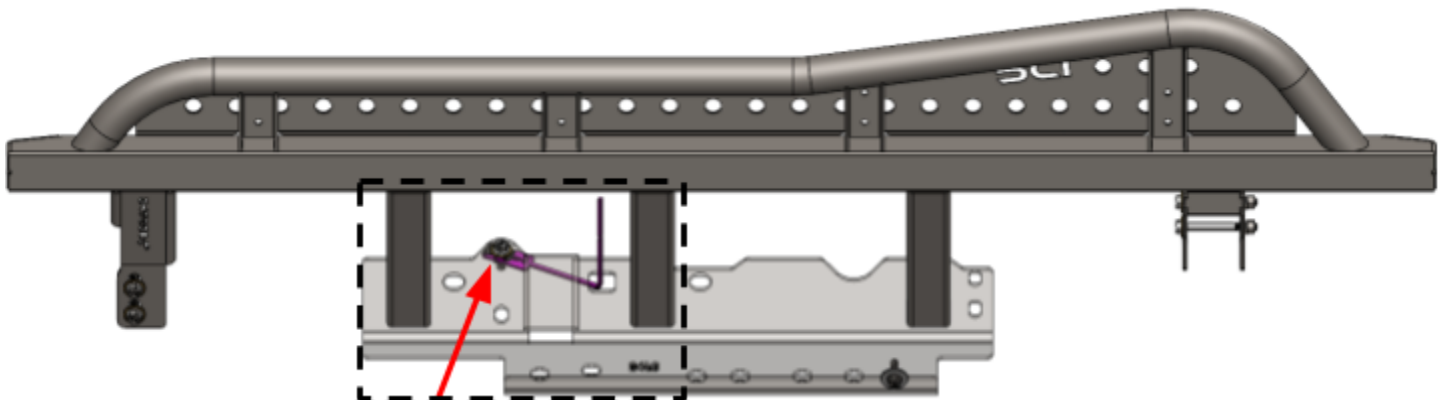

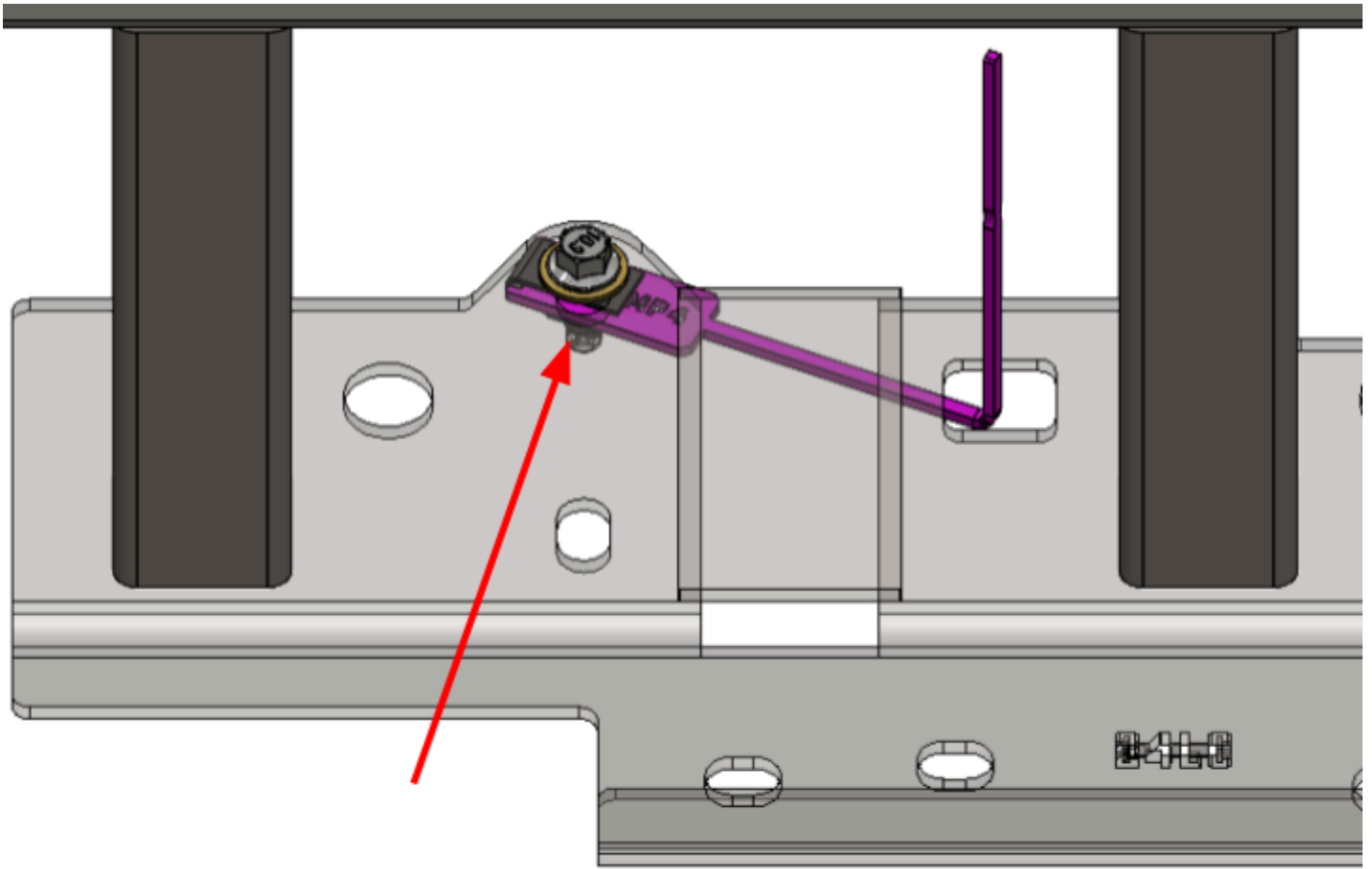

- c. Bend an MP4 past the first set of notches from the larger end of the plate and install an M10 speed clip with the flat face on the same side of the MP4 as the bend.
 - i. Make the bend 4.5" from the end of the "body" of the MP4.

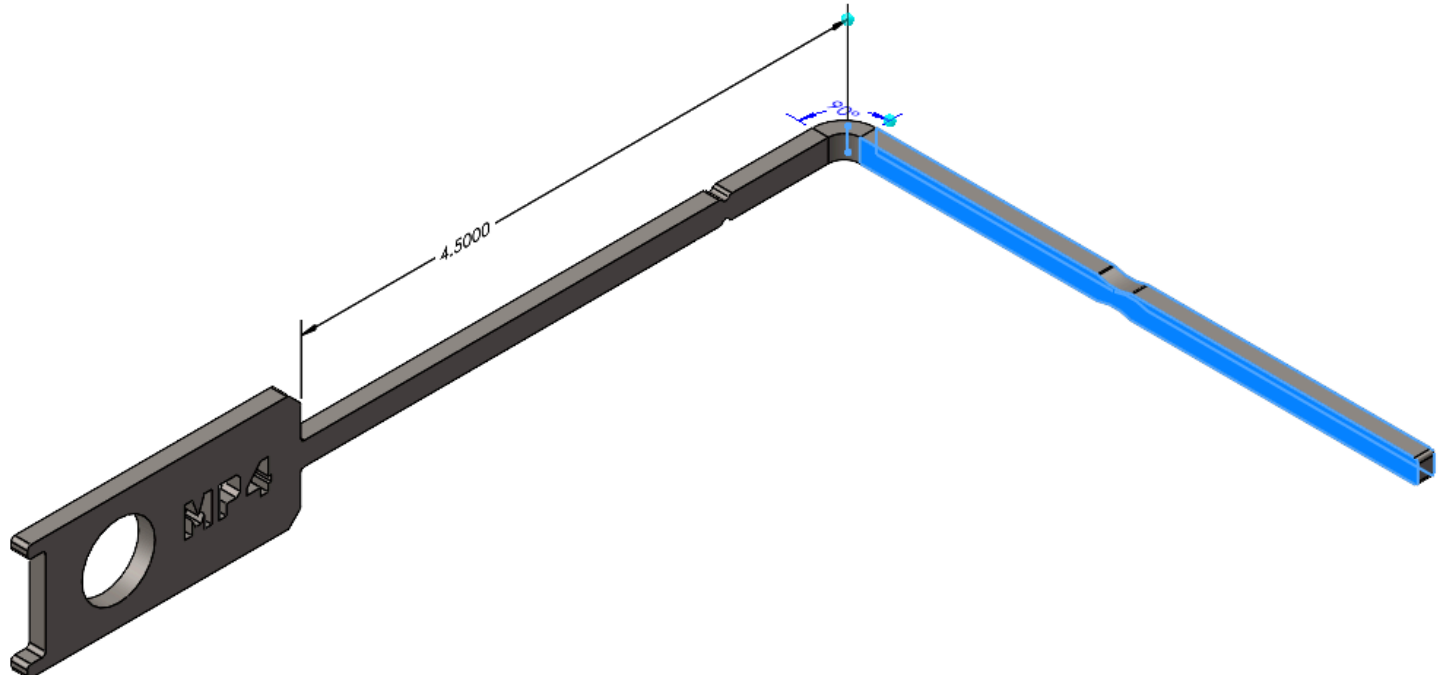

- d. Insert the MP4 assembly through the rectangular hole behind the slider frame plate. Align the speed clip with the upper hole at the rear end of the slider frame plate and loosely thread an M10-1.5 X 35MM into the threaded speed clip.

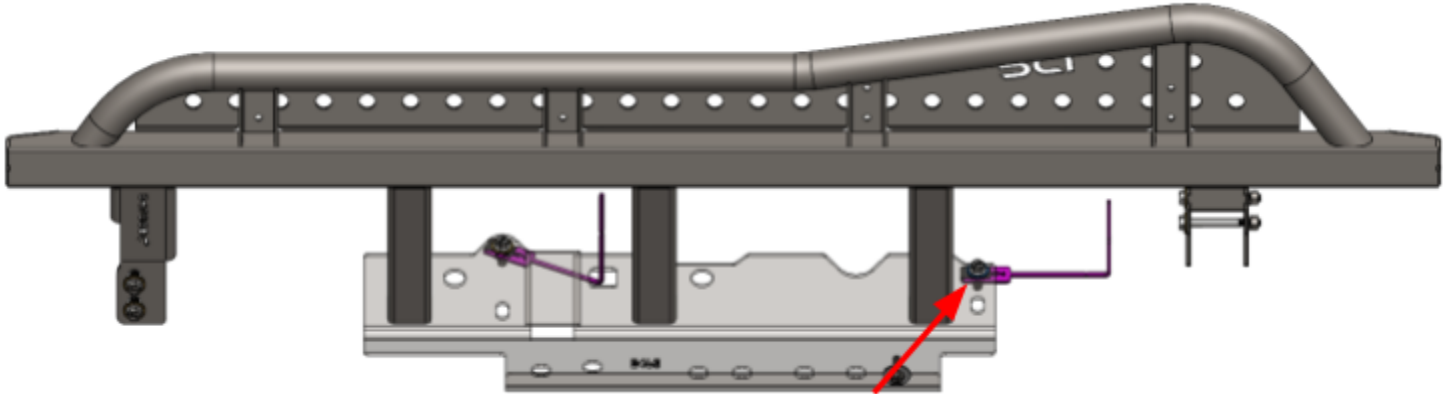

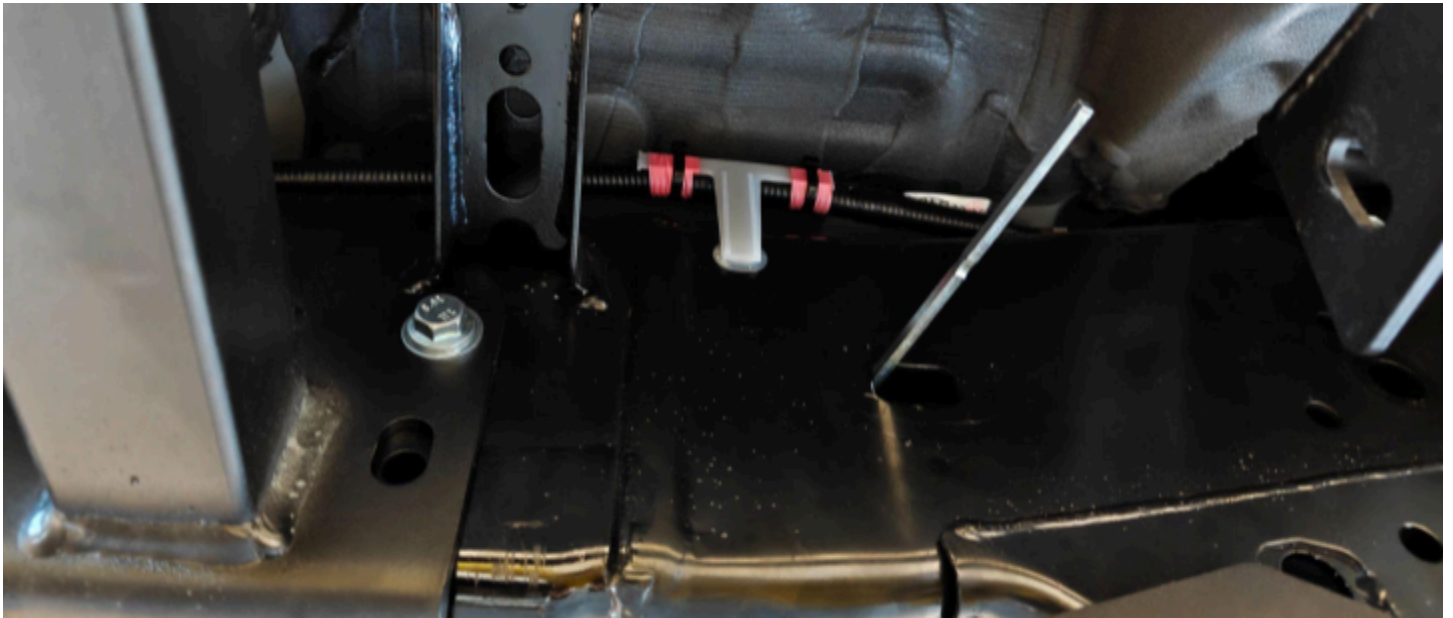

26. Loosely install the included M8 bolt and fender washer in the following location:

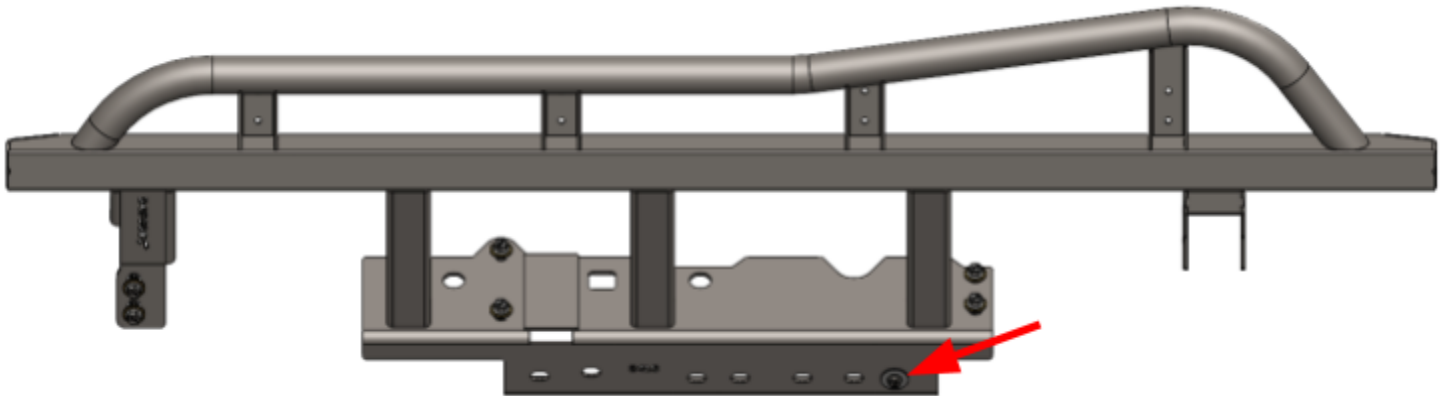

27. Insert the bent front and rear MP4 assemblies from the earlier step into the frame of the vehicle and loosely install the included M10 - 1.5 x 35mm bolts and 3/8" washers in the following locations:

- a. You may optionally choose to trim the remaining “tail” of each MP4 or bend them out of the way after this step. However, this is not a necessary step and the remaining “tail” will not interfere with anything moving forward.

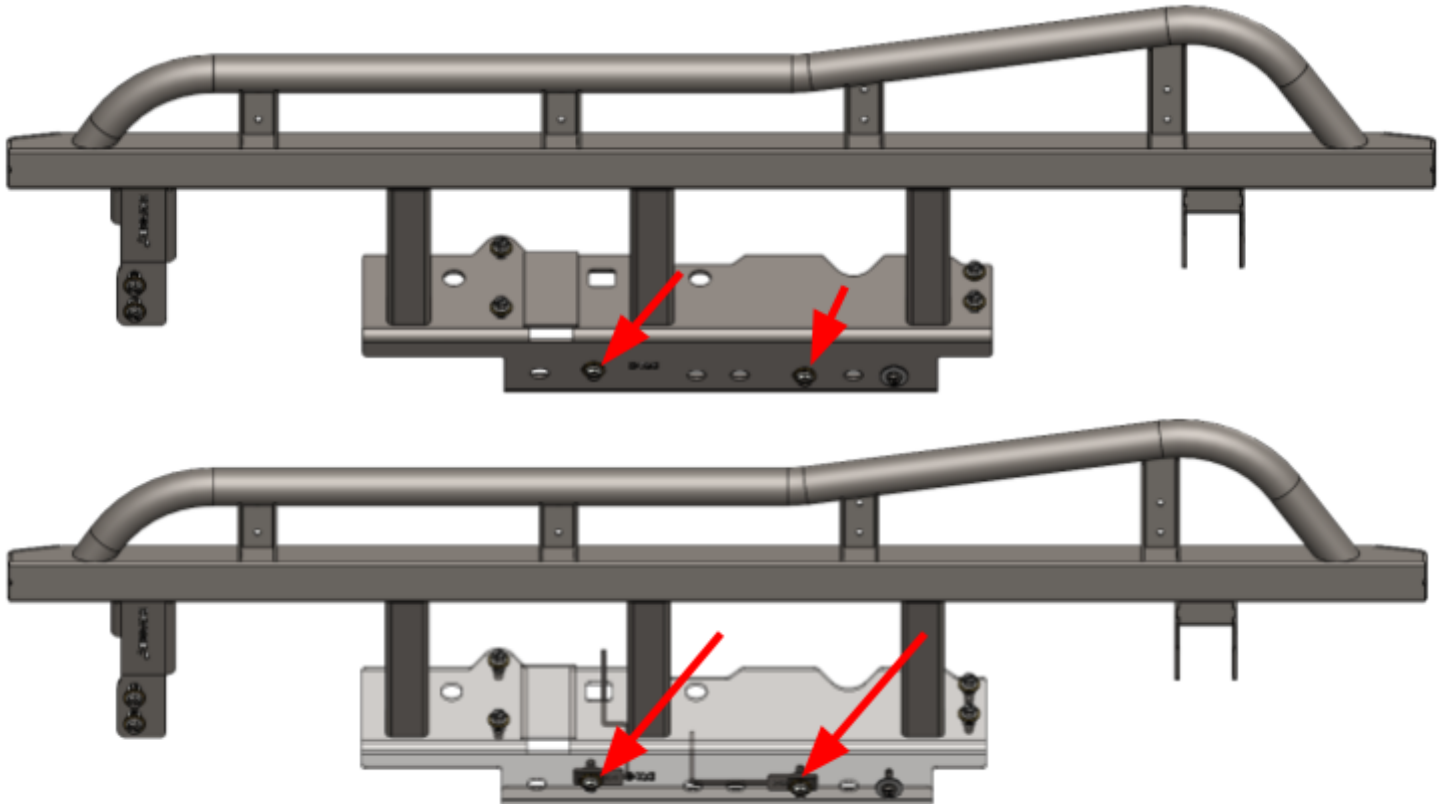

- b. The rear MP4 is installed from the inside of the frame with the M10 speed clip facing the rear of the vehicle. Align the threaded hole of the rear MP4 assembly with the third hole from the rear of the bottom face of the RCI 24+ LC250 Slider Frameplate.

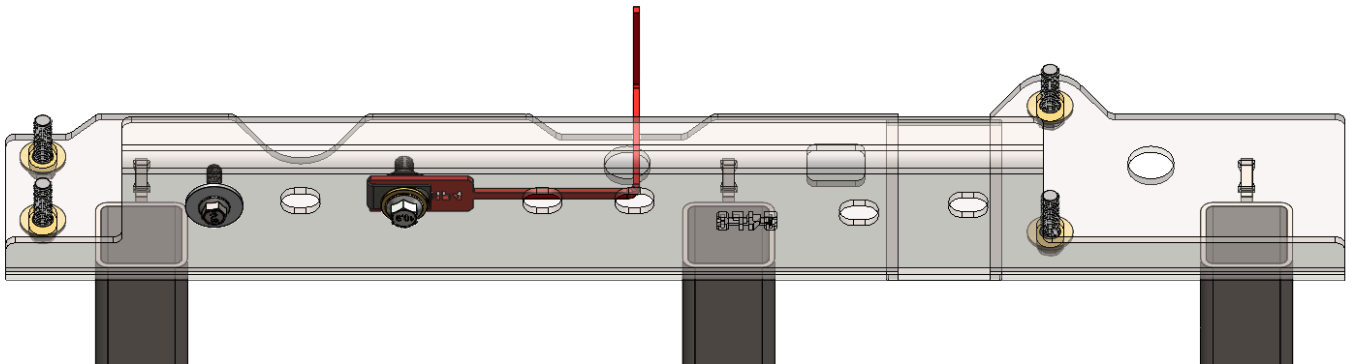

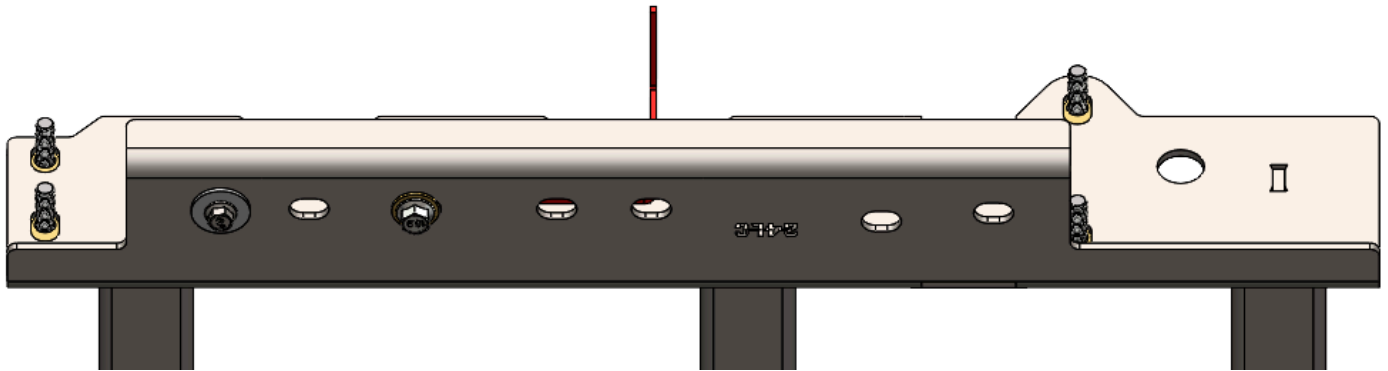

- c. The front MP4 is installed from the outside of the frame with the M10 speed clip facing the front of the vehicle. Align the threaded hole of the front MP4 assembly with the second hole from the front of the bottom face of the RCI 24+ LC250 Slider Frameplate.

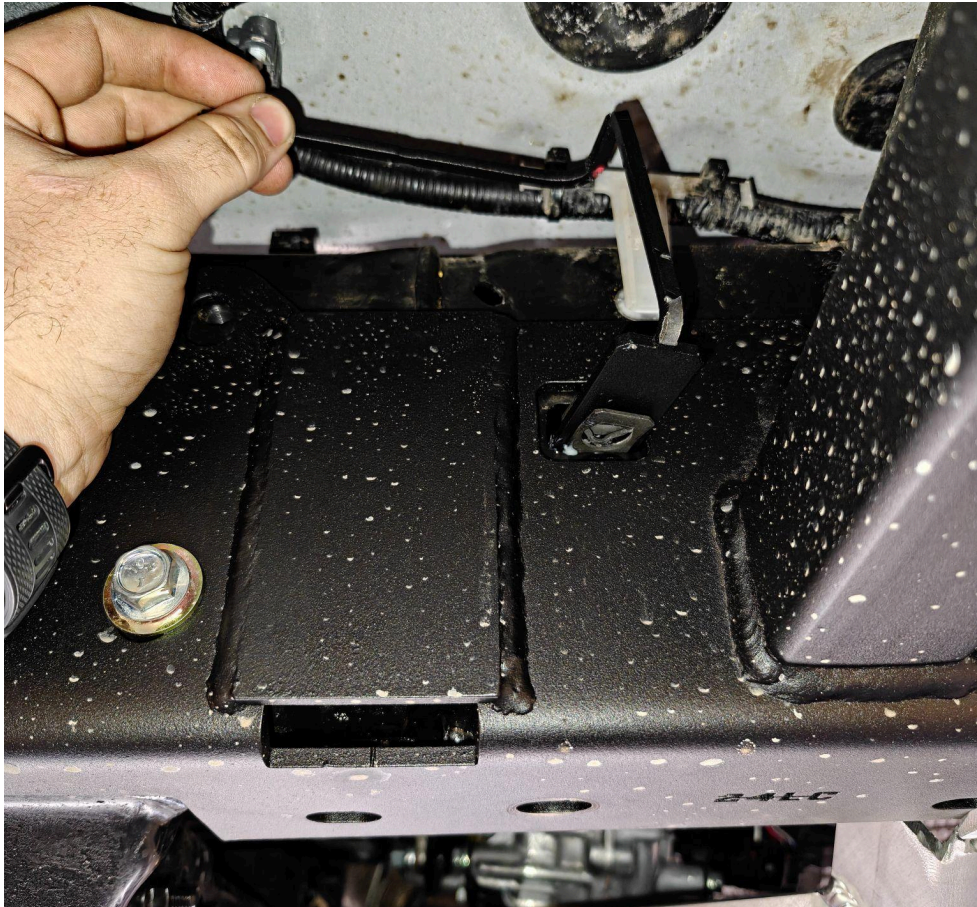

RCI OFFROAD

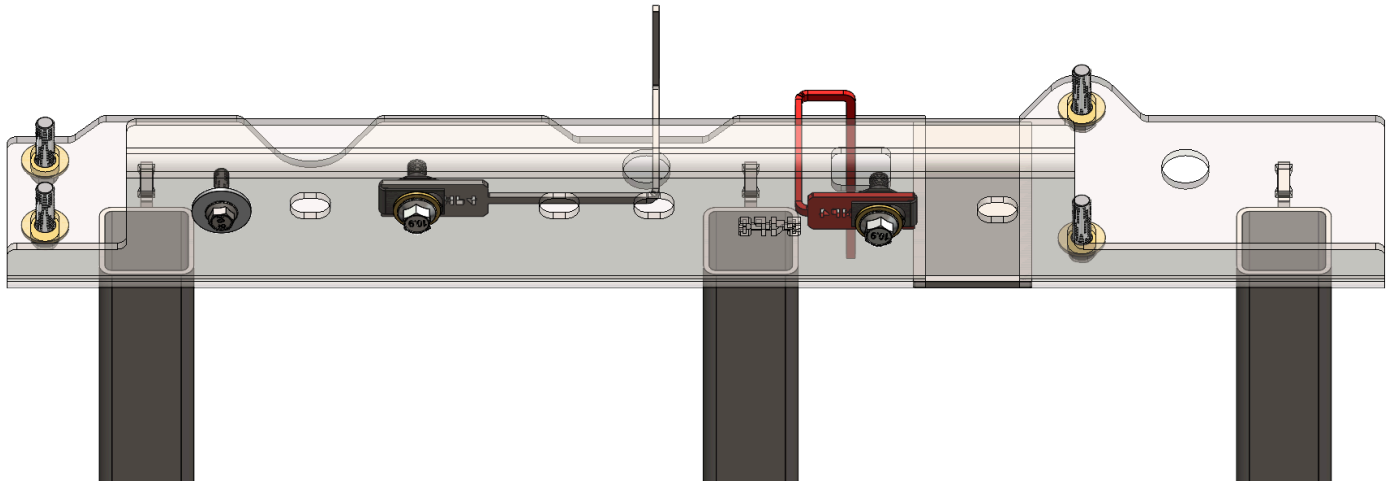

28. Align the rear bolt on-leg with the bolt-on leg mount welded to the main rail of the slider.
Loosely install the pair of included 3/8" x 3.5" hex bolts, washers, split washers, and nuts.

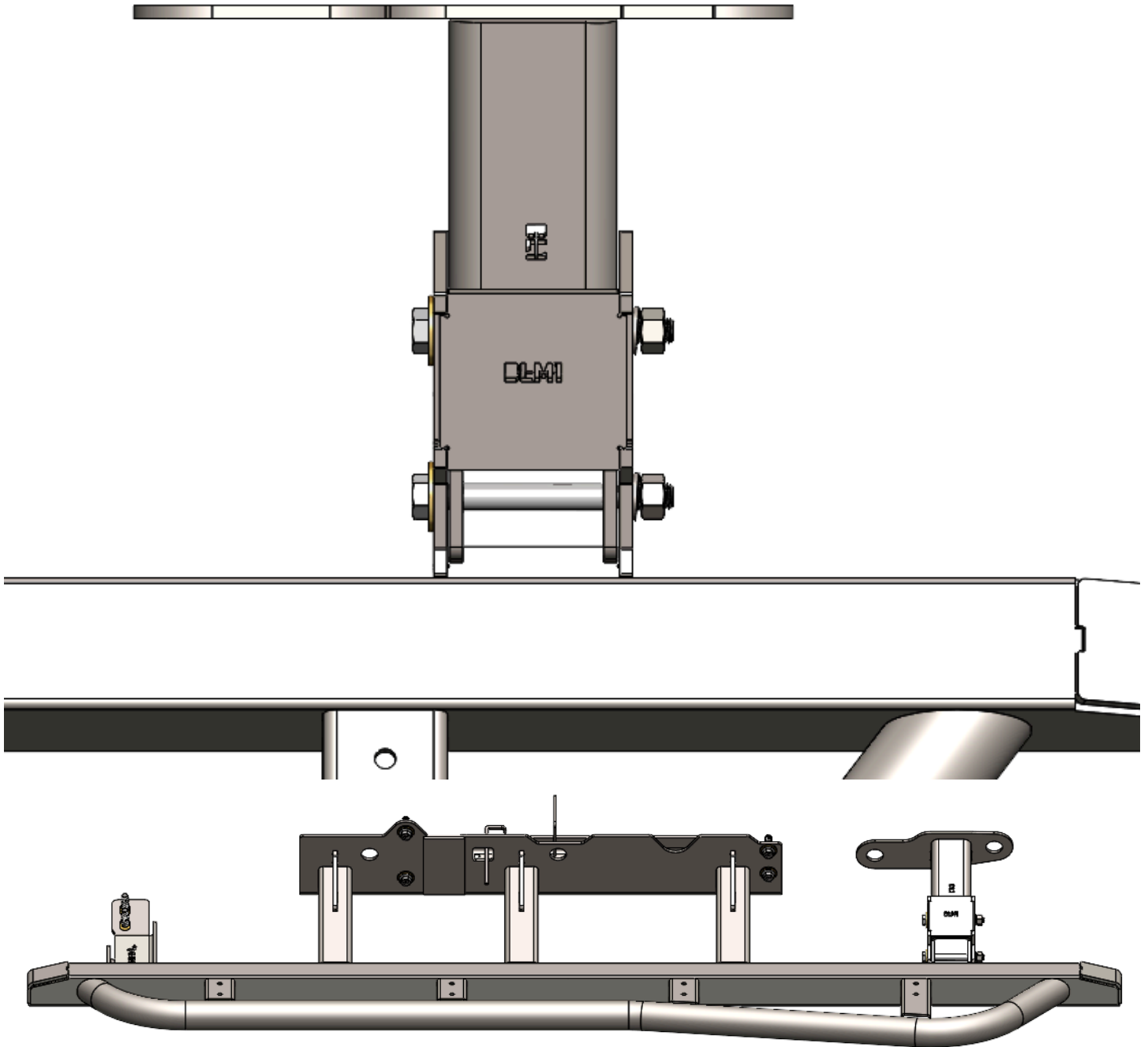

29. From the inside of the frame, carefully feed a pair of 7/16" carriage bolts through the frame and through the rear bolt-on leg frameplate. Once through, loosely secure the carriage bolts with the supplied 7/16" carriage bolt plates, washers, lock washers, and nuts.

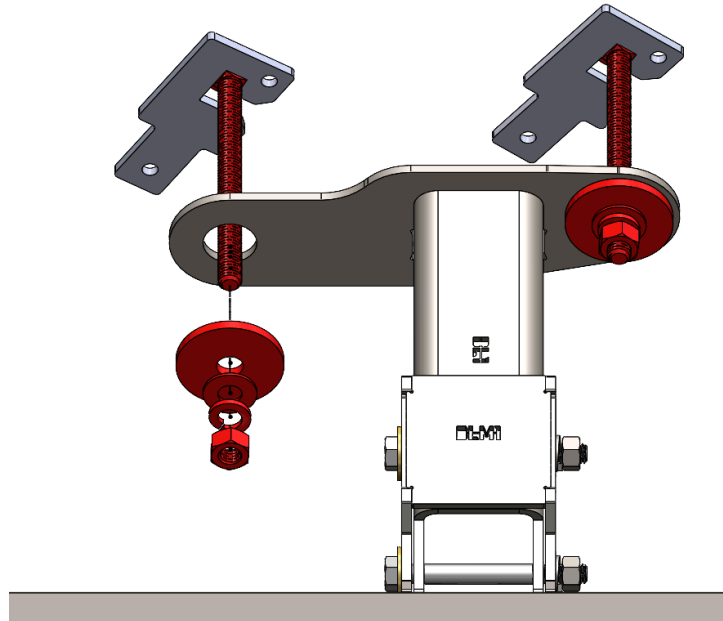
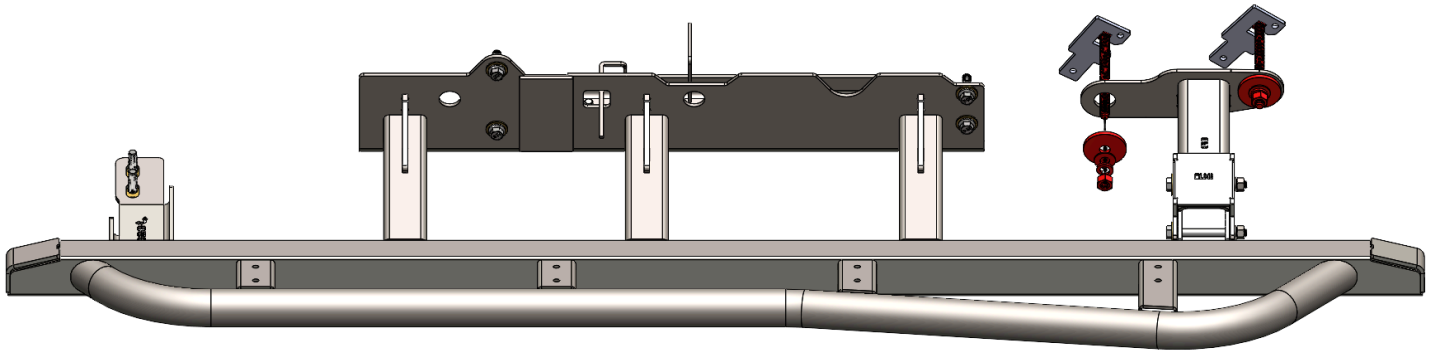

- a. **On 2025 TRD Offroad trim vehicles using MP4s, substitute the included “half moon” washer on the front 7/16" carriage bolt assembly.**

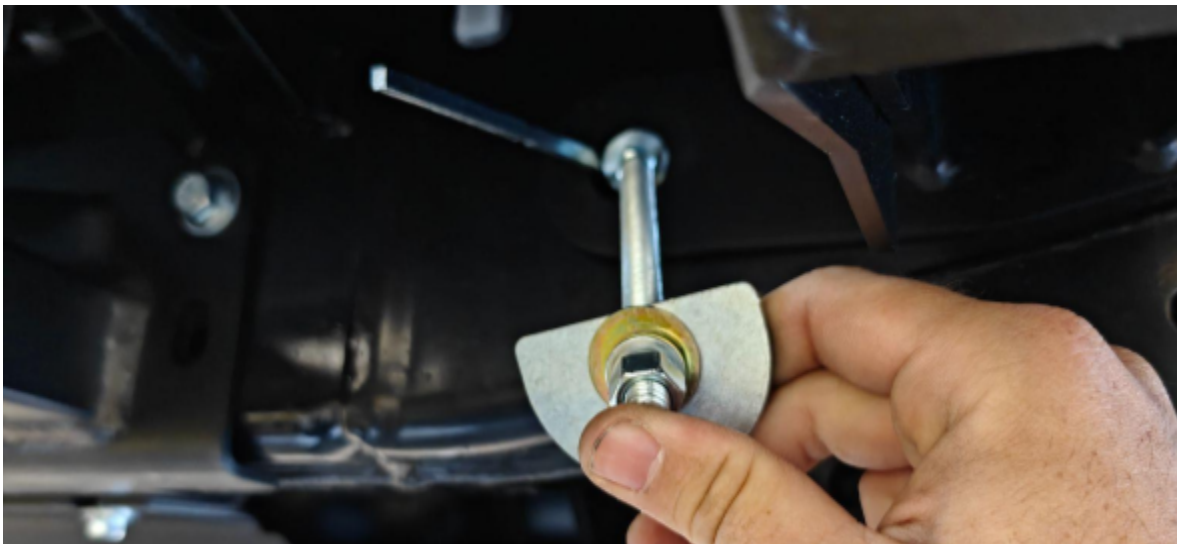

RCI OFFROAD 

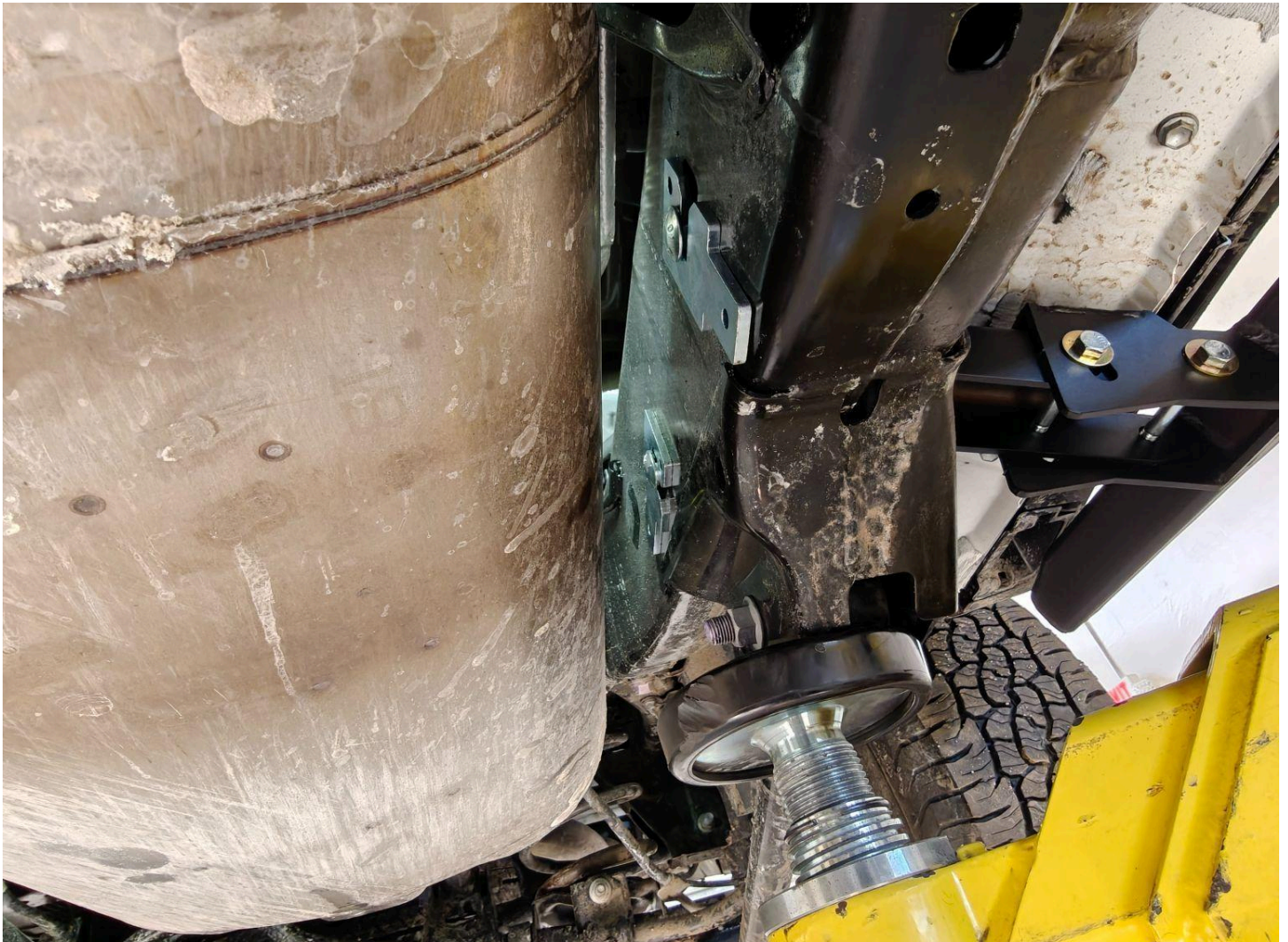
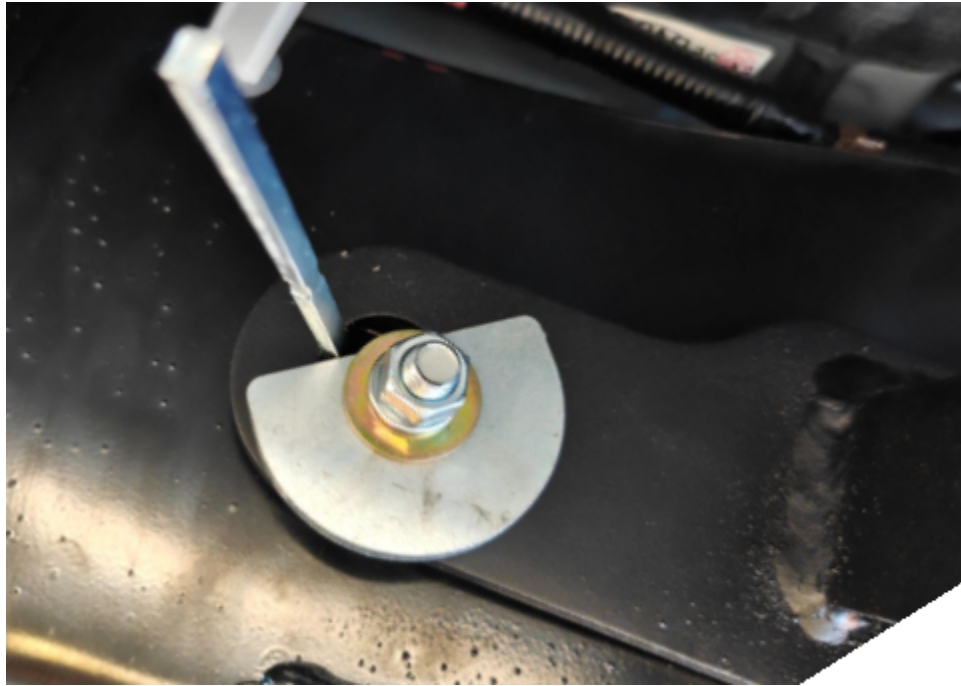

30. With the rear leg frame plate aligned with the frame of the vehicle, tighten the carriage bolts to secure the rear leg.
 - a. Torque the 7/16" carriage bolts to 20 lb-ft.
 - b. Torque the 5/16" carriage bolts to 12 lb-ft.
31. Tighten all of the lower hardware from the front leg and the main frame plate.
 - a. Torque the M10 hardware to 60 lb-ft.
 - b. Torque the M8 hardware to 30 lb-ft.
32. Finally, tighten the remaining M10 hardware to 60 lb-ft.
33. From the inside of the frame, feed another 7/16" carriage bolt through the remaining hole in the center of the frame plate and secure the carriage bolt with a plate, washers, split washer, and nut.
 - a. This hole in the frame is shared with the "tail" of the rear MP4 assembly. Please adjust the placement of the carriage bolt plate so that the MP4 tail does not obstruct the placement of the carriage bolt plate.

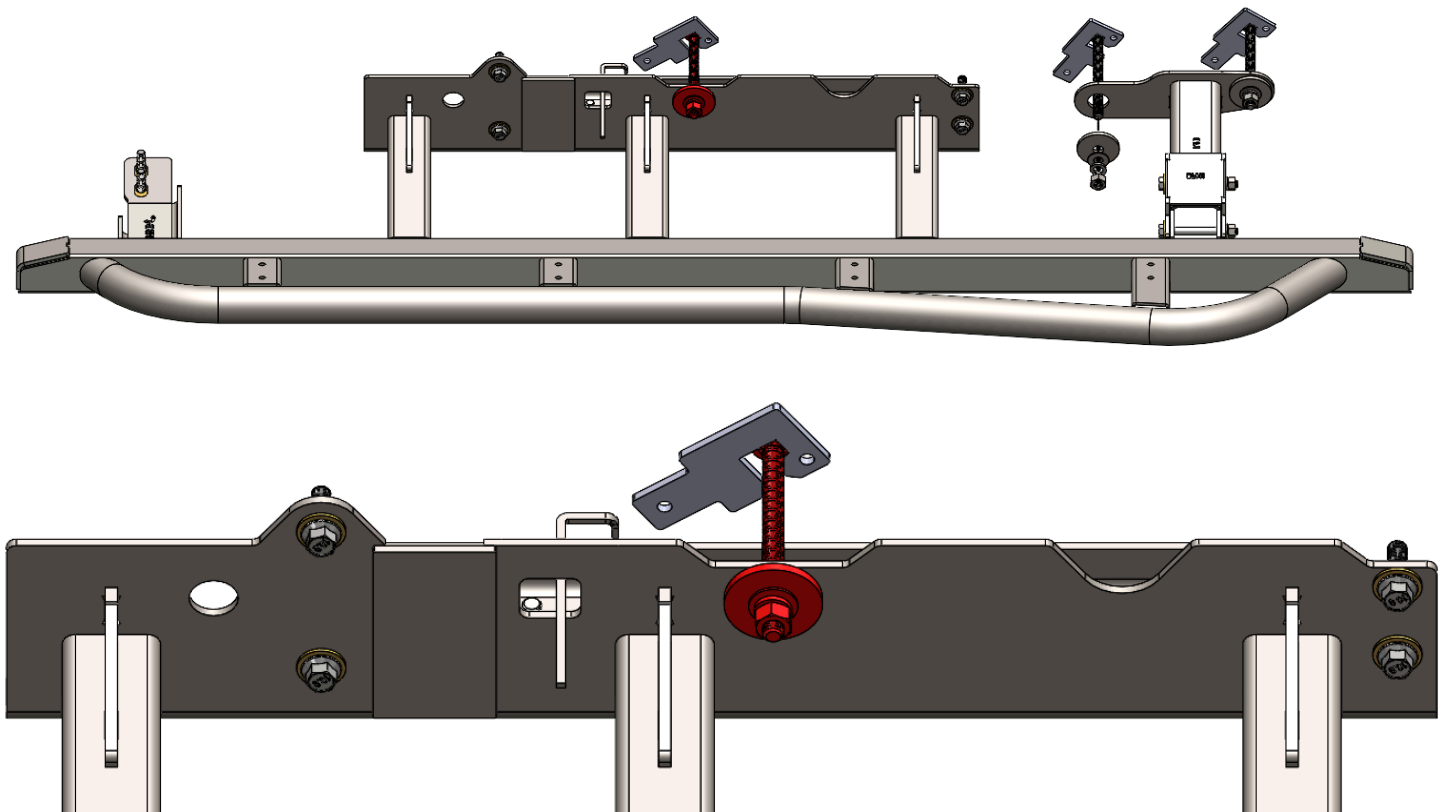



34. From the inside of the vehicle frame, insert a 7/16" carriage bolt through the frame and front of the frame plate. Once through, loosely secure the carriage bolts with the supplied 7/16" carriage bolt plates, washers, lock washers, and nuts.

- a. **Hybrid owners, skip this step. The rear transmission/transfer case crossmember blocks access to this location.**

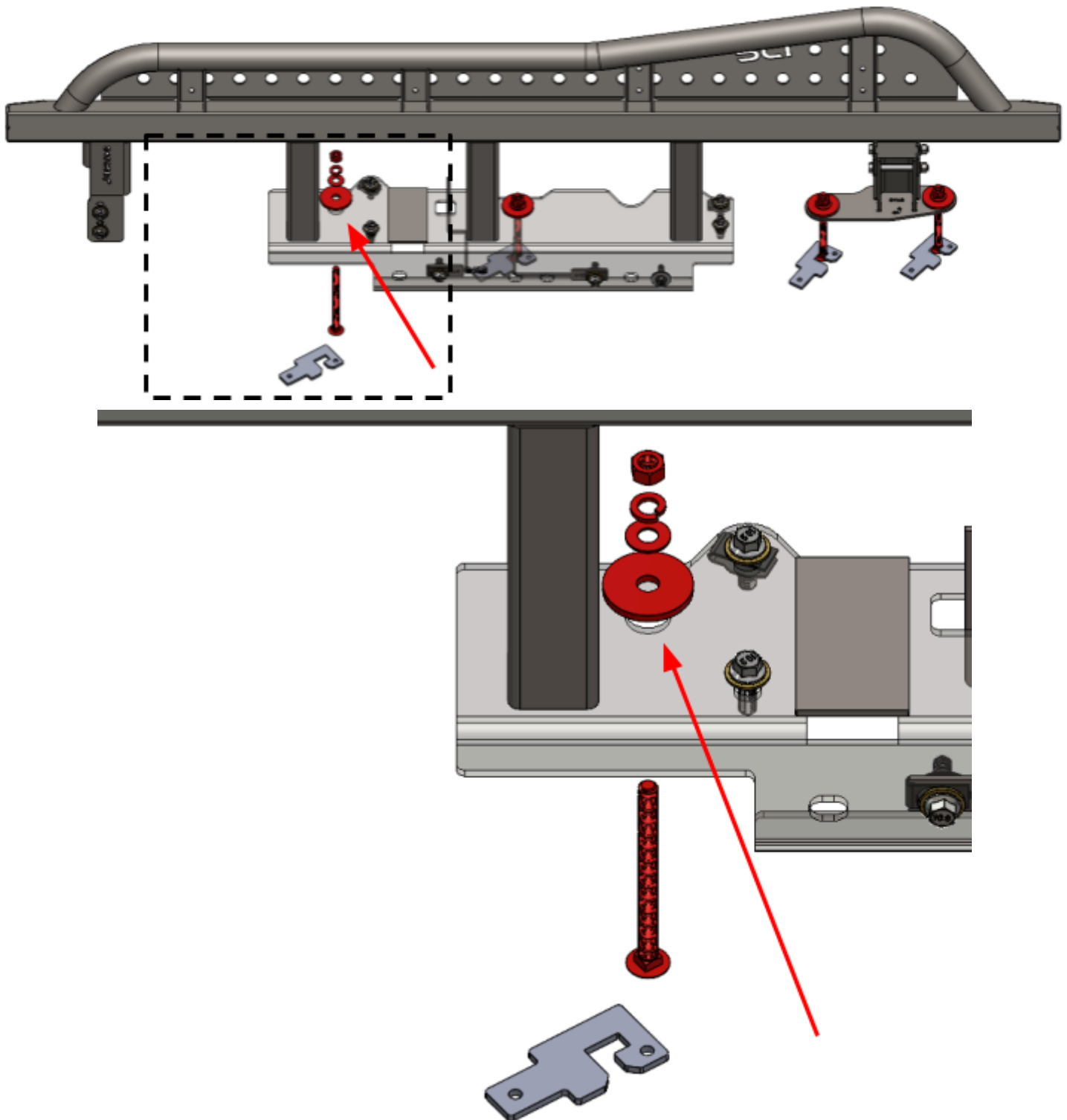



35. Inspect all hardware and ensure they are tightened to the following torque specs:
- a. Torque the 7/16" carriage bolts to 20 lb-ft.
 - b. Torque the M10 hardware to 60 lb-ft.
 - c. Torque the M8 hardware to 30 lb-ft.



Enjoy your new RCI protection!



Share your new install with us on social media!

We love seeing our products out in the wild!

www.rcimetalworks.com

sales@rcioffroad.com

970-797-3089

REV: 1 | 9/29/2022

Disclaimer: The products sold by RCI Metalworks are intended for off-road use only, should not be modified, and are for use only on the vehicle(s) specifically stated. RCI Metalworks makes no warranties express or implied, including of fitness for a particular purpose or merchantability. RCI Metalworks will not be liable for any damages arising out of the use or misuse of its products. It is the customers' responsibility to ensure the products are safely and properly attached to the vehicle, and all products should be installed by trained professionals. We strive to maintain extremely high-quality standards; however, all RCI Metalworks products are individually handcrafted, may vary slightly, and may contain minor imperfections. Due to the nature of raw aluminum, the material may have minor scratches and other blemishes caused by the manufacturing process, especially on the back side of product. RCI Metalworks is constantly seeking to improve its products and reserves the right to make changes to any product.

