

RCI Bronco Fender Delete Install Guide

ITEM NO.	PART NUMBER	DESCRIPTION	QTY.
1	Bronco Front Fender Delete	1 Pair	1
2	Bronco Rear Fender Delete	1 Pair	1
3	M6 1x20 Button Head Screw	Hardware	20
4	M6x1 Keps Nut	Hardware	14
5	1/4" Black Flat Washer	Hardware	20
6	1/4" Fender Washer	Hardware	14

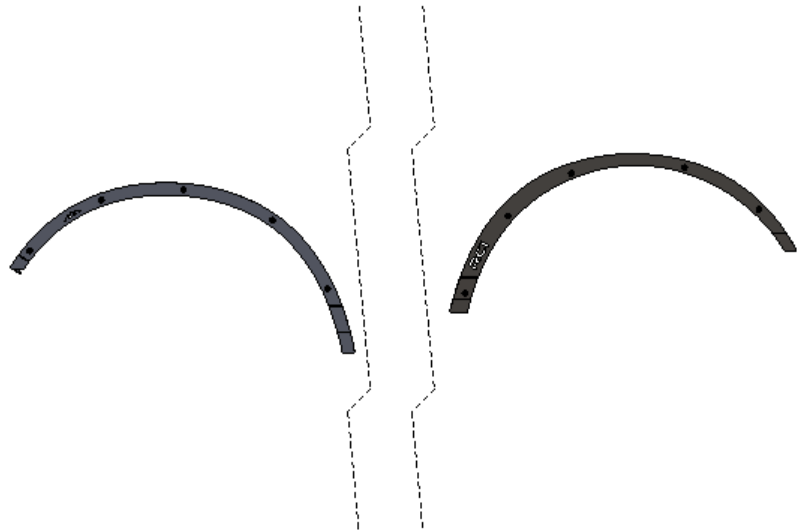

Figure 1: Assembly with hardware

1. Begin by unpacking and removing all components and hardware. Please verify that all hardware, components, and mounting components are present. Please reference your original order invoice and verify all items are accounted for.
2. Remove the vehicle fender flares.
 - a. There are several quarter-turn latches on the underside of each of the fender flares. Turn them to the unlocked position.



Figure 2: Fender flare latches

- b. Remove the fender flares by gripping at the lower corners and carefully but firmly pulling the flares away from the body of the vehicle.

- c. Remove the 6 body-colored bolts on the mounting faces of the rear wheel wells.
 - i. 3 bolts on either side of the vehicle



Figure 3: Threaded mounting locations

- 3. Remove the hex-head bolts and philips head screws securing the fender liner to each wheel well. Releasing the fender liner gives access to the inner face of the fender.

4. Install the rear fender deletes.

- a. Begin threading 3 of the included washers and button head bolts through the rear fender delete and into the 3 threaded holes in the vehicle body.

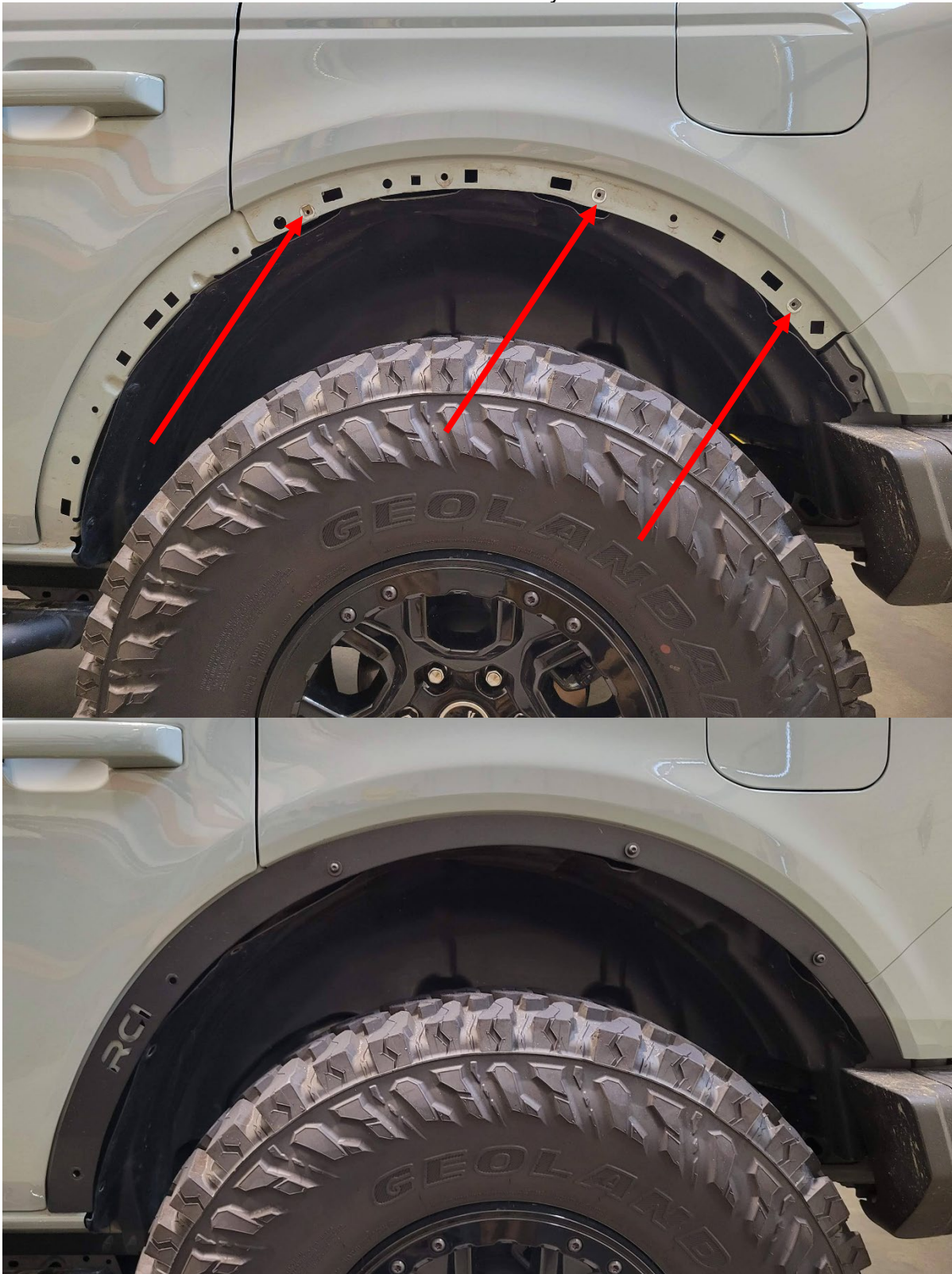

Figure 4 & 5: Threaded mounting locations and initial installation

- b. Install 2 additional sets of button head bolts, washers, fender washers, and nuts through the rear fender delete and vehicle body.

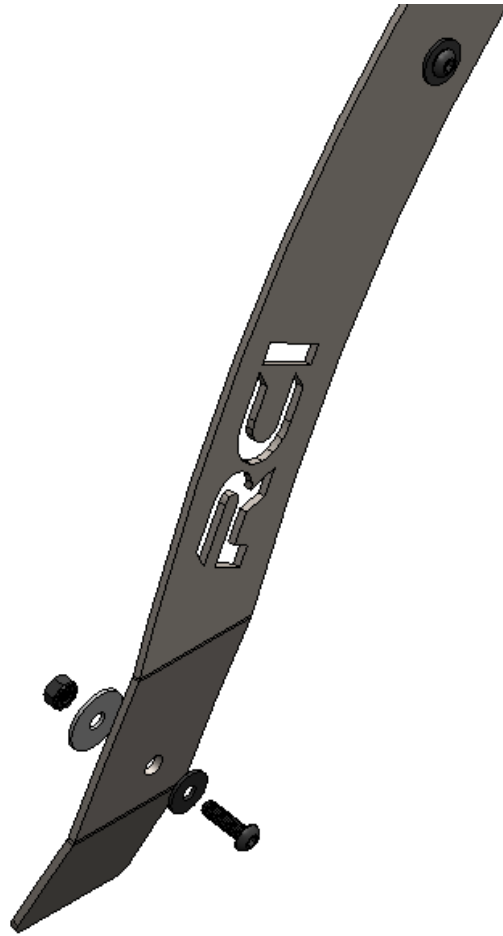

Figure 6 & 7: hardware installation order, orientation, and location

- c. Align the fender delete with the wheel well and tighten all the hardware to secure the fender delete to the vehicle body
 - d. Repeat steps 4a-4c for the other side of the vehicle
5. Install the front fender deletes.
- a. Install 5 sets of button head bolts, washers, fender washers, and nuts through the front fender delete and vehicle body.
 - b. Align the fender delete with the wheel well and tighten all the hardware to secure the fender delete to the vehicle body
 - c. Repeat steps 5a-5c for the other side of the vehicle



Figure 8 & 9: hardware installation order, orientation, and location

Enjoy your new RCI Bronco Fender Delete Kit



Share your new install with us on social media!

We love seeing our products out in the wild!

www.rcimetalworks.com

sales@rcioffroad.com

970-797-3089



Disclaimer: The products sold by RCI Metalworks are intended for off –road use only, should not be modified, and are for use only on the vehicle(s) specifically stated. RCI Metalworks makes no warranties express or implied, including of fitness for a particular purpose or merchantability. RCI Metalworks will not be liable for any damages arising out of the use or misuse of its products. It is the customers' responsibility to ensure the products are safely and properly attached to the vehicle, and all products should be installed by trained professionals. We strive to maintain extremely high quality standards; however, all RCI Metalworks products are individually handcrafted, may vary slightly, and may contain minor imperfections. Due to the nature of raw aluminum, the material may have minor scratches and other blemishes caused by the manufacturing process, especially on the back side of product. RCI Metalworks is constantly seeking to improve its products and reserves the right to make changes to any product.