

# RCI 2 DOOR FORD BRONCO FUEL TANK SKID PLATE INSTALLATION GUIDE

**\*\*This install guide is applicable to our 2 Door Ford Bronco Fuel Tank Skid Plate ONLY\*\***

ITEM NO.	PART NUMBER	DESCRIPTION	QTY.
1	2 Door Fuel Tank - Rear		1
2	2 Door Fuel Tank - Front		1
3	2 Door Fuel Tank - Rear Driver Mount		1
4	2 Door Fuel Tank - Rear Passenger Mount		1
5	Bronco Fuel Tank Skid Plate Hardware Kit	HiTec Hardware Kit	1

## INSTALLATION STEPS:

- 1) Begin by unpacking and removing all components and hardware. Please verify that all hardware, components, and mounting components are present. Please reference your original order invoice and verify all items are accounted for.
  - a. Please note that our Bronco Fuel Tank skid plate mounts further from the vehicle and “below” our Bronco Rock Sliders. If installing both, please install the Rock Sliders before installing the Fuel Tank skid plate.
  - b. RCI’s Bronco Fuel Tank Skid Plate is designed to secure the fuel tank without the need for additional securing devices. Using a set of ratchet straps, secure the fuel tank to the vehicle before removing either the factory fuel straps or factory fuel tank skid plate. The ratchet straps will be removed following the installation of the RCI skid plate.
  
- 1) Loosely mount the Rear Passenger, Rear Driver Mounting Brackets using two (2) of each of the 3/8” Carriage Bolts, Washer, Split Washer, and Hex Nut. The mounts should still be able to rotate and shift slightly to allow for easier alignment with the factory mounting locations.

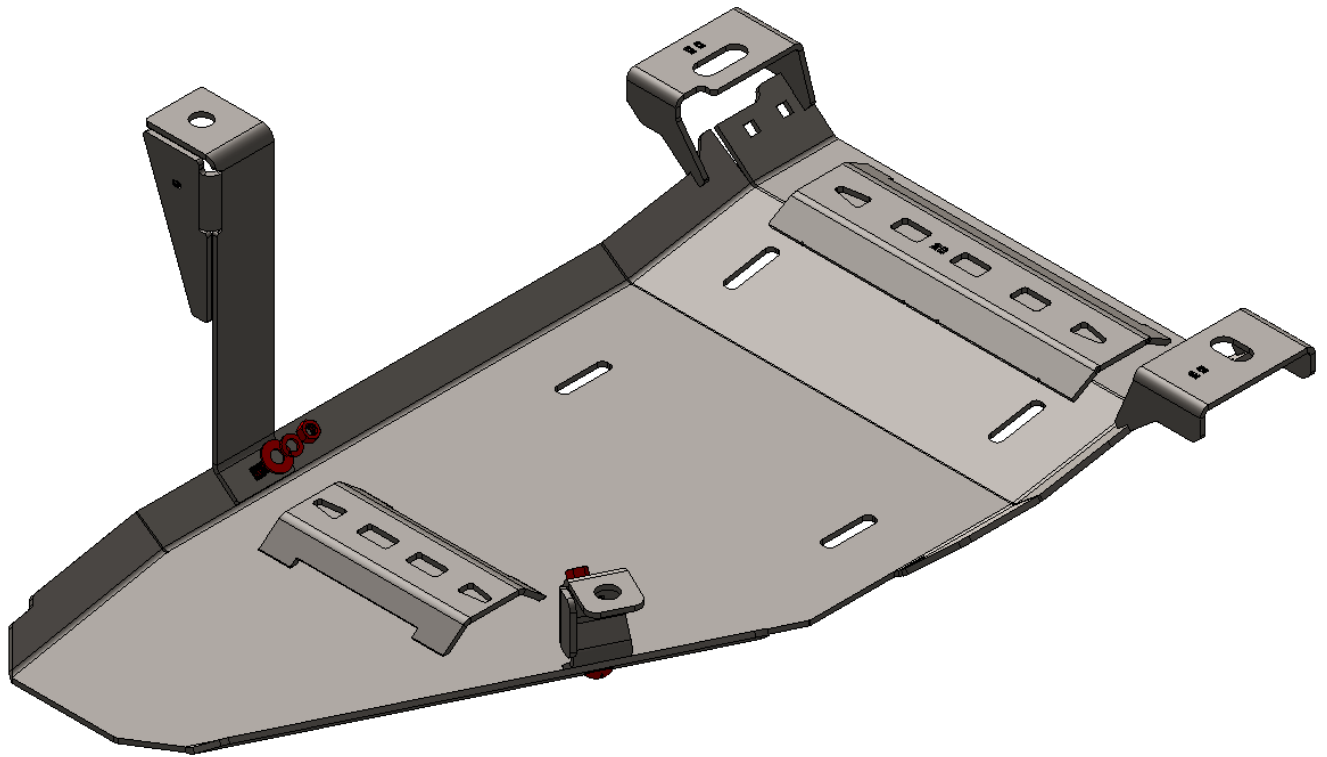

- 2) Secure the two halves of the skid plate together with the use of four(4) sets of 3/8" Carriage Bolts, Washers, Split Washers, and Hex Nuts.

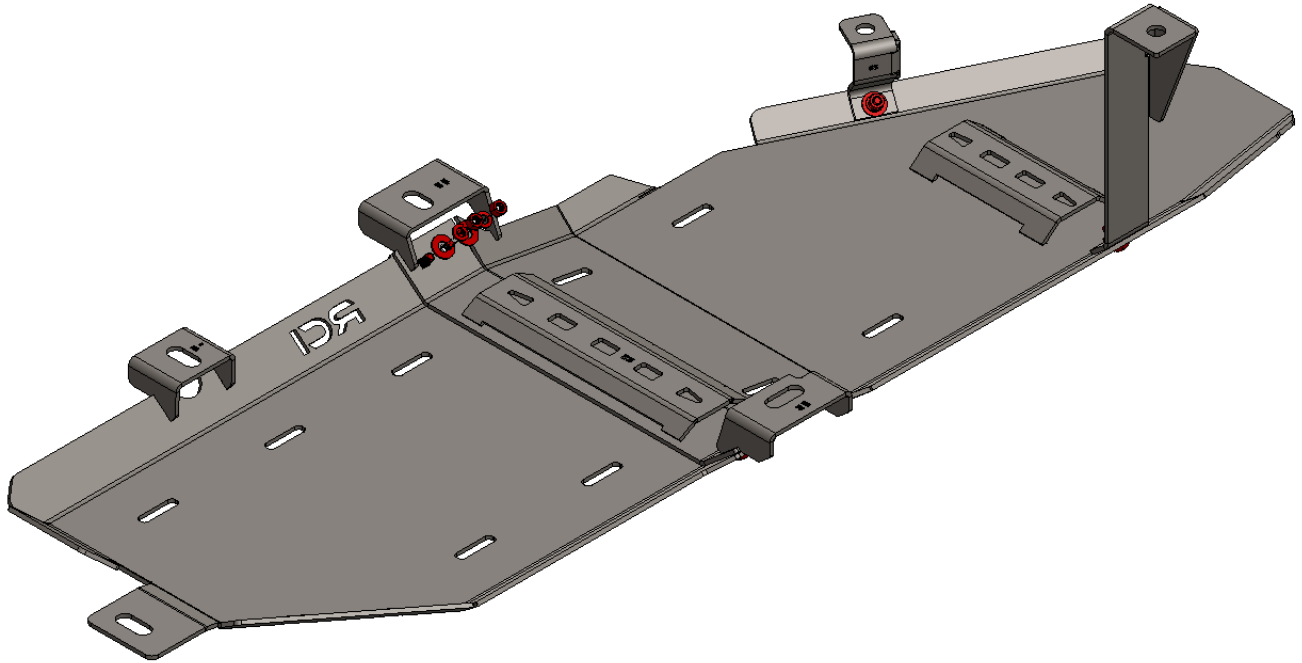

- 3) Lift the Fuel Tank Skid up and into position against the fuel tank. Loosely secure the rear of the Fuel Tank Skid assembly using two (2) of the included 1/2" Washers M12x40mm flanged bolts threaded through the rear passenger and driver mounting brackets and into the Bronco's factory mounting locations. Secure the front of the skid plate using an additional 1/2" washer and M12x40 bolt.
- Using a floor jack, jack stands, or similar to hold the front end of the Rear Fuel Tank Skid will make this step significantly easier.

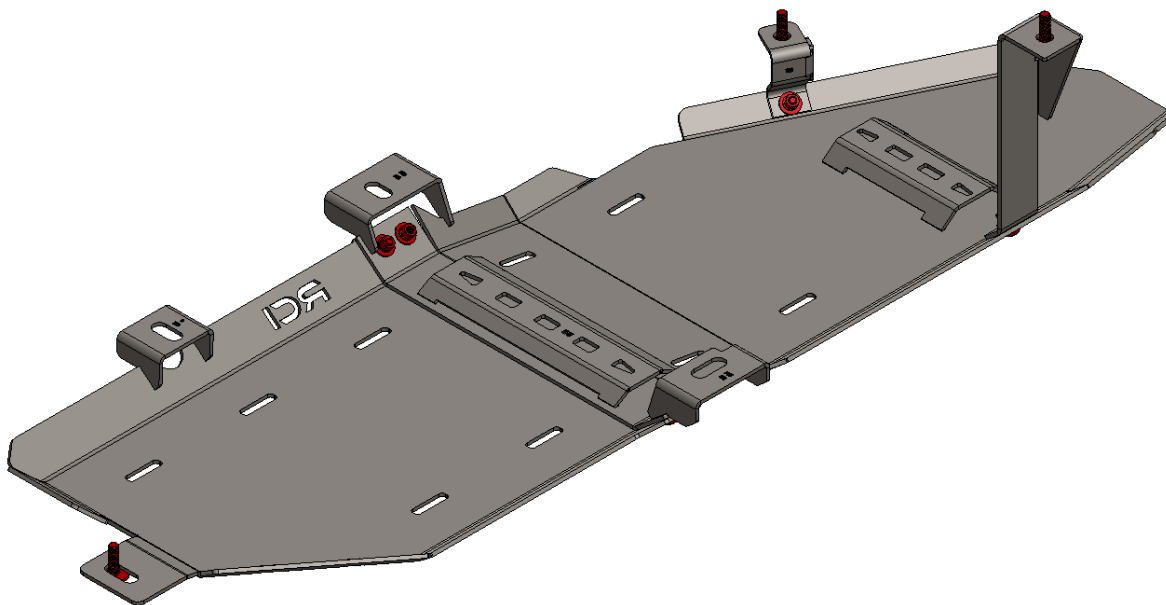

- 4) Install the remaining three(3) m12 bolts and 1/2" washers to secure the center of the fuel tank skid plate.

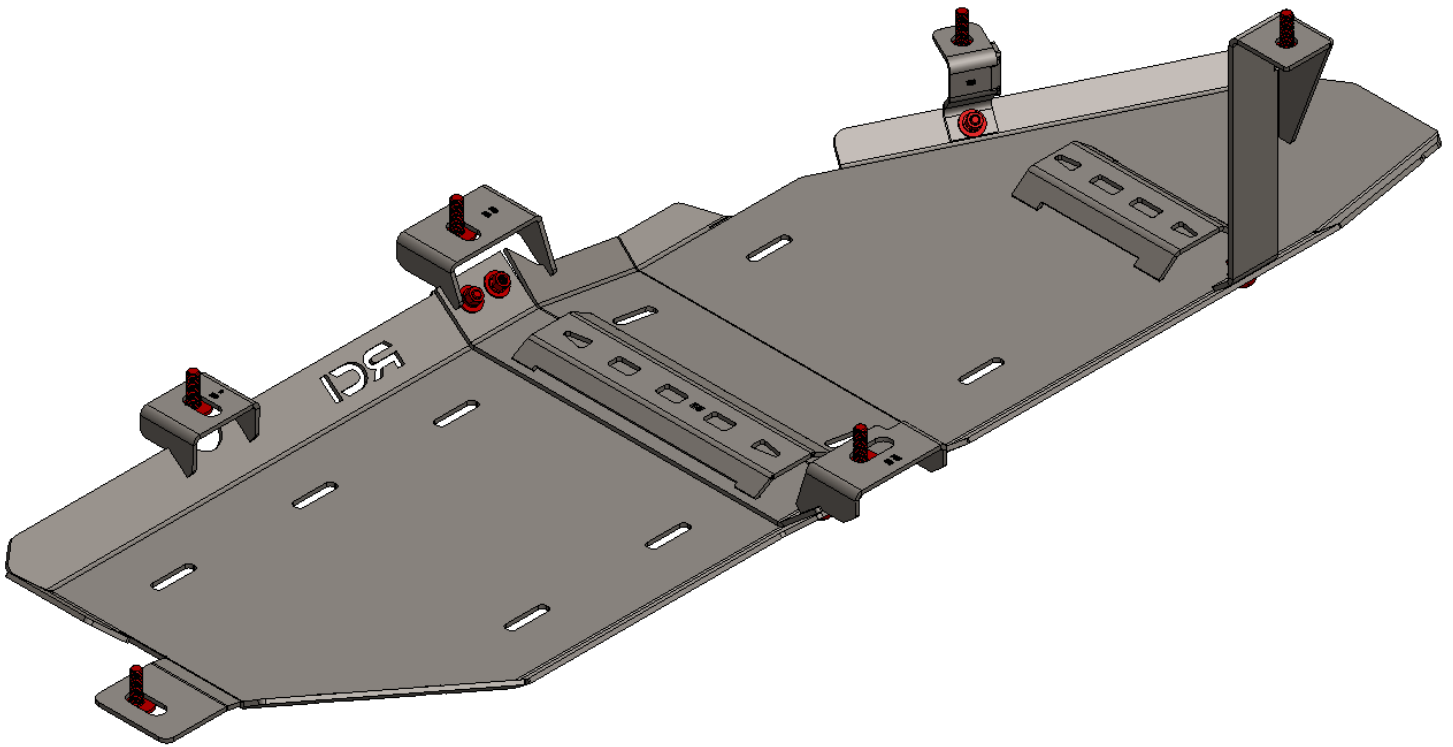

- 5) Ensure that the skid plate is pushed as far towards the passenger side as the slots will allow.
- 6) Tighten all 3/8" hardware, securing the Rear Passenger and Driver Mounting Brackets to the Rear Fuel Tank Skid Plate.
- 7) Remove ratchet straps installed in step 1b.
- 8) Congratulations! Installation of your new RCI Ford Bronco Fuel Skid Plate is now complete!



**Share your new install with us on social media!  
We love seeing our products out in the wild!**

**[www.rcimetalworks.com](http://www.rcimetalworks.com)**

**[sales@rcioffroad.com](mailto:sales@rcioffroad.com)**

**970-797-3089**

REV: 1 | 9/29/2022

Created: K



Disclaimer: The products sold by RCI Metalworks are intended for off-road use only, should not be modified, and are for use only on the vehicle(s) specifically stated. RCI Metalworks makes no warranties express or implied, including of fitness for a particular purpose or merchantability. RCI Metalworks will not be liable for any damages arising out of the use or misuse of its products. It is the customers' responsibility to ensure the products are safely and properly attached to the vehicle, and all products should be installed by trained professionals. We strive to maintain extremely high quality standards; however, all RCI Metalworks products are individually handcrafted, may vary slightly, and may contain minor imperfections. Due to the nature of raw aluminum, the material may have minor scratches and other blemishes caused by the manufacturing process, especially on the back side of product. RCI Metalworks is constantly seeking to improve its products and reserves the right to make changes to any product.